

## Drayton Gardens, SW10

£625,000

A spacious one-bedroom apartment situated in the sought-after Drayton Gardens. Perfect for first-time buyers, this well-presented property offers a generous living area, providing ample space for both relaxing and entertaining. The apartment also benefits from its own private garden area, ideal for outdoor dining, gardening, or simply enjoying some fresh air. Conveniently located close to local amenities and excellent transport links, this charming home presents an excellent opportunity to step onto the property ladder.

Drayton Gardens is a highly desirable location at the heart of Chelsea and South Kensington. Both South Kensington and Gloucester Road underground stations are within walking distance allowing for easy and convenient access across London.

### Features

- No Ongoing Chain
- Private Outdoor Space
- Highly Sought After Location
- Abundance Of Storage
- Ideal First Time Buy
- Walking Distance Of Amenities

# Drayton Gardens, London, SW10

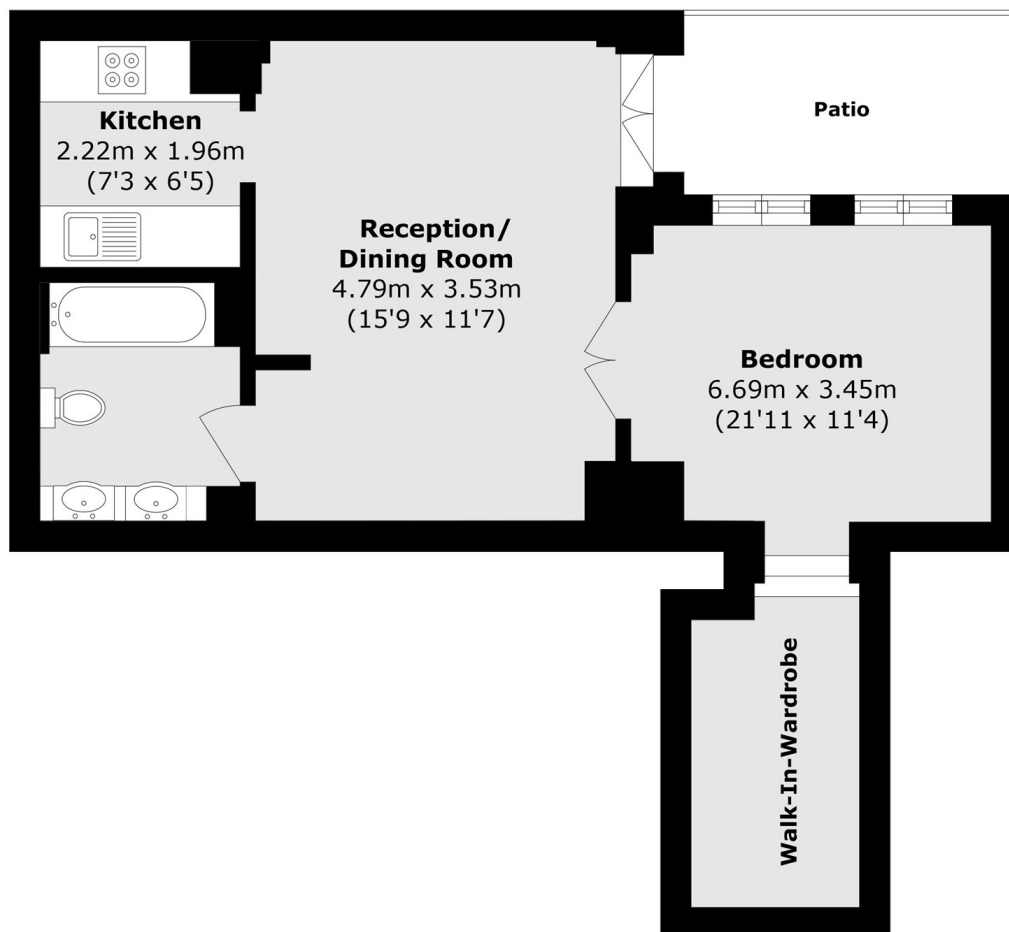

## Lower Ground Floor

Total area (approx.): 41.8 sq. m (449.9 sq. ft)

Patio Total (approx.): 7.6 sq. m (81.8 sq. ft)