



Temple Road, TW3

£500,000

A semi-detached, three bedroom family home located in the heart of the high street, on a quiet road. Offering over 1,100 sq ft of living space, further benefits include large private rear garden, period features and no onward chain.

Ideally situated close to Hounslow East station (Piccadilly line) and moments from Hounslow High Street hosting an array of shops and restaurants. There is also easy access to neighbouring areas of Isleworth, Whitton and Twickenham.

Features

- Semi-Detached
- Three Bedrooms
- No Onward Chain
- Period Features
- Secluded Garden
- Central Location

Temple Road, Hounslow, TW3

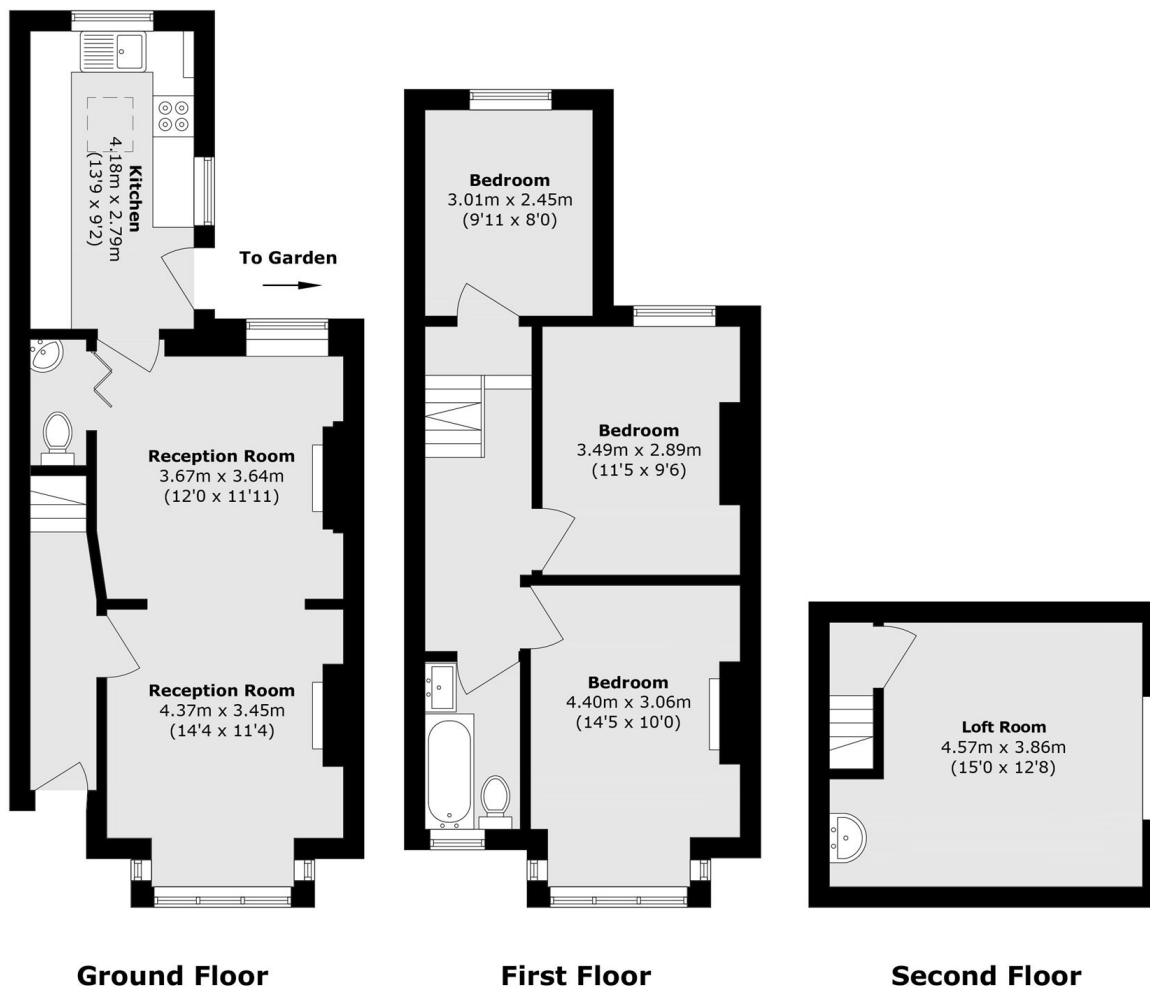

Total area (approx.): 105.6 sq. m (1136.6 sq. ft)