



7 Church Close, Bonby, BRIGG, DN20 0PQ

Guide Price £365,000



- Superb Detached House
- Kitchen and Utility Room
- En-Suite to Master Bedroom
- Enclosed Rear Garden
- Council Tax Band C
- Four Spacious Bedrooms
- Three Reception Rooms
- Ample Off-Road Parking and Garage
- Highly-Sought After Village Location

Discreetly positioned along a private drive, this attractive four-bedroom detached home offers bright, well-proportioned accommodation ideal for family living. The property features a dual-aspect lounge with a bespoke handmade fireplace, a separate dining room, a partially converted double garage that is utilised as a playroom/games room, a spacious conservatory, study, downstairs shower room and a stylish kitchen with adjoining utility room.

Upstairs, four comfortable bedrooms are served by a family bathroom and an en-suite to the principal bedroom. Outside, a generous reception driveway provides parking for up to six vehicles, alongside a single garage, while the rear garden is mainly laid to lawn.



## LOCATION

Bonby is a small and attractive rural village set within the rolling Lincolnshire countryside, offering a peaceful setting while remaining conveniently placed for access to nearby market towns and amenities. The area is well regarded for its open views, quiet surroundings, and strong sense of community. Despite its rural feel, the village is within easy reach of the center of Barton-upon-Humber, Brigg and Scunthorpe, providing a good range of shops, schools, and transport links. There is a local bus service to Barton-upon-Humber and Brigg that operates throughout the village, making it an appealing location for those seeking countryside living with everyday conveniences close at hand.

## ACCOMODATION

Spacious living accommodation arranged over two floors.

### HALLWAY 3.10m (10'2") x 2.90m (9'6")

A coloured uPVC entrance door with a decorative glazed panel opens into a spacious central hallway. The hallway features a timber and steel return staircase leading to the first floor, a radiator, and ceiling coving. There is also a useful linen cupboard with an additional radiator, providing practical storage space. The hallway offers access to the main ground floor rooms and creates a bright and welcoming entrance to the home.

### LOUNGE 5.87m (19'3") x 3.45m (11'4")

A bright dual-aspect room with a uPVC double glazed window to the front and double-glazed patio doors opening onto the rear terrace and garden. The room features a hand-crafted solid pine fire surround with a curved mantel, marble effect back and hearth, and an inset modern flame-effect gas fire. Additional features include two radiators, ceiling coving, and TV aerial and satellite points.

### KITCHEN 4.04m (13'3") x 2.51m (8'3")

Extensively fitted with a range of modern pale green fronted units complemented by composite marble and granite effect worktops. The kitchen includes a stainless-steel sink unit with cupboards beneath, an integrated dishwasher, and a selection of base units providing ample storage, together with sliding larder cupboards for added convenience.

Cooking facilities include an in-set five-burner stainless steel gas hob with a chimney-style extractor hood above, along with a built-in double oven and microwave with storage above and below. At eye level there are additional wall units with underlighting, as well as two glass-fronted display cabinets. The splash back areas are finished with contrasting tiling, and the room is completed with Amtico flooring, ceiling coving, and a uPVC double glazed window. An archway leads through to the utility room.

### UTILITY ROOM 2.06m (6'9") x 1.63m (5'4")

Fitted with a further cupboard to compliment the kitchen and incorporating an inset stainless steel sink unit. The room also houses a wall mounted gas combination boiler and provides space and plumbing for an automatic washing machine, along with space for an upright fridge/freezer. Additional features include a vertical radiator, Amtico flooring, and a half glazed rear door providing access to the outside.

### DINING ROOM 2.90m (9'6") x 2.90m (9'6")

This well-proportioned room enjoys a pleasant outlook through a double-glazed window overlooking the conservatory. The space provides ample room for a dining table and chairs, making it well suited to both everyday use and entertaining guests. Additional features include ceiling coving and a radiator, creating a comfortable and practical dining environment.

### CONSERVATORY 6.22m (20'5") x 2.49m (8'2")

A bright conservatory enjoying views over the rear garden, constructed with double glazed windows and a glazed roof to maximise natural light. The room features French doors providing direct access to the rear garden.

### STUDY 2.31m (7'7") x 2.26m (7'5")

A useful workspace with a uPVC double glazed window providing natural light. The room includes a radiator, ceiling coving, and spot lighting, along with fitted shelving and an extensive range of beech-effect fronted cupboards to one wall offering good storage. Additional features include a telephone point and access to a shallow roof space.

### PLAYROOM/GAMES ROOM 5.03m (16'6") x 2.54m (8'4")

A former garage has been thoughtfully converted into a cosy snug, providing a comfortable additional living space. The room features a carpeted floor, a radiator for efficient heating, and a uPVC window that allows natural light to brighten the space.

## DOWNSTAIRS SHOWER ROOM

Accessed through an opaque glazed door, this spacious ground floor shower room offers a walk-in shower cubicle, a pedestal hand wash basin and a low-level flush W.C. a uPVC window and vinyl flooring.

## LANDING

A distinctive staircase rises past a half landing featuring a fixed arched uPVC double glazed window, allowing natural light to fill the space, and continues to the main landing. The landing is finished with a timber and steel balustrade rail and provides laddered access to the first floor. A handy pull-down ladder allows access into the loft space.

### BEDROOM ONE 3.81m (12'6") x 2.90m (9'6")

With a uPVC double glazed window to the rear aspect, fitted with built-in blinds and providing pleasant views over the garden. The room is also fitted with a radiator and benefits from a range of built-in furniture along one wall, including three double wardrobes offering ample hanging and storage space. The layout provides plenty of room for additional bedroom furnishings, making it a comfortable and practical principal bedroom.

### EN-SUITE SHOWER ROOM 2.03m (6'8") x 1.57m (5'2")

Fitted with pedestal wash hand basin, and a glazed and tiled shower enclosure and a low-level flush W.C. The walls are tiled to half height, and additional features include a chrome towel radiator, electric shaver point, and a uPVC double glazed window providing natural light and ventilation.

### BEDROOM TWO 3.68m (12'1") x 3.17m (10'5")

With a uPVC double glazed window to the rear aspect, fitted with inset blinds and providing good natural light. The room also benefits from a radiator, creating a comfortable and practical space.

### BEDROOM THREE 3.51m (11'6") x 2.06m (6'9")

With a uPVC double glazed window to the rear elevation, fitted with integrated blinds, allowing for both natural light and privacy. The room also includes a radiator.

### BEDROOM FOUR 2.64m (8'8") x 2.34m (7'8")

With a uPVC double glazed window to the front elevation providing good natural light. The room also features a radiator and an attractive ceiling rose adding a decorative touch.

### BATHROOM 2.11m (6'11") x 1.68m (5'6")

Fitted with a three-piece suite comprising a panelled bath with mixer tap, pedestal wash hand basin, and close-coupled WC. The walls are finished with matching tiling to half height, and the room also benefits from a radiator, electric shaver point, and a uPVC double glazed window providing natural light and ventilation.

## OUTSIDE

The property is located at the head of a private drive and is approached via a generous block paved reception area providing off-road parking for up to six vehicles. An attached single garage sits beyond the driveway. The remainder of the frontage includes barked chipped areas for ease of maintenance and a flag stoned seating area. A timber shed is located adjacent to the garage and provides additional storage. A side pathway provides access to the rear garden, which is arranged over a lower lawn area and an upper patio seating area. The side and rear boundaries are clearly defined by timber panel fencing, creating a private and well enclosed outdoor space.

## FIXTURES AND FITTINGS

All built in appliances, blinds, most light fittings and fixed floor coverings are to be included within the sale of the property.

## SERVICES (not tested)

Mains electricity and gas, water and drainage are all understood to be connected to the property.

## COUNCIL TAX

The Council Tax Band for this property is Band C as confirmed by North Lincolnshire Council.









GROUND FLOOR  
1176 sq.ft. (109.2 sq.m.) approx.



1ST FLOOR  
554 sq.ft. (51.4 sq.m.) approx.

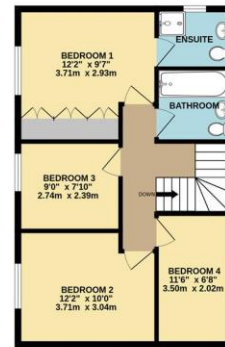

TOTAL FLOOR AREA : 1730 sq.ft. (160.7 sq.m.) approx.

Whilst every attempt has been made to ensure the accuracy of the floorplan contained here, measurements of doors, windows, rooms and any other items are approximate and no responsibility is taken for any error, omission or mis-statement. This plan is for illustrative purposes only and should be used as such by any prospective purchaser. The services, systems and appliances shown have not been tested and no guarantee as to their operability or efficiency can be given.  
Made with Metropix ©2026

**PROPERTY MISDESCRIPTION**

Conditions under which particulars are issued: Bell Watson & Co - for themselves and for their vendors or lessors of this property whose agents they are give notice that i) the particulars are set out as a general outline only for the guidance of the intending purchasers or lessees and do not constitute, or constitute part of an offer or contracts: ii) all descriptions, dimensions, references to condition and necessary permissions for use and occupation and other details are given in good faith but without responsibility on the part of the vendor, lessor, Bell Watson & Co or their employees. Any intending purchaser or lessee should not rely on them as statements or representations of fact but must satisfy themselves by inspection or otherwise as to the correctness of each of them: iii) no person in the employment of Bell Watson & Co has any authority to make or give representations or warranty whatsoever in relation to the property; iv) all rentals and prices are quoted exclusive of VAT where applicable; v) Bell Watson & Co will not be liable, in negligence or otherwise, for any loss arising from the use of these particulars.



These particulars are intended to give a fair description of the property but their accuracy cannot be guaranteed, and they do not constitute an offer of contract. Intending purchasers must read on their own inspection of the property. None of the above appliances/services have been tested by ourselves. We recommend purchasers arrange for a qualified person to check all appliances/services before legal commitment.