

RENT ME



HORNBEAM AVENUE, RED LODGE

£2,100 PCM



4



3



2



B

4 Bedroom House - Detached located in Bury St. Edmunds

****PERFECT FOR SHARERS **** Looking for a spacious property, combine your budget and you could be living in this beautiful property. Ideal for sharers with 2 ensuite bedrooms and a further 2 double bedrooms as guest rooms or study/gaming rooms. Pets by Neg. Available NOW.



GROUND FLOOR
APPROX. FLOOR
AREA 624 SQ. FT.
(58.0 SQ. M.)

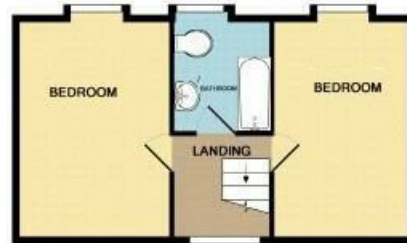

Council Tax Band

D

Energy Performance Graph

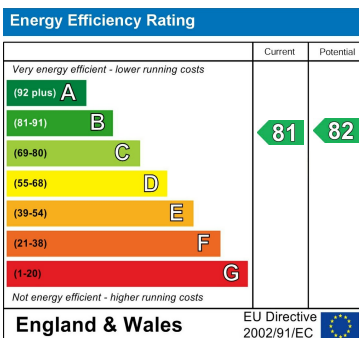

Call us on

01638 551551

enquiries@lodge-lettings.co.uk

www.lodge-lettings.co.uk

Agents Note: Whilst every care has been taken to prepare these particulars, they are for guidance purposes only. All measurements are approximate and are for general guidance purposes only and whilst every care has been taken to ensure their accuracy, they should not be relied upon and potential buyers are advised to recheck the measurements.