

Uckfield 01825 703000  
Crowborough 01892 489000  
Heathfield 01435 511800

Peter Oliver



## Willows Rise, Framfield, TN22 5PH

- ▼ 2 Bed Detached Bungalow
- ▼ Lounge/Diner, Kitchen
- ▼ Large Conservatory
- ▼ Garden With Views
- ▼ Garage & Driveway
- ▼ NO ONWARD CHAIN



### EPC RATING

Current:  
78 | C

Potential:  
82 | B

**Guide Price:**  
**£400,000 - £425,000**





## Willows Rise, Framfield, TN22 5PH

Set in a peaceful cul-de-sac within the sought-after village of Framfield, you will find this charming, detached bungalow that offers a rare opportunity to embrace countryside living in a quiet and picturesque setting. With NO ONWARD CHAIN, this property is ideal for those looking to move swiftly and settle into a tranquil lifestyle. The bungalow enjoys a wonderful outlook across open countryside, creating a sense of space and serenity that's hard to find. Whether you're relaxing in the conservatory or enjoying the garden, the views provide a calming backdrop to everyday life. Inside, the accommodation is thoughtfully laid out, featuring a generous lounge/dining room that offers ample space for both entertaining and unwinding. This room flows seamlessly into a bright conservatory/sunroom, perfect for enjoying the changing seasons and natural light. The kitchen is conveniently positioned and offers a practical layout with potential for personal touches. There are two well-proportioned double bedrooms, each offering comfortable accommodation and plenty of natural light. The layout is ideal for couples, small families, or those looking to downsize without compromising on space. A separate garage provides secure parking and useful storage, while the surrounding plot offers a sense of privacy and potential for landscaping or garden enhancements. The property's single-storey design makes it especially appealing for those seeking ease of access and low-maintenance living. Located in the heart of Framfield, a village known for its community spirit and rural charm, Willows Rise combines the best of countryside living with convenient access to nearby towns and amenities. Whether you're looking for a peaceful retreat or a welcoming home base, this bungalow ticks all the boxes.

Uckfield  
Crowborough  
Heathfield

01825 703000  
01892 489000  
01435 511800

Peter Oliver









87.9 sq.m. (946 sq.ft.) approx.

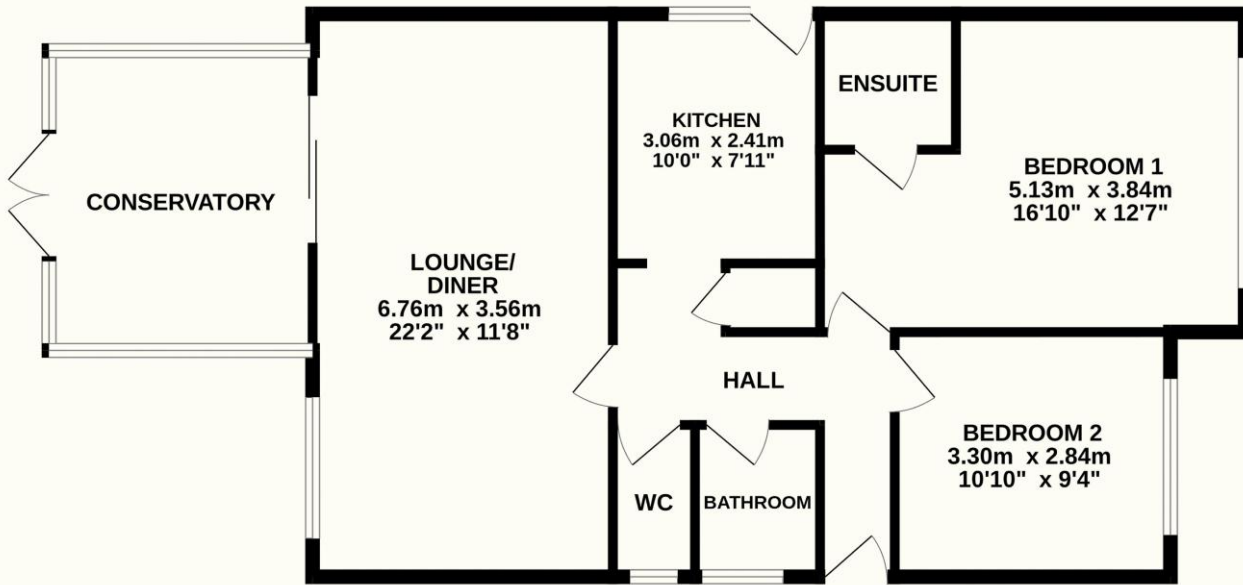

TOTAL FLOOR AREA : 100.5 sq.m. (1082 sq.ft.) approx.

Whilst every attempt has been made to ensure the accuracy of the floorplan contained here, measurements of doors, windows, rooms and any other items are approximate and no responsibility is taken for any error, omission or mis-statement. This plan is for illustrative purposes only and should be used as such by any prospective purchaser. The services, systems and appliances shown have not been tested and no guarantee as to their operability or efficiency can be given.

Made with Metropix ©2025



TENURE: FREEHOLD

COUNCIL TAX BAND: C

MAINTENANCE/SERVICE CHARGE: N/A

Uckfield 01825 703000  
Crowborough 01892 489000  
Heathfield 01435 511800  
info@peteroliverhomes.co.uk

Peter Oliver