



ANDREW
EXELBY
ESTATE AGENTS

Godolphin Terrace, Marazion TR17

Guide Price £500,000

🛏 3 🍽 1 🚗 1



- OFFERED TO THE MARKET WITH NO ONWARD CHAIN
- PEACEFUL CUL-DE-SAC LOCATION
- GARDENS TO FRONT AND REAR
- ELECTRIC HEATING
- LOVELY VIEWS TO ST MICHAELS MOUNT AND ACROSS MOUNTS BAY
- GARAGE AND PARKING
- UPVC DOUBLE GLAZING
- EPC RATING E47 / COUNCIL TAX BAND - D



Offered to the market with NO ONWARD CHAIN is this three bedroom detached bungalow that can be found within a peaceful cul-de-sac to the periphery of Marazion town. The property enjoys lovely far reaching views over roof tops from St Michaels Mount, across Mounts Bay to the pretty fishing village of Mousehole.

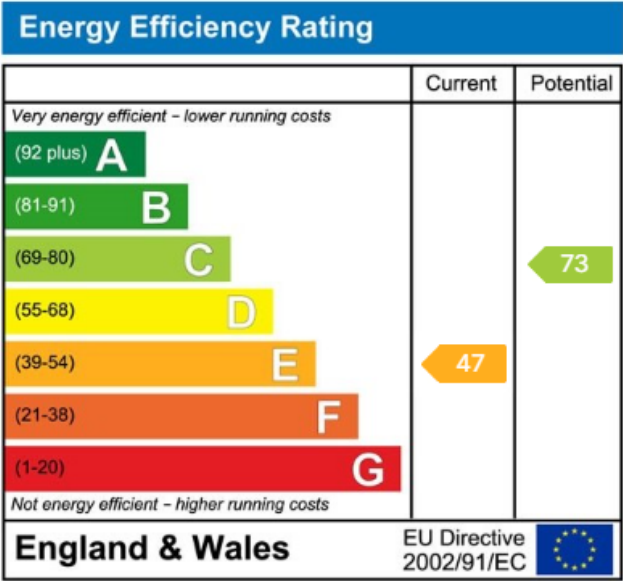
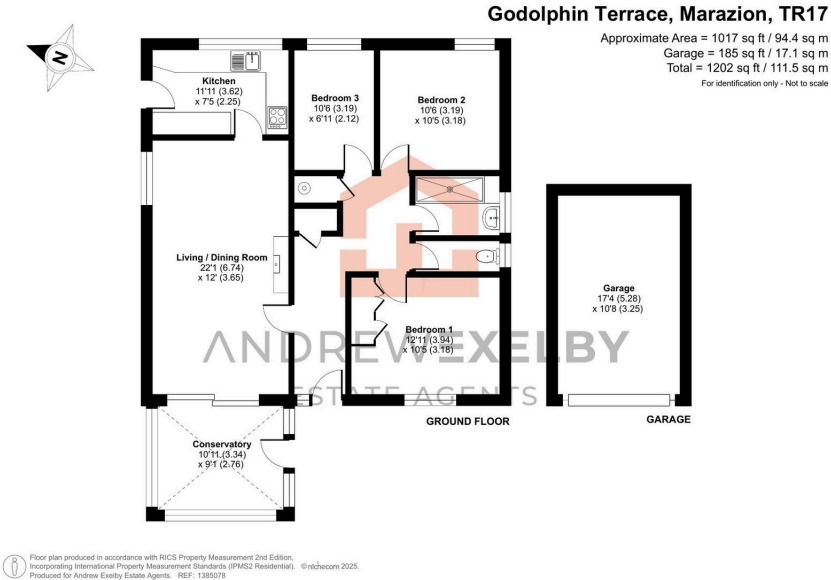

48 Causewayhead, Penzance,
Cornwall TR18 2SS
01736 697414
hello@endrewexelby.co.uk

andrewexelby.co.uk

Agents Note: Whilst every care has been taken to prepare these sales particulars, they are for guidance purposes only. All measurements are approximate are for general guidance purposes only and whilst every care has been taken to ensure their accuracy, they should not be relied upon and potential buyers are advised to recheck the measurements