

## Kechill Gardens, Hayes, BR2

5 2 3

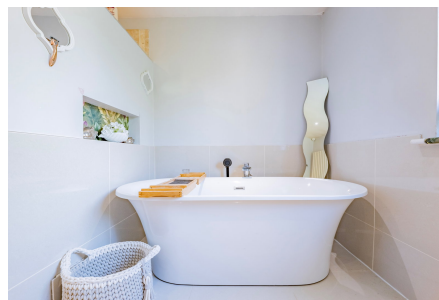

An exceptional five-bedroom family home offering an impressive 182 sq m of versatile living accommodation, perfect for growing or multi-generational families. Featuring a stunning open-plan kitchen/diner with bifold doors opening onto a beautiful decking area, overlooking an approx. 80ft landscaped rear garden ideal for entertaining. Further benefits include a large garage with conversion potential (STPP), ample driveway parking, substantial loft space, and exciting scope to further extend or reconfigure to suit your lifestyle. A rare opportunity to secure a substantial forever home with endless potential.

**Key Features**

- Please Quote RF0924 for All Enquiries
- 182 sq m of versatile living accommodatio
- Five generous bedrooms with flexible family layout
- Stunning open-plan kitchen/dining space
- Bifold doors opening onto raised decking area Beautiful approx. 80ft landscaped rear garden
- Ideal for multi-generational living or home working
- Larger-than-average garage with conversion potential (STPP)
- Significant loft extension potential (STPP)
- Ample driveway parking for multiple vehicles

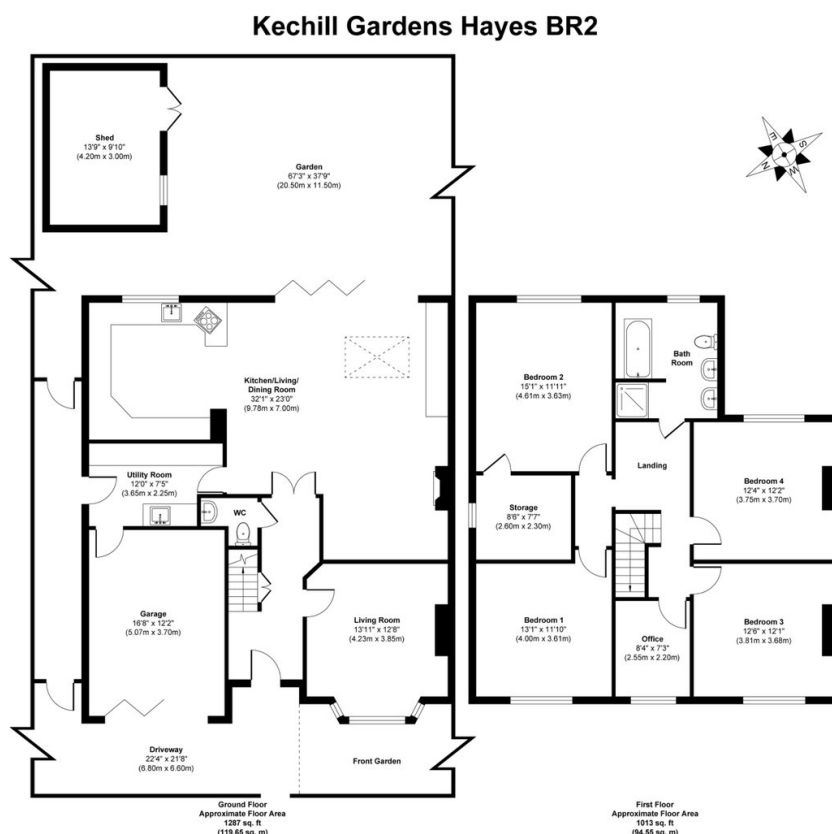

**Approx. Gross Internal Floor Area 2300 sq. ft / 214.20 sq. m (Including Garage/Outbuilding)**

Illustration for identification purposes only, measurements are approximate, not to scale.

Produced by Elements Property