



**Grantham Crescent, Ipswich, IP2 9PD**

**welcome to**

## **Grantham Crescent, Ipswich**

This beautifully presented, detached home benefits from three good-sized bedrooms, a stunning, open plan lounge, a conservatory, a large, landscaped, corner plot rear garden, a garage and ample off street parking.

### **Entrance Porch**

Impressive entrance porch with double glazed window to the side, Herringbone wood effect flooring, spotlights and a door to the hall.

### **Entrance Hall**

L shaped hall with Herringbone wood effect flooring, a fitted mat, double glazed window to the side, a Victorian style radiator, an oak staircase leading up to the first floor.

### **Kitchen**

Eye and base level units in navy with gold handles and quartz worktop surfaces, an inset one and a half bowl sink plus drainer and chrome mixer tap, tiled splashback in a textured black tile, fitted under counter lights, an integrated double Neff oven with induction hob and extractor hood, an integrated dishwasher and fridge/freezer, space for a washing machine, a chrome Victorian style radiator, spotlights, a boxed in boiler, Herringbone wood effect flooring and double glazed window to the rear.

### **Cloakroom**

Enclosed WC, vanity sink with brass mixer tap, oak effect flooring, spotlights and double glazed window to the front.

### **Lounge**

Stunning, open plan lounge with an opening to the conservatory, double glazed window to the front, Herringbone wood effect flooring, two radiators, TV point and a fitted gas fire with stone base and surround.

### **Conservatory**

Herringbone wood effect flooring, an opening to the lounge, a white vertical wall hung radiator, double glazed windows to the side and rear, a vaulted ceiling and patio doors to the garden.

### **First Floor Landing**

Double glazed window to the front, an oak staircase, loft hatch, spotlights and one electric radiator.

### **Bedroom Two**

Double glazed window to the rear, a bespoke triple fitted wardrobe & chests of drawers, carpet flooring and Victorian style radiator.

### **Bathroom**

Double glazed window to the side, chrome Victorian style heated towel rail, oak effect flooring, enclosed WC with matching vanity sink, double glazed window to the side, a P bath with overhead shower, shower attachment and glass screen, extractor fan, part tiled walls and shaver point.

### **Master Bedroom**

Double glazed window to the rear, carpet flooring, a Victorian style radiator, a double, fitted, sliding, mirrored wardrobe and a full wall of bespoke fitted cabinets, wardrobes and shelving, creating ample storage space.

### **Bedroom Three**

Double glazed window to the front, a Victorian style radiator, carpet flooring, spotlights and a full wall of bespoke fitted wardrobes with chests of drawers, shoe store and shelving.

### **Outside:**

#### **Garage**

An electric roller door, power, light, storage in the rafters and a door to the garden.

#### **Front Garden**

A large frontage with hedging, a sleeper border surround, a block paved driveway providing parking for two vehicles, a large grassed area to the side, two sets of double gates leading to the garden and a partial brick walled border.

#### **Rear Garden**

A large, North-West facing, corner plot garden, which is completely private, with a large side grassed area, double gates to the rear, 3 large sheds (to stay), a gate leading to the main garden, an additional side access through the garage, fully enclosed borders, patio areas, block paved seating areas, a raised decking area with balustrade and canopy over, perfect for enjoying the afternoon sun, a path, raised flower beds, hedging and trees, palm trees, power points and an outside tap and lights.

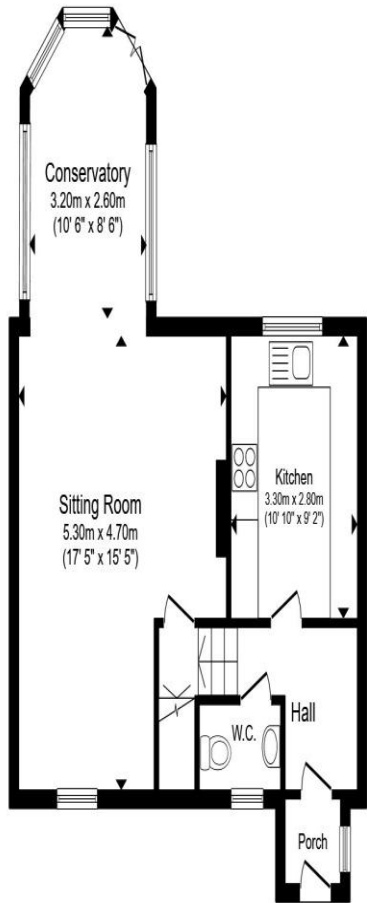

**Ground Floor**

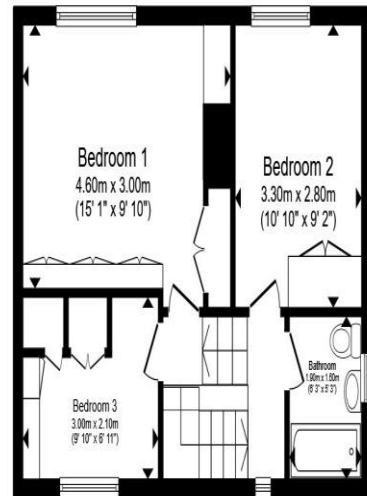

**First Floor**

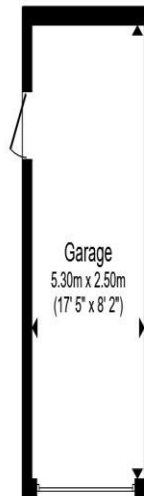

**Garage**

Total floor area 102.8 m<sup>2</sup> (1,106 sq.ft.) approx

This floor plan is for illustrative purposes only. It is not drawn to scale. Any measurements, floor areas (including any total floor area), openings and orientation are approximate. No details are guaranteed, they cannot be relied upon for any purpose and they do not form part of any agreement. No liability is taken for any error, omission or misstatement. A party must rely upon its own inspection(s). Powered by [www.propertybox.io](http://www.propertybox.io)



welcome to  
**Grantham Crescent,  
Ipswich**

- No-expense spared renovation throughout
- Three good-sized bedrooms, all with bespoke fitted wardrobes
- Fully fitted kitchen
- Garage & ample off street parking
- Large, landscaped, corner plot rear garden

Tenure: Freehold EPC Rating: C  
Council Tax Band: D

offers over  
**£360,000**



**view this property online** [williamhbrown.co.uk/Property/IPS121364](http://williamhbrown.co.uk/Property/IPS121364)



Property Ref:  
IPS121364 - 0005

1. MONEY LAUNDERING REGULATIONS Intending purchasers will be asked to produce identification documentation at a later stage and we would ask for your co-operation in order that there is no delay in agreeing the sale. 2. These particulars do not constitute part or all of an offer or contract. 3. The measurements indicated are supplied for guidance only and as such must be considered incorrect. Potential buyers are advised to recheck measurements before committing to any expense. 4. We have not tested any apparatus, equipment, fixtures or services and it is in the buyers interest to check the working condition of any appliances. 5. Where an EPC, or a Home Report (Scotland only) is held for this property, it is available for inspection at the branch by appointment. If you require a printed version of a Home Report, you will need to pay a reasonable production charge reflecting printing and other costs. 6. We are not able to offer an opinion either written or verbal on the content of these reports and this must be obtained from your legal representative. 7. Whilst we take care in preparing these reports, a buyer should ensure that his/her legal representative confirms as soon as possible all matters relating to title including the extent and boundaries of the property and other important matters before exchange of contracts.

William H Brown is a trading name of Sequence (UK) Limited which is registered in England and Wales under company number 4268443, Registered Office is Cumbria House, 16-20 Hockliffe Street, Leighton Buzzard, Bedfordshire, LU7 1GN. VAT Registration Number is 500 2481 05.



william h brown



**01473 226101**



[ipswich@williamhbrown.co.uk](mailto:ipswich@williamhbrown.co.uk)



16-18 Wolsey House, Princes Street, IPSWICH,  
Suffolk, IP1 1QT



[williamhbrown.co.uk](http://williamhbrown.co.uk)