



Kirkton Road, Cambuslang Glasgow G72 8LF

welcome to Kirkton Road, Cambuslang Glasgow

- End Terrace Villa
- Bright Spacious Lounge
- Modern Fitted Kitchen
- Three Bedrooms
- Family Bathroom

Tenure: Freehold EPC Rating: D
Council Tax Band: C

offers over
£125,000

Early viewing is strongly recommended to fully appreciate this elevated and spacious three bedroom end terraced villa nestled within this popular residential cul de sac. The property is presented in excellent decorative order throughout and is sure to impress.

Available in walk in condition the accommodation comprises entrance vestibule, attractive lounge with views over the front, modern fitted dining kitchen with a range of wall and base mounted units and centre island. There is also access to the rear garden.

The upper floor offers three bedrooms and family bathroom with three piece suite completing the accommodation.

The property features a fresh and neutral decorative theme throughout, gas central heating, front and rear gardens and allocated parking space.

Cambuslang offers a range of local shopping facilities with further amenities available in Rutherglen and East Kilbride. Access is available to the motorway network system. Public transport links and local schools are situated nearby. Recreational facilities within the area include several public parks, bowling, tennis clubs and a choice of golf courses.

Early Viewing Advised.

Entrance Hallway

Lounge

14' 10" x 10' 3" (4.52m x 3.12m)

Kitchen

14' 9" x 10' 5" (4.50m x 3.17m)

Bedroom One

10' 5" x 9' (3.17m x 2.74m)

Bedroom Two

10' 3" x 8' 6" (3.12m x 2.59m)

Bedroom Three

10' 3" x 8' 6" (3.12m x 2.59m)

Bathroom

7' 3" x 6' 5" (2.21m x 1.96m)

view this property online allenandharris.co.uk/Property/BSD109108



Property Ref:
BSD109108 - 0002

1. MONEY LAUNDERING REGULATIONS Intending purchasers will be asked to produce identification documentation at a later stage and we would ask for your co-operation in order that there is no delay in agreeing the sale. 2. These particulars do not constitute part or all of an offer or contract. 3. The measurements indicated are supplied for guidance only and as such must be considered incorrect. Potential buyers are advised to recheck measurements before committing to any expense. 4. We have not tested any apparatus, equipment, fixtures or services and it is in the buyers interest to check the working condition of any appliances. 5. Where an EPC, or a Home Report (Scotland only) is held for this property, it is available for inspection at the branch by appointment. If you require a printed version of a Home Report, you will need to pay a reasonable production charge reflecting printing and other costs. 6. We are not able to offer an opinion either written or verbal on the content of these reports and this must be obtained from your legal representative. 7. Whilst we take care in preparing these reports, a buyer should ensure that his/her legal representative confirms as soon as possible all matters relating to title including the extent and boundaries of the property and other important matters before exchange of contracts.



0141 613 3992



Burnside@allenandharris.co.uk



240 Stonelaw Road, Rutherglen, GLASGOW,
Lanarkshire, G73 3SA



allenandharris.co.uk

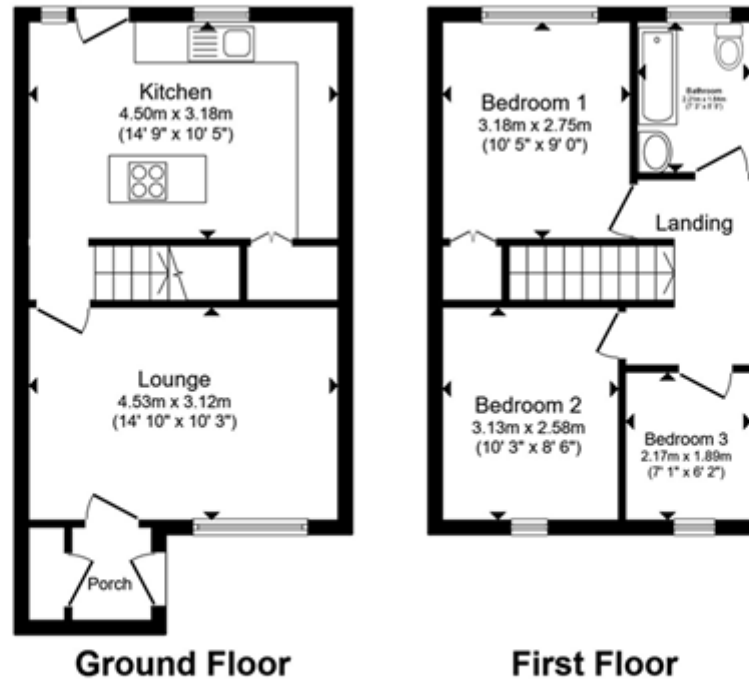

Total floor area 68.8 m² (740 sq.ft.) approx

This floor plan is for illustrative purposes only. It is not drawn to scale. Any measurements, floor areas (including any total floor area), openings and orientation are approximate. No details are guaranteed, they cannot be relied upon for any purpose and they do not form part of any agreement. No liability is taken for any error, omission or misstatement. A party must rely upon its own inspection(s). Powered by www.propertybox.io



view this property online allenandharris.co.uk/Property/BSD109108

1. MONEY LAUNDERING REGULATIONS Intending purchasers will be asked to produce identification documentation at a later stage and we would ask for your co-operation in order that there is no delay in agreeing the sale. 2. These particulars do not constitute part or all of an offer or contract. 3. The measurements indicated are supplied for guidance only and as such must be considered incorrect. Potential buyers are advised to recheck measurements before committing to any expense. 4. We have not tested any apparatus, equipment, fixtures or services and it is in the buyers interest to check the working condition of any appliances. 5. Where an EPC, or a Home Report (Scotland only) is held for this property, it is available for inspection at the branch by appointment. If you require a printed version of a Home Report, you will need to pay a reasonable production charge reflecting printing and other costs. 6. We are not able to offer an opinion either written or verbal on the content of these reports and this must be obtained from your legal representative. 7. Whilst we take care in preparing these reports, a buyer should ensure that his/her legal representative confirms as soon as possible all matters relating to title including the extent and boundaries of the property and other important matters before exchange of contracts.

Property Ref:
BSD109108 - 0002



0141 613 3992



Burnside@allenandharris.co.uk



240 Stonelaw Road, Rutherglen, GLASGOW,
Lanarkshire, G73 3SA



allenandharris.co.uk