



**GARDEN STIRLING BURNET**

**FLAT 2/1, 180 MEADOWPARK STREET**  
DENNISTOUN, GLASGOW, G31 2TE



**2**



**2**

**EPC  
RATING**

**B**

**COUNCIL  
TAX BAND**

**D**



Occupying a second-floor position within a modern development, this stylish two-bedroom flat offers bright, contemporary living in Glasgow's East End, appealing to professionals and buy-to-let investors. The welcoming hall provides excellent storage and leads into an impressive open-plan living/dining/kitchen, finished with sleek units, ample workspace, and integrated appliances. Two well-proportioned double bedrooms sit quietly at the rear, including a principal with an en-suite shower room, while the second offers home working flexibility. A separate bathroom features a shower-over-bath. Outside, there are allocated residents' parking spaces behind the building and local shops, cafés, and frequent transport links are within easy reach.  
Extras: All fitted floor and window coverings and light fittings are included.

## FEATURES

- Second-floor two-bedroom flat in a modern development
- Close to local amenities and transport links
- Accessed through a secure stairwell
- Bright living/dining kitchen with Juliet balcony
- Principal double bedroom with en-suite shower room
- Second double bedroom/home office
- Bathroom with a shower-over-bath
- Well-maintained communal grounds
- Allocated residents' parking
- Gas central heating and full double glazing





**OFFERS TO:**  
**40 High Street**  
**Glasgow, G1 1NL**  
**Tel:0141473 1124or**

**07761280 840**

[propertysales@gsbsolicitors.co.uk](mailto:propertysales@gsbsolicitors.co.uk)



#### HOUSE SALES

If you have a house to sell, we provide free pre-sales advice, including valuation. We will visit your home and discuss in detail all aspects of selling and buying, including costs and marketing strategy, and will explain GSB Properties' comprehensive services.

1. While these Sales Particulars are believed to be correct, their accuracy is not warranted and they do not form any part of any contract. All sizes are approximate.
2. Interested parties are advised to note interest through their solicitor as soon as possible in order to be kept informed should a Closing Date be set. The seller will not be bound to accept the highest or any offer.

## FLOORPLAN

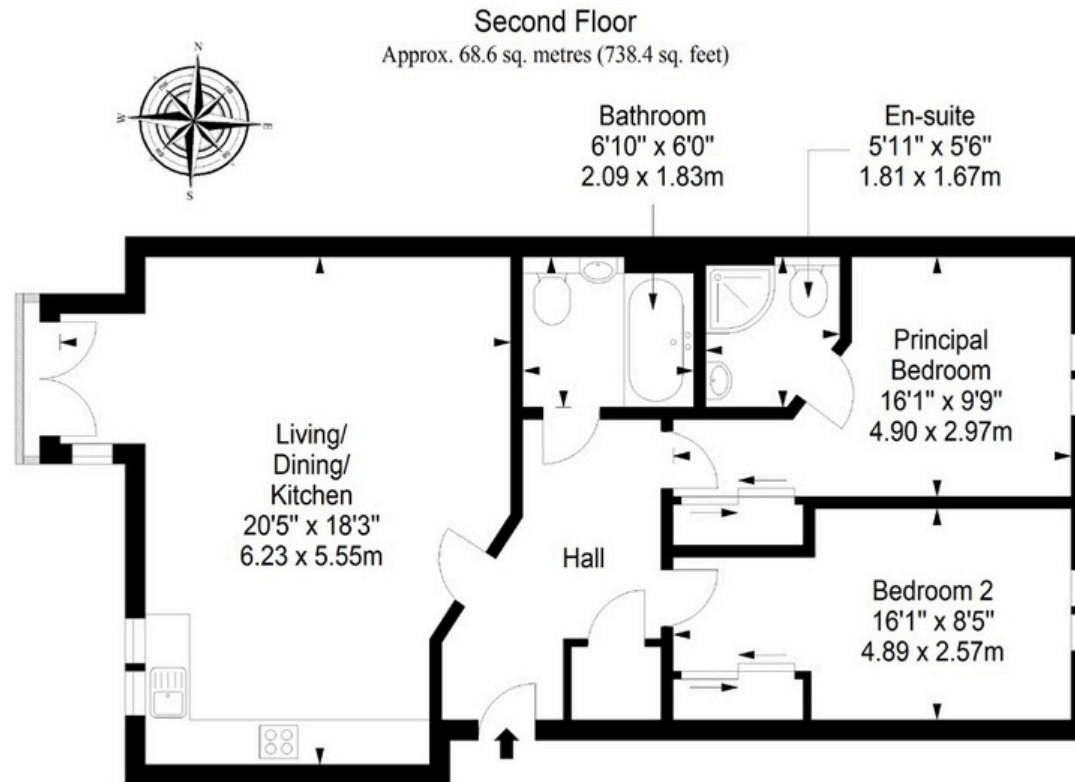

Total area: approx. 68.6 sq. metres (738.4 sq. feet)