



Apartment E1003, 2 Triptych Place, London, SE1 9RD
£2,865,000



Apartment E1003, 2 Triptych Place, London, SE1 9RD

£2,865,000

Interior Designed | 10th Floor | Concierge | Lounges | Games Room | Cinema Room | Large Apartment |
Stunning Views | 3x Balconies | WeChat: CLH-Consultant.

Description

Situation

null

Council Tax Band: G

Available:



Floor Plans

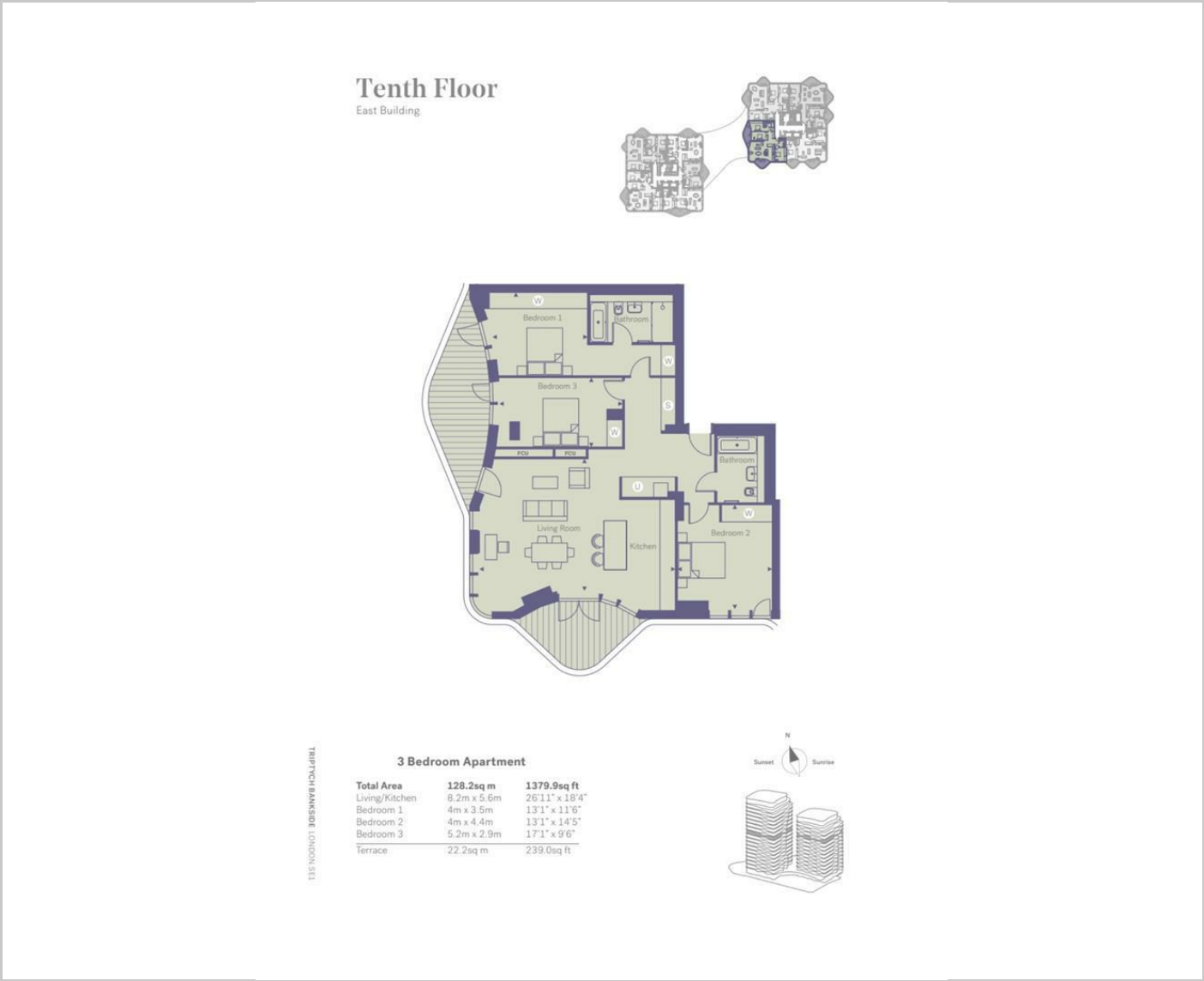

Area Map

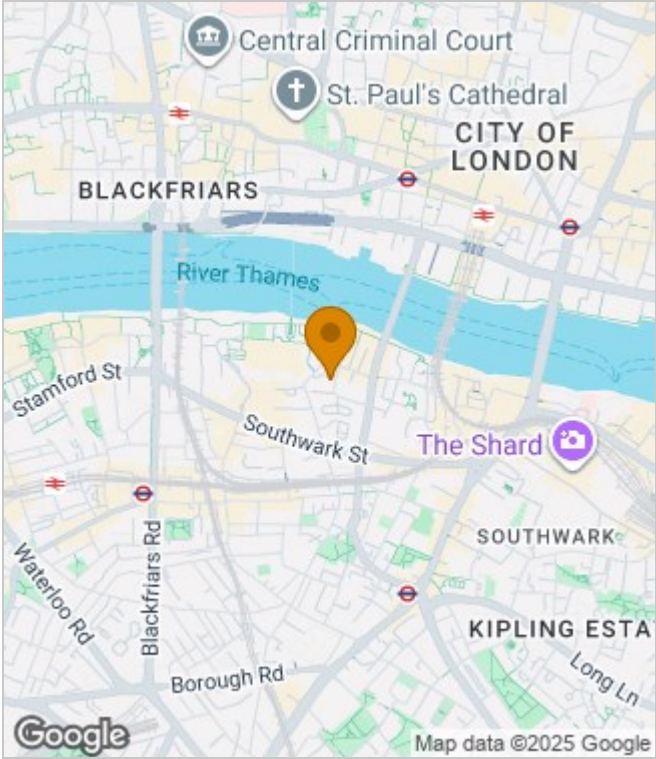

Energy Performance Graph

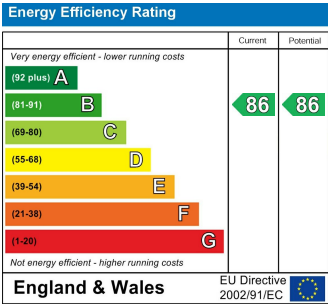

These particulars, whilst believed to be accurate are set out as a general outline only for guidance and do not constitute any part of an offer or contract. Intending purchasers should not rely on them as statements of representation of fact, but must satisfy themselves by inspection or otherwise as to their accuracy. No person in this firms employment has the authority to make or give any representation or warranty in respect of the property.