

14 Portland Street, Exeter
Exeter

£3,250 pcm



14 Portland Street

Exeter, Exeter

£150.00 PPPW, 48 Week Contract. Popular urban 5-bedroom terraced house in prime location, ideal for students. Spacious, modern rooms with workspace. Private low-maintenance courtyard with shed. Convenient access to amenities and parking permits. Contact for viewing. Council Tax band: C

Tenure: Freehold

EPC Energy Efficiency Rating: C

EPC Environmental Impact Rating: C

- Great location
- Excellent access to both campuses
- Outdoor private courtyard
- Parking permits available
- kitchen undergoing a full refurbishment for 2025/26 academic year





Kitchen

Galley kitchen with modern appliances, including down lights, Tall fridge freezer, washing machine

Lounge

neutral lounge, perfect for socialising with housemates.

Bedrooms

All bedroom come with a designated work space





YARD

A low maintenance courtyard with a shed.



GROUND FLOOR
538 sq.ft. (49.9 sq.m.) approx.



1ST FLOOR
512 sq.ft. (47.6 sq.m.) approx.

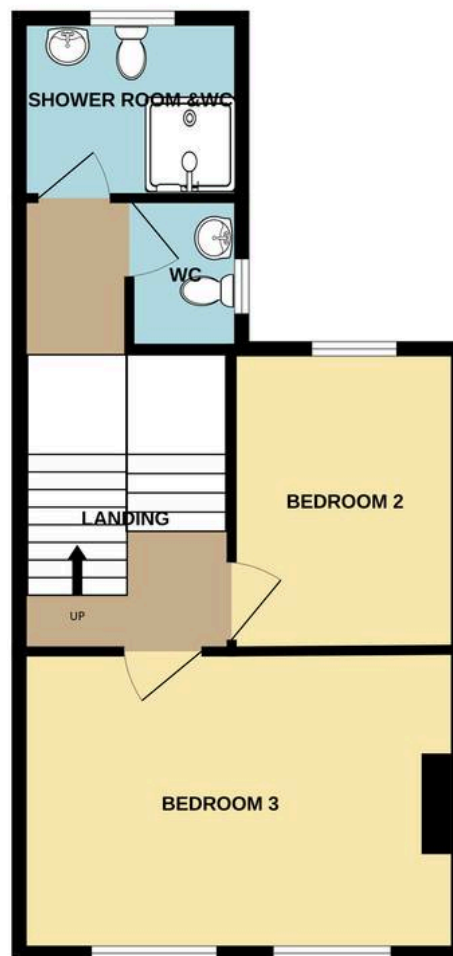

2ND FLOOR
348 sq.ft. (32.3 sq.m.) approx.

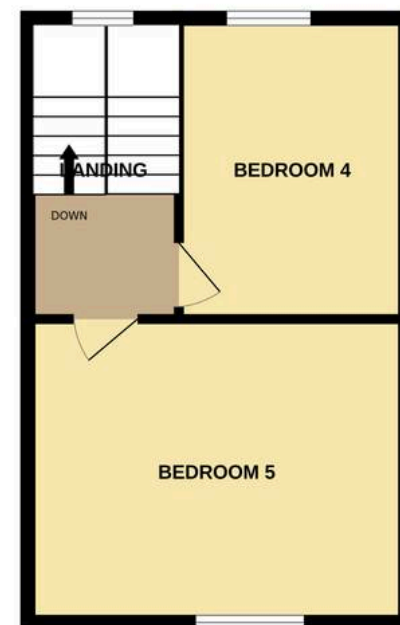

TOTAL FLOOR AREA : 1398 sq.ft. (129.9 sq.m.) approx.

Whilst every attempt has been made to ensure the accuracy of the floorplan contained here, measurements of doors, windows, rooms and any other items are approximate and no responsibility is taken for any error, omission or mis-statement. This plan is for illustrative purposes only and should be used as such by any prospective purchaser. The services, systems and appliances shown have not been tested and no guarantee as to their operability or efficiency can be given.

Made with Metropix ©2024

www.housenestates.co.uk