



## Northcote Road, SW11

£360,000

An impressive one double bedroom lateral apartment measuring over 500 Sq ft situated on the sought-after Northcote Road. Comprising a large reception, separate kitchen and modern bathroom. The property further benefits from being sold chain free.

Northcote Road sits perfectly between Clapham Common and Wandsworth Common, and is one of the most sought-after addresses in SW11. The area offers an exceptional lifestyle with Clapham Junction, a vibrant mix of cafés, boutiques, bars and restaurants, and a selection of highly regarded schools all within easy reach.

### Features

- Large Reception Room
- One Double Bedroom
- Modern Bathroom
- Superb Location
- Chain Free
- Low Service Charge

# Northcote Road, London, SW11

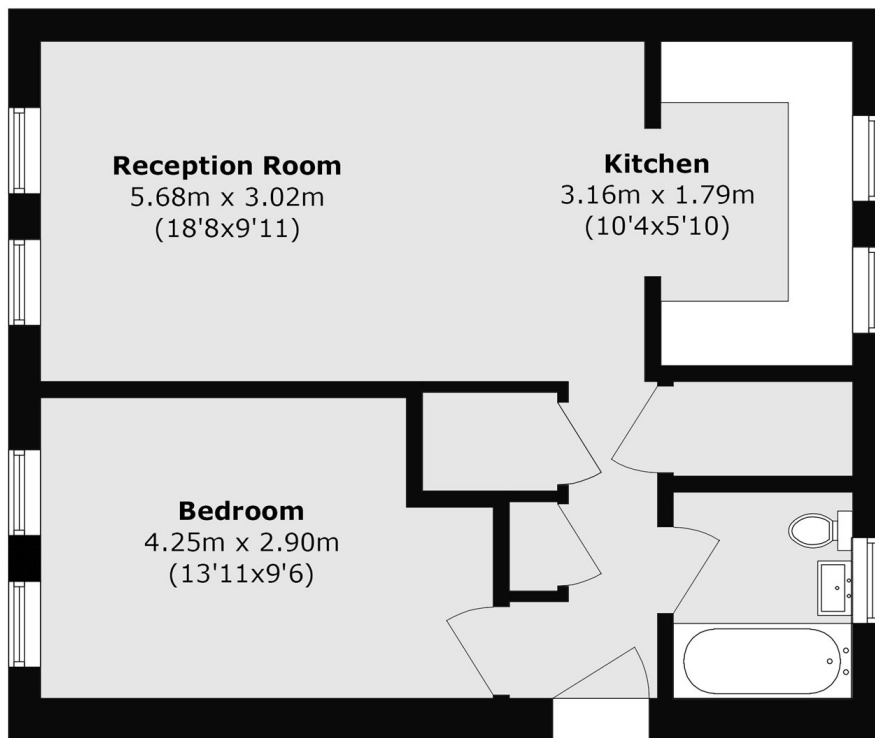

Total area (approx.): 47.1 sq. m (507.0 sq. ft)