



**Coopers**

**Coopers**

Shirebrook Close, Wood End, Coventry CV2 1UB

Freehold Price: £145,000



**Coopers**

## Shirebrook Close

Wood End, Coventry

Modern semi detached two bedroom home offering fantastic value for money. Full width living room and front kitchen. Two good sized bedrooms and bathroom. Gardens and direct access to private driveway.

Council Tax band: A

Tenure: Freehold

EPC Energy Efficiency Rating: C

- Modern semi detached home
- Living Room and kitchen
- Two generous bedrooms and bathroom
- Gardens to front and rear
- Direct access to private driveway
- Fantastic value for money
- No upward chain



**Coopers**



**Coopers**



**Coopers**



## Ground Floor

Approx. 32.0 sq. metres (344.1 sq. feet)

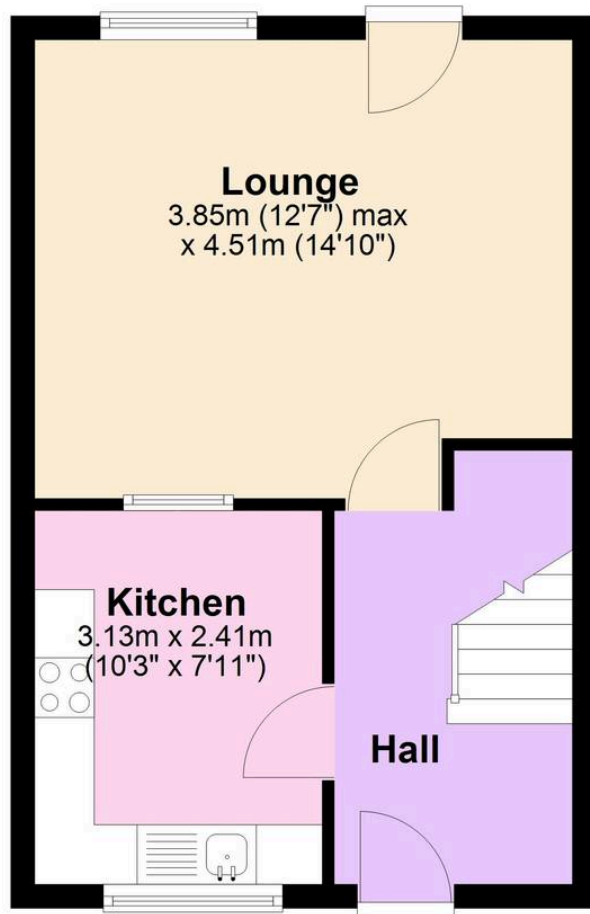

## First Floor

Approx. 32.4 sq. metres (348.7 sq. feet)

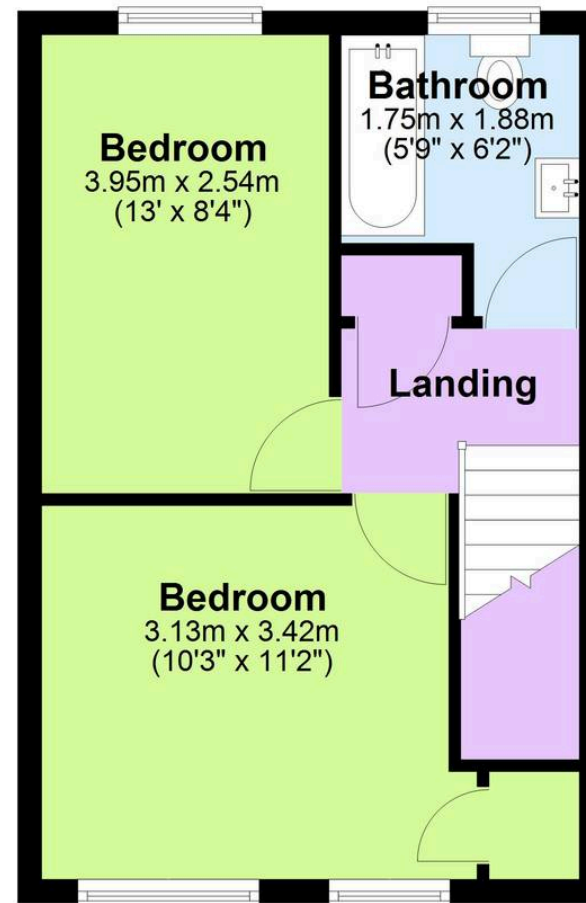

"Floor plan measurements are approximate and are for illustrative purposes only. While every effort is made to ensure accuracy, no responsibility is taken for any error, omission, or misstatement. Do not scale from this plan.

Plan produced using PlanUp.□□

Coopers Estate Agents

Coopers, 22 New Union Street - CV1 2HN

**Coopers**

Coopers Chartered Surveyors Ltd, 22 New Union Street, Coventry, West Midlands

CV1 2HN, 024 7655 2841, sales@coopers-cov.com. Company Registration

Number: 6725089 / VAT number: 940 3555 34

024 7655 2841 • sales@coopersstateagents.com • www.coopersstateagents.com/