



## 5 Turners Court

Melksham, SN12 8FE

### Guide Price £138,000

Welcome to 5 Turners Court. A two double bedroom second (top) floor apartment situated on the Chippenham side of Melksham with easy access to Chippenham, Corsham and the M4 corridor.

The accommodation comprises entrance hall with airing cupboard housing unvented hot water cylinder, open plan living space with fitted kitchen including integrated fridge & freezer, a washer dryer, electric oven and grill and four ring gas hob, a double bedroom with en-suite shower room, a second double bedroom with a fitted cupboard and bathroom.

The property further benefits from gas central heating, upvc double glazing and allocated parking for one car.

All room measurements are approx;  
Open plan living space: 4.9m x 3.92m  
Bedroom One: 2.73m x 4.99m at its widest point  
Bedroom Two: 2.89m x 2.8m

The owners have advised that the current ground rent is £240 per year.  
The owners have advised that the current service charge is £1486 per year.  
The owner has advised that the lease started on the 1st January 2006 for a period of 125 years.

- Two bedroom apartment
- No onward chain
- Allocated parking
- En-suite shower room
- Integrated appliances

### Viewing

Please contact our Blueleaf Property Office on 01225 839050 if you wish to arrange a viewing appointment for this property or require further information.





Floor Plan

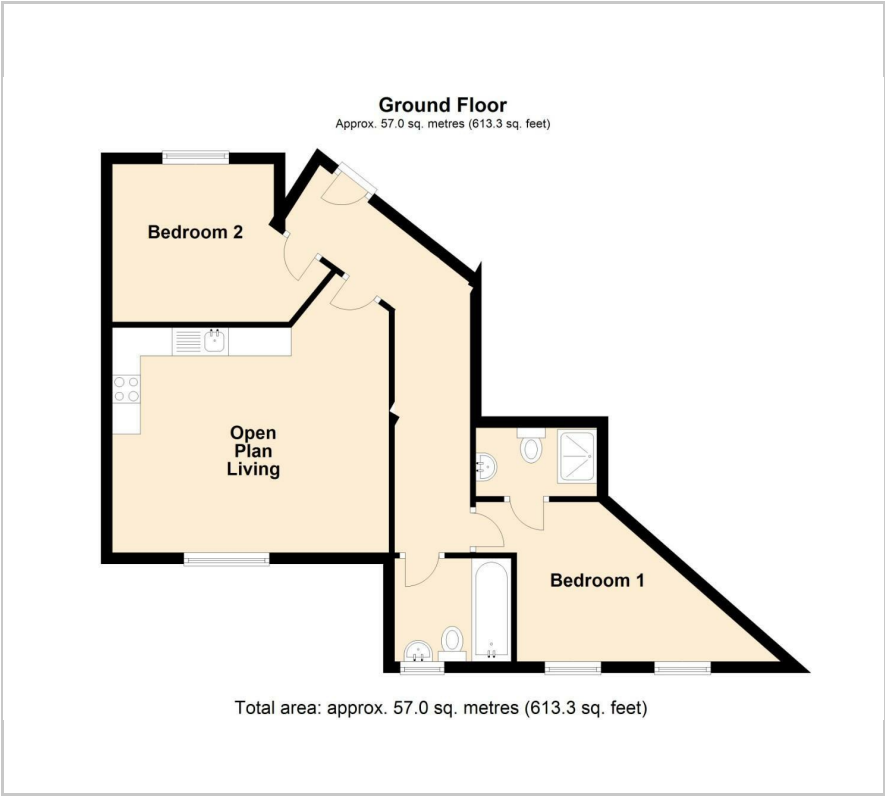

Area Map

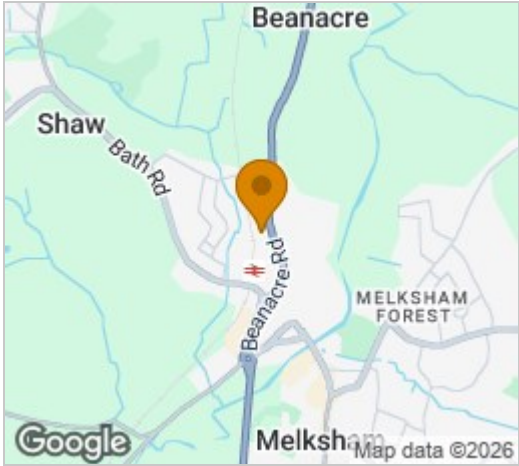

Energy Efficiency Graph

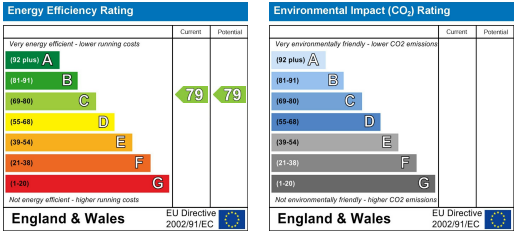

These particulars, whilst believed to be accurate are set out as a general outline only for guidance and do not constitute any part of an offer or contract. Intending purchasers should not rely on them as statements of representation of fact, but must satisfy themselves by inspection or otherwise as to their accuracy. No person in this firms employment has the authority to make or give any representation or warranty in respect of the property.