

FOR SALE



St Budock Way, Eve Parc, Falmouth
Offers In Excess of £270,000

MARTIN&CO

St Budock Way, Falmouth

OIEO £270,000

- CONSTRUCTED 2021 – 2022
- 6 YEARS REMAINING ON NHBC WARRANTY
- ELEVATED POSITION
- GOOD NATURAL LIGHT
- OFF STREET PARKING SPACE
- GAS CENTRAL HEATING

Constructed in 2021 – 2022, this modern, mid terrace property with GARDEN and PARKING now comes to the market, very well presented, with around 6 years remaining on the NHBC warranty. Ideal for first time buyers!

Benefitting from an elevated position, in a cul-de-sac on the southern side of Eve Parc, this lovely two double-bedroomed property has been well-maintained since purchase and benefits from off street parking and a level, lawned garden to the rear,

A flight of steps leads up to the path which runs in front of this small, raised terrace of houses, with off street parking for one car provided at road level. Additional parking is available nearby on-street or in designated, unallocated parking areas.



Entering the property you come into a hallway, with a downstairs WC and stairs in front of you to the first floor. A door to your right leads into the lounge, which has good natural light as it benefits from the elevated position. An under stairs cupboard provides valuable storage space and beyond is the kitchen / diner.

The kitchen has neutral floor and wall units, with the gas-boiler in a corner cupboard and an integrated electric oven and induction hob with extractor hood. Patio doors lead out to a level garden which is a combination of patio and lawn, with a garden shed and rear pedestrian access.

Stairs lead up to the first floor where you will find two double bedrooms and a part tiled, modern bathroom, with a shower over bath. In the second bedroom there is a large built-in cupboard over the stairwell.

Freehold

Off street parking space & shared guest parking space

Gas central heating and hot water

EPC – B

Council Tax Band B

UPVC Double Glazing

Annual estate maintenance charge : £208 Paid Jan '26

Mains Gas, Water, Drainage & Electric

Broadband : Ultrafast Broadband Available

Mobile Phone Coverage: O2 / EE / Three / Vodafone -

Please contact individual providers for further information

Source: www.ofcom.org.uk

LOCATION

St Budock Way is situated on the southern side of Eve Parc, a popular new development just outside of Falmouth town-centre, with easy access to local amenities, schools, and transport links. A great choice for those looking for a modern home in a well-connected location.

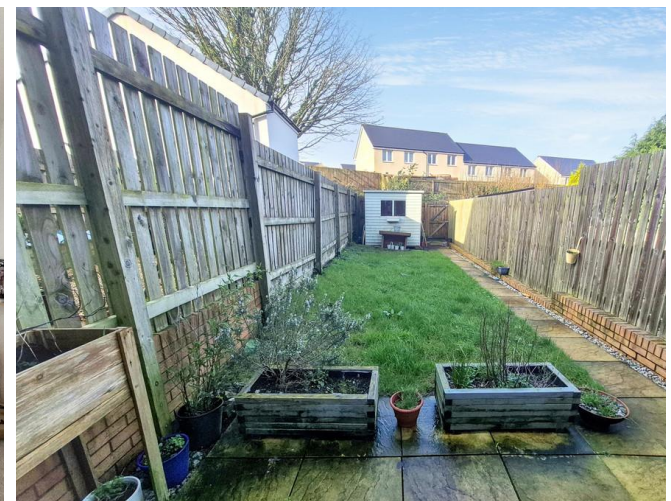

Approx Gross Internal Area
54 sq m / 577 sq ft

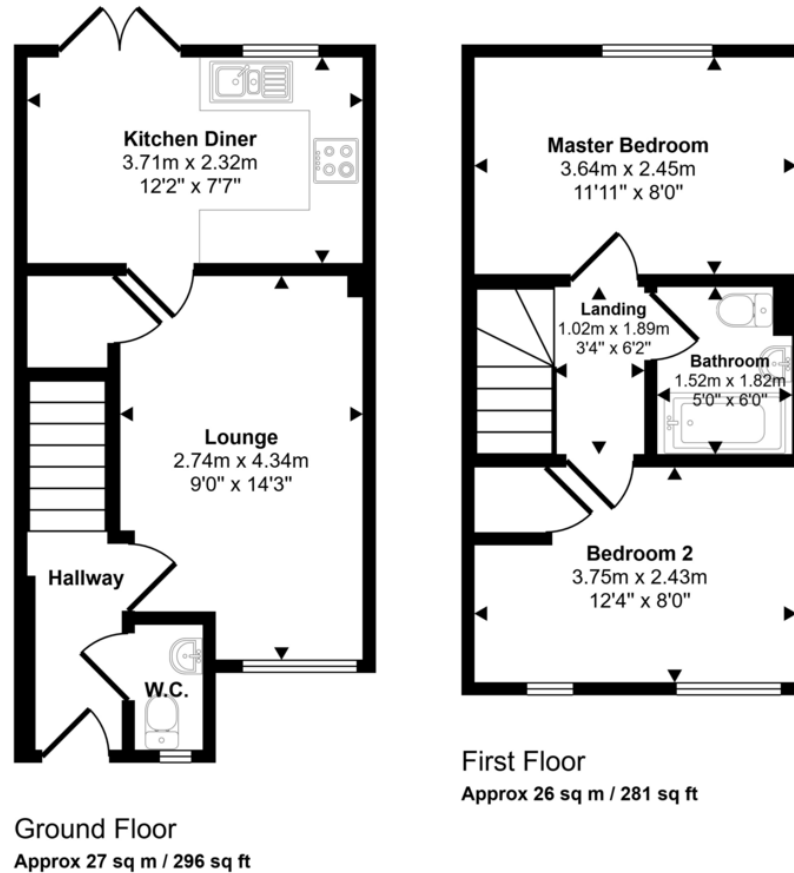

This floorplan is only for illustrative purposes and is not to scale. Measurements of rooms, doors, windows, and any items are approximate and no responsibility is taken for any error, omission or mis-statement. Icons of items such as bathroom suites are representations only and may not look like the real items. Made with Made Snappy 360.

Martin & Co Falmouth

72 Kimberley Park Road • Falmouth • TR11 2DF
T: 01326 697696 • E: falmouth@martinco.com

01326 697696

<http://www.martinco.com>



Accuracy: References to the Tenure of a Property are based on information supplied by the Seller. The Agent has not had sight of the title documents. A Buyer is advised to obtain verification from their Solicitor. Items shown in photographs including but not limited to carpets, fixtures and fittings are not included unless specifically mentioned within the sales particulars. They may however be available by separate negotiation. Buyers must check the availability of any property and make an appointment to view before embarking on any journey to see a property. No person in the employment of the agent has any authority to make any representation about the property, and accordingly any information given is entirely without responsibility on the part of the agents, sellers(s) or lessors(s). Any property particulars are not an offer or contract, nor form part of one. **Sonic / Laser Tape:** Measurements taken using a sonic / laser tape measure may be subject to a small margin of error. **All Measurements:** All Measurements are Approximate. **Services Not tested:** The Agent has not tested any apparatus, equipment, fixtures and fittings or services and so cannot verify that they are in working order or fit for the purpose. A Buyer is advised to obtain verification from their Solicitor or Surveyor.