



Lea Yield Close, Birmingham B30 2LZ

welcome to

Lea Yield Close, Birmingham

**** GREAT INVESTMENT OPPORTUNITY OR FIRST TIME BUY**** WELL PRESENTED STUDIO MAISONETTE **** GROUND - FLOOR **** SEPARATE KITCHEN AND BATHROOM *** TWO ALLOCATED PARKING SPACES ****

Agent Note

The Council Tax Band is A. We are informed the annual ground rent is £0.

The lease has been extended to 146 years and peppercorn rent of £0/year.

Living Room/Bedroom

21' 3" x 14' 4" (6.48m x 4.37m)

With double glazed windows to the front and side aspect

Kitchen

9' 1" x 5' 2" (2.77m x 1.57m)

With a range of wall and base units, and electric hob and oven with extractor hood over, a sink/drain, plumbing for a dishwasher/washing machine and a double-glazed window to the front

Bathroom

With a sink, w/c, and a bath with shower over.

Parking

2 allocated parking spaces.





view this property online shipways.co.uk/Property/HBN112111



welcome to

Lea Yield Close, Birmingham

- Ground floor studio maisonette.
- Great buy to let investment or first time buy
- Popular residential area.
- Two allocated parking spaces
- Near to Birmingham City Centre

Tenure: Leasehold EPC Rating: D

Council Tax Band: A Service Charge: Ask Agent

Ground Rent: £0

This is a Leasehold property with details as follows; Term of Lease 146 years from 15 Jan 2026. Should you require further information please contact the branch. Please Note additional fees could be incurred for items such as Leasehold packs.

£120,000

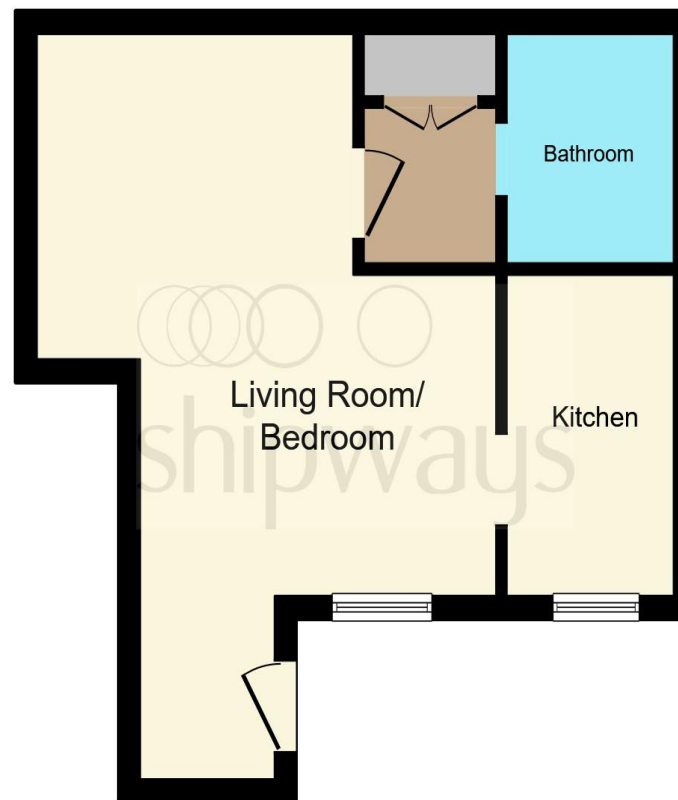

This floor plan is for illustrative purposes only. It is not drawn to scale. Any measurements, floor areas (including any total floor area), openings and orientation are approximate. No details are guaranteed, they cannot be relied upon for any purpose and they do not form part of any agreement. No liability is taken for any error, omission or misstatement. A party must rely upon its own inspection(s). Powered by www.focalagent.com

view this property online shipways.co.uk/Property/HBN112111



Property Ref:
HBN112111 - 0004

1. MONEY LAUNDERING REGULATIONS Intending purchasers will be asked to produce identification documentation at a later stage and we would ask for your co-operation in order that there is no delay in agreeing the sale. 2. These particulars do not constitute part or all of an offer or contract. 3. The measurements indicated are supplied for guidance only and as such must be considered incorrect. Potential buyers are advised to recheck measurements before committing to any expense. 4. We have not tested any apparatus, equipment, fixtures or services and it is in the buyers interest to check the working condition of any appliances. 5. Where an EPC, or a Home Report (Scotland only) is held for this property, it is available for inspection at the branch by appointment. If you require a printed version of a Home Report, you will need to pay a reasonable production charge reflecting printing and other costs. 6. We are not able to offer an opinion either written or verbal on the content of these reports and this must be obtained from your legal representative. 7. Whilst we take care in preparing these reports, a buyer should ensure that his/her legal representative confirms as soon as possible all matters relating to title including the extent and boundaries of the property and other important matters before exchange of contracts.

Shipways is a trading name of Sequence (UK) Limited which is registered in England and Wales under company number 4268443, Registered Office is Cumbria House, 16-20 Hockliffe Street, Leighton Buzzard, Bedfordshire, LU7 1GN. VAT Registration Number is 500 2481 05.

shipways



0121 427 3264



harborne@shipways.co.uk



172 High Street, Harborne, BIRMINGHAM,
West Midlands, B17 9PP



shipways.co.uk