

Location

Location Map

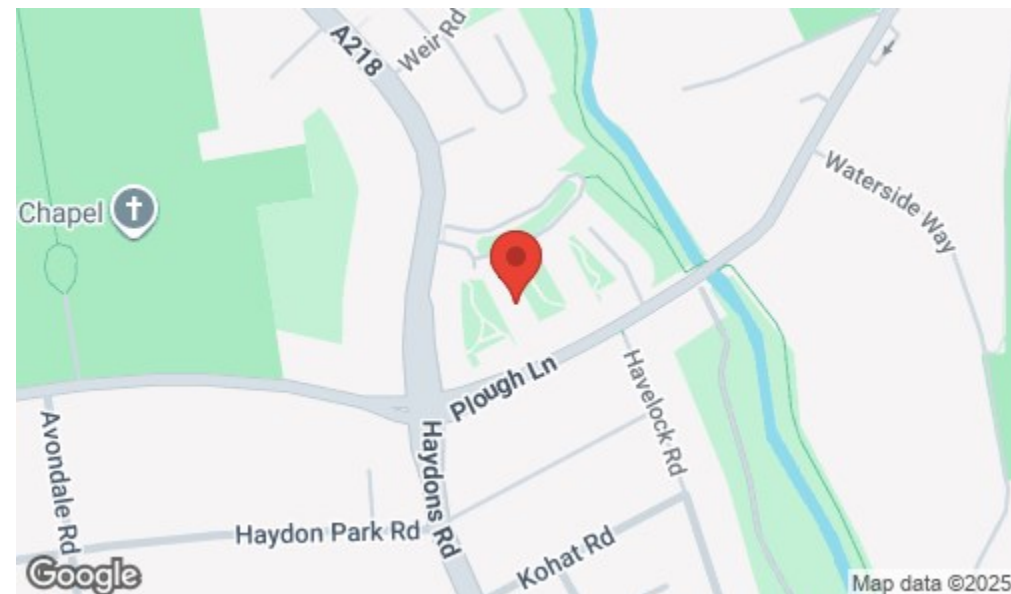

Important Note

Centro Residential Sales and Lettings limited have not tested any services, heating system, electrical system, appliances, fixtures and fittings, that may be included in this property and would advise interested parties to satisfy themselves as to their condition or investigating the presence of any deleterious materials.

Viewing: Strictly by appointment through:

CENTRO RESIDENTIAL SALES AND LETTINGS LIMITED

Tel: 020 8401 5000

E-mail: residential@centro.plc.uk

See a selection of our properties at www.centro.plc.uk

Flat 26

£2,250 Per Month -

Durnsford Road, London, SW19 8FP



Description

- Purpose Build
- Two Bedrooms
- Two Bathrooms
- Open-Plan Lounge
- Modern Kitchen
- Balcony
- Communal Gardens
- Underground Parking
- EPC Rating C
- Council Tax Band D

Features

- Electric Heating
- Double Glazing
- Neutral Decor

What you need to know

- Term: 6-2 months
- Rent: £2250pcm exclusive of bills
- Security deposit: £2596.00
- Council Tax Band C
- Energy Rating: C



Accommodation

Additional Photo



All dimensions and measurements are approximate and for guidance only.

Just Centro's Opinion...

Live the Wimbledon Lifestyle – 2-Bed, 2-Bath Luxury Apartment, SW19 – 784 sq ft

Step into contemporary elegance in this beautifully presented first floor two-bedroom, two-bathroom apartment in Wimbledon. With 784 sq ft of thoughtfully designed space, this home is perfect for professionals, couples, sharers, or small families seeking comfort, style, and convenience.

The moment you enter, you'll notice the bright, open-plan living and dining area, flowing seamlessly onto a private balcony — the perfect spot for morning coffee, evening unwinding, or simply soaking in the city vibes. The apartment comes furnished to a high standard, featuring a sleek, fully-equipped kitchen, generous storage, and two spacious double bedrooms, including a master with en-suite.

Residents enjoy secure underground parking, lift, a concierge, and beautifully maintained communal spaces, offering peace of mind and a premium lifestyle experience.

Location is everything, and this home delivers:

EPC Graph

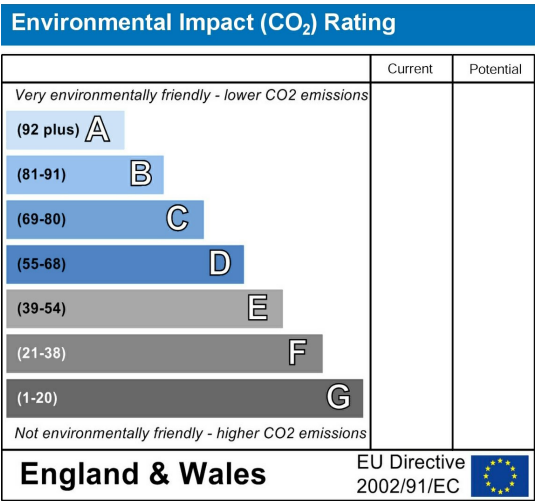
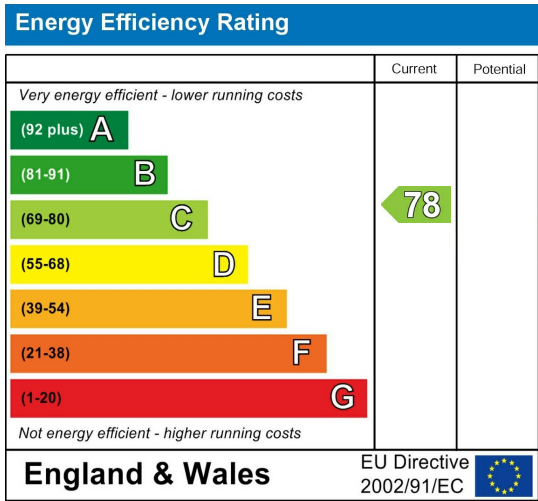

Floor Plan

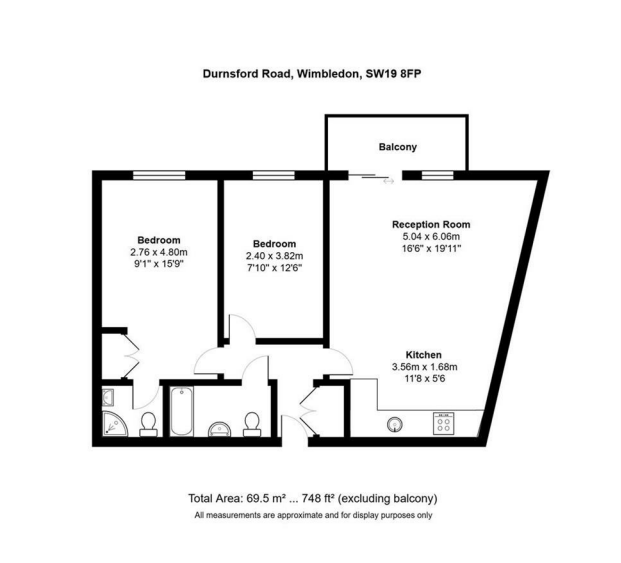

For illustration purposes only