



**Guide Price**  
**£360,000**

**Freehold**

3x  1x  1x 

**Broomshaw Road,  
Barming, Kent ME16**

**OVER 60?**

Secure this property  
for up to **59% less!**

*Wards*  
Helping you move forwards



## Main features

- 1970's style family house
- Central heating and double glazing
- Set in a no through road
- Spacious rear garden with patio and gazebo
- Located in the ever popular suburb of Barming

## Accommodation

### GROUND FLOOR

Hallway  
 Lounge: 12'4 x 11'2 (3.76m x 3.41m)  
 Dining Area: 10'9 x 9'4 (3.28m x 2.85m)  
 Kitchen: 12'3 x 8'9 (3.74m x 2.67m)

### FIRST FLOOR

Landing  
 Bedroom 1: 11'2 x 10'3 (3.41m x 3.13m)  
 Bedroom 2: 11'3 x 10'3 (3.43m x 3.13m)  
 Bedroom 3: 8'2 x 7'2 (2.49m x 2.19m)  
 Bathroom

### OUTSIDE

Rear Garden  
 Front Garden  
 Off Road Parking

### Ground Floor

Approx. 41.4 sq. metres (446.0 sq. feet)

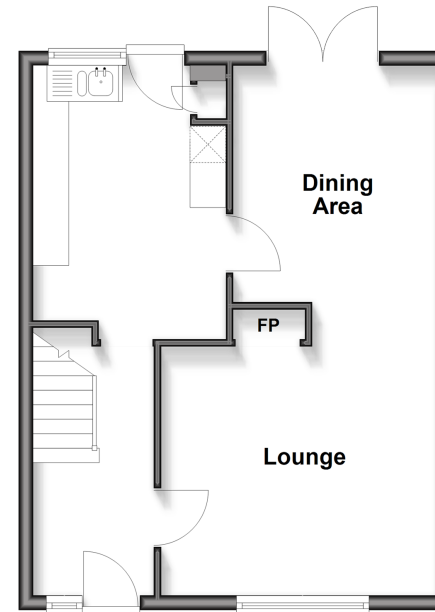

### First Floor

Approx. 41.4 sq. metres (446.0 sq. feet)

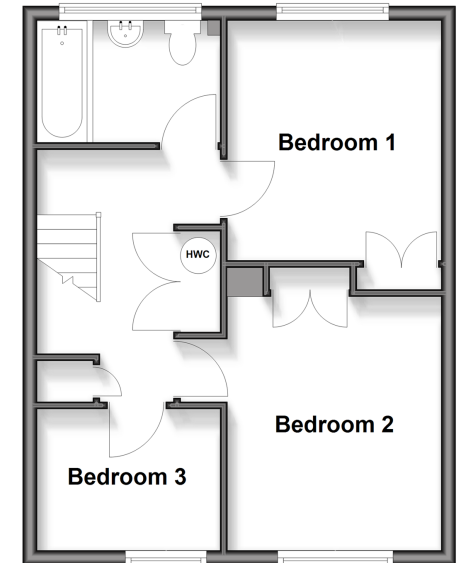

Call Maidstone - 01622 683737 ■ [wardsof Kent.co.uk](http://wardsof Kent.co.uk)

■ Through a Homewise Home For Life Plan people aged 60+ can secure this property for up to 59% less, by purchasing a Lifetime Lease



13158949/20260402/SS1/DS