

BARTON FLEMING

INDEPENDENT ESTATE AGENTS



**30 Trinity House West, Graven Hill,
Bicester, Oxfordshire. OX25 2DR**

BARTON FLEMING

INDEPENDENT ESTATE AGENTS

Web: www.bartonfleming.co.uk
E-mail: info@bartonfleming.co.uk
62 North Street, Bicester. OX26 6NF

Tel: Bicester (01869)

249922

30 Trinity House West, Graven Hill, Bicester, Oxon. OX25 2DR



**A Luxury Studio Apartment in Graven Hill with Lift to all Floors
and Underground Parking Space**

LEASEHOLD

£ 179,950

- ❖ Luxury apartment Block in Graven Hill
- ❖ Communal entrance with fob entry and intercom
- ❖ Lift to all Floors
- ❖ Private Entrance Hall with utility cupboard
- ❖ Open plan Studio/Diner/Kitchen
- ❖ Bathroom/WC
- ❖ Secure underground parking space
- ❖ Close to Local Amenities

VIEWING
APPOINTMENT:

DAY:

TIME:

BARTON FLEMING

INDEPENDENT ESTATE AGENTS

Web: www.bartonfleming.co.uk
E-mail: info@bartonfleming.co.uk
62 North Street, Bicester. OX26 6NF

Tel: Bicester (01869)

249922

Key Facts for Buyers:

EPC: Rating of B (82).
Council Tax: Band A
Approx. £1,643 per annum.

Leasehold Information:

Freeholder: Adriatic Land
13 Limited
Management Company: Graven Hill
Village Management Company Block E Ltd
Lease Term: 150 years from 1 January
2020
Service Charge: approx. £651.95 per
annum
Building Insurance: approx. £205 per
annum
Ground Rent: £139.95 per annum

Ground Floor:

COMMUNAL HALLWAY

Wooden front door to:

ENTRANCE AREA:

Plain plaster ceiling, luxury vinyl flooring, wall mounted "Hyco" panel heater, intercom, utility cupboard (*enclosing "Tempest" pressurised hot water cylinder, RCD/MCB electricity consumer unit, Economy 7 digital programmer, "Nuair" MRX Box heater recovery and air refresh system*), space for washing machine, space for clothes drying rack, internet hub box.

BATHROOM: 7'2 x 7'0

Plain plaster ceiling, heat/ventilation recovery vent, downlighting, chrome heated towel rail, luxury vinyl flooring, panel enclosed bath with mixer tap shower attachment, sliding head support, screen, tiled surrounds, pedestal wash hand basin, mirror with light over, dual flush close coupled WC.

STUDIO: 16'0 x 15'3 overall

Studio Area: Rear aspect twin PVC full height windows, multi-media socket, three Cat points, fitted 1200mm wardrobe.

Kitchen/Dining Area: Space for small table and chairs. Range of base and eye level units, square edge composite worksurfaces, tall unit (600mm wide) housing 1000mm tall fridge and 640mm freezer (3 drawers), integrated dishwasher, 600mm under sink unit, undermounted stainless steel sink, 450mm base unit, stainless steel and glass fan oven/grill, 4-ring electric hob, 400mm drawers.

Outside:

COMMUNAL AREAS: refer to photograph

PARKING: 18'10 x 9'5 refer to photograph

Allocated undercroft parking for one car.

BARTON FLEMING

INDEPENDENT ESTATE AGENTS

Web: www.bartonfleming.co.uk
E-mail: info@bartonfleming.co.uk
62 North Street, Bicester. OX26 6NF

Tel: Bicester (01869)

249922



Entrance to Block



Communal Entrance Hall and Staircase



Communal Hallway and Flat Entrance Door



Entrance Area



Bathroom



Bathroom



Utility Cupboard



Studio Area

BARTON FLEMING

INDEPENDENT ESTATE AGENTS

Web: www.bartonfleming.co.uk
E-mail: info@bartonfleming.co.uk
62 North Street, Bicester. OX26 6NF

Tel: Bicester (01869)

249922



Open Plan Studio/Kitchen Area



Kitchen Area

BARTON FLEMING

INDEPENDENT ESTATE AGENTS

Web: www.bartonfleming.co.uk
E-mail: info@bartonfleming.co.uk
62 North Street, Bicester. OX26 6NF

Tel: Bicester (01869)

249922



Studio Area



Kitchen Area



View from Windows



Undercroft Parking (actual parking space TBC)



Street Scene



Street Scene



Park over the Road

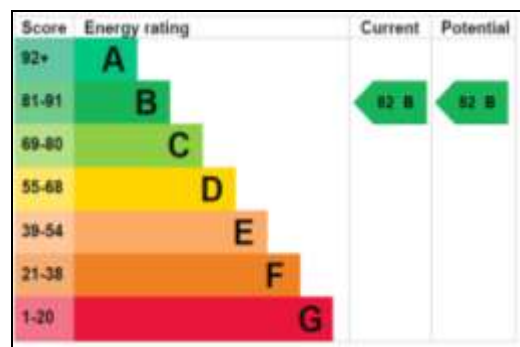

EPC

BARTON FLEMING

INDEPENDENT ESTATE AGENTS

Web: www.bartonfleming.co.uk
E-mail: info@bartonfleming.co.uk
62 North Street, Bicester. OX26 6NF

Tel: Bicester (01869)

249922



Space for Notes

BARTON FLEMING

INDEPENDENT ESTATE AGENTS

Web: www.bartonfleming.co.uk
E-mail: info@bartonfleming.co.uk
62 North Street, Bicester. OX26 6NF

Tel: Bicester (01869)
249922

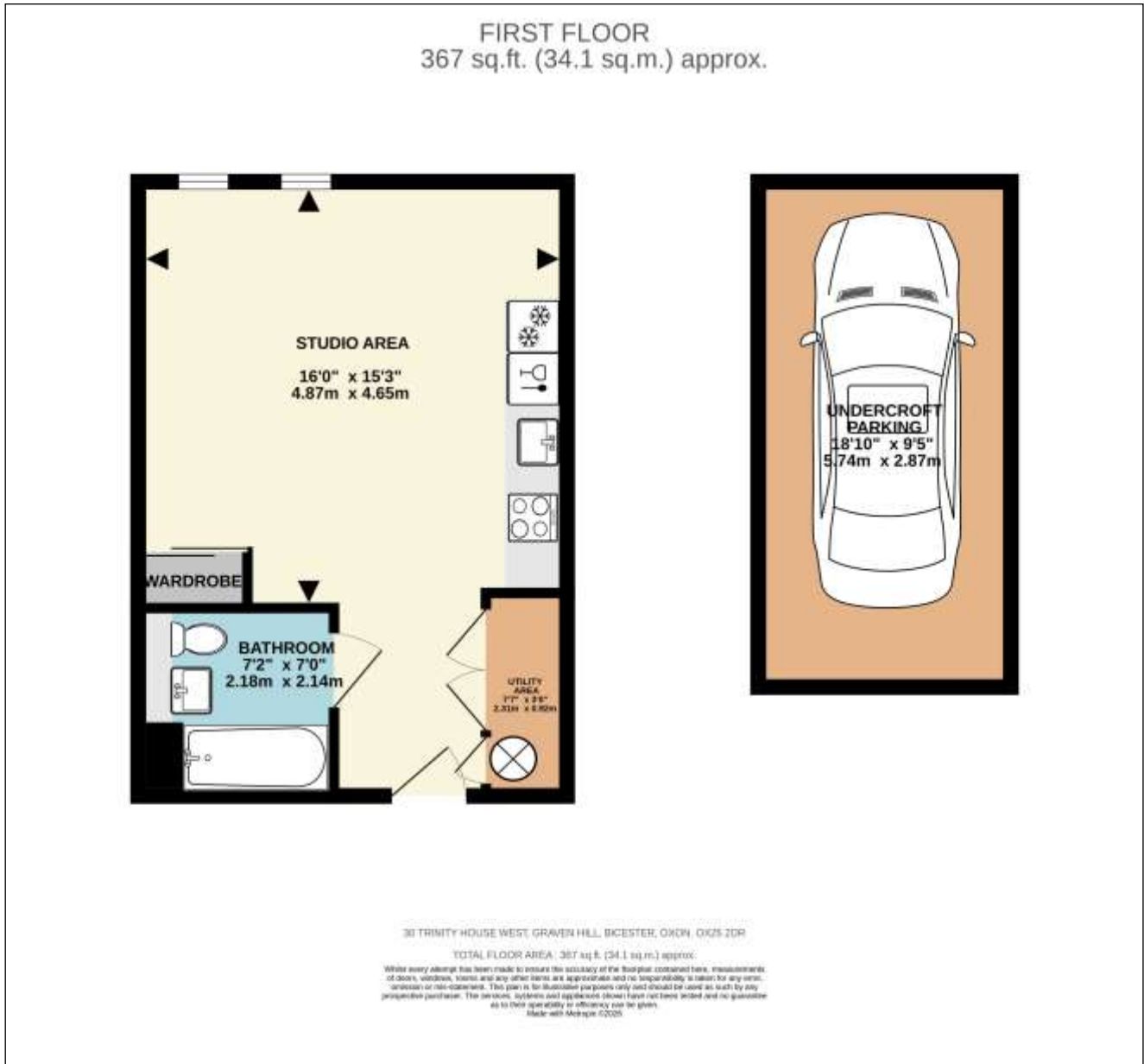

These particulars do not constitute any part of an offer or a contract. Whilst every care has been taken to ensure accuracy, no responsibility for errors or mis-description is accepted. Any intending purchaser must satisfy himself by inspection or otherwise as to the correctness of each of the statements in these particulars. The vendor does not make or give and neither Barton Fleming nor any person in their employment, has authority to make or give any representation or warranty whatsoever in relation to this property. Land Registry Plans are provided as guidance only and while LRP documents are generated from what is registered at the point at when the plans are downloaded for use in these particulars they are not guaranteed to represent the property title at any given moment. Buyers should satisfy themselves through their solicitor as to the accuracy of the land registration at any given moment.