



**POOLE  
TOWNSEND**

# Green View Flats, Kendal, LA9 4QS

£130,000

1 1 1



- Stone Built Ground Floor Flat • Double Bedroom
- Spacious Well Presented Accommodation
- Excellent Transport Links
- Desirable Location
- Tenure: Leasehold
- Close to Town Centre
- No Chain
- On The Edge Of Kendal Green
- Council Tax Band: A



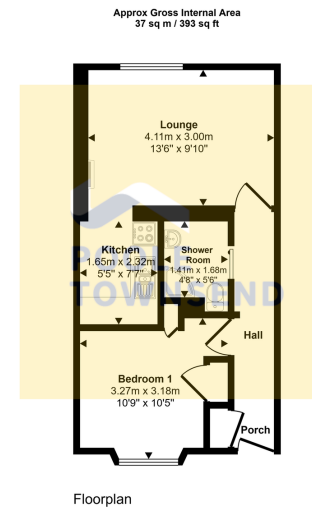

This floorplan is only for illustrative purposes and is not to scale. Measurements of rooms, doors, windows, and any items are approximate and no responsibility is taken for any error, omission or mis-statement. Icons of items such as bathroom suites are representations only and may not look like the real items. Made with Made Snappy 360.

Enjoying a highly desirable location just outside Kendal town centre and on the edge of Kendal Green, this attractive stone-built ground floor flat offers spacious and well-presented accommodation, available with no onward chain. Naturally bright and airy throughout, the property features a welcoming lounge/diner with a gas fire and open access into a fitted kitchen, creating a seamless living space. There is also a comfortable double bedroom with built-in wardrobes and a modern shower room. Perfectly positioned for easy access to town centre amenities and excellent transport links, this appealing home is one that must be viewed to be fully appreciated.

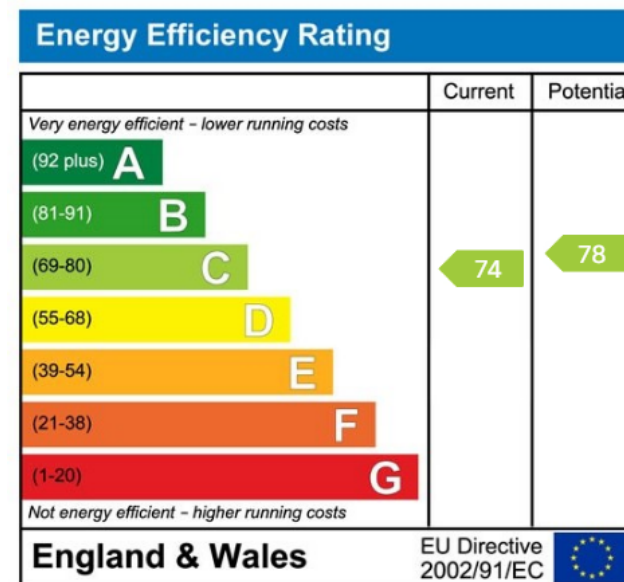

Visit us at  
[www.pooletownsend.co.uk](http://www.pooletownsend.co.uk)  
[enquiries@pooletownsend.co.uk](mailto:enquiries@pooletownsend.co.uk)

We are open  
 Monday – Friday 9.00 – 5.00  
 Saturday 9.00 – 1.00

Barrow 01229 811811  
 Ulverston 01229 588111  
 Grange 015395 33316  
 Kendal 01539 734455  
 Milnthorpe 015395 62044