



20 Finchley Lane

, London, NW4 1DL

£3,000 Per month



3



2



1



B

## Floor Plan

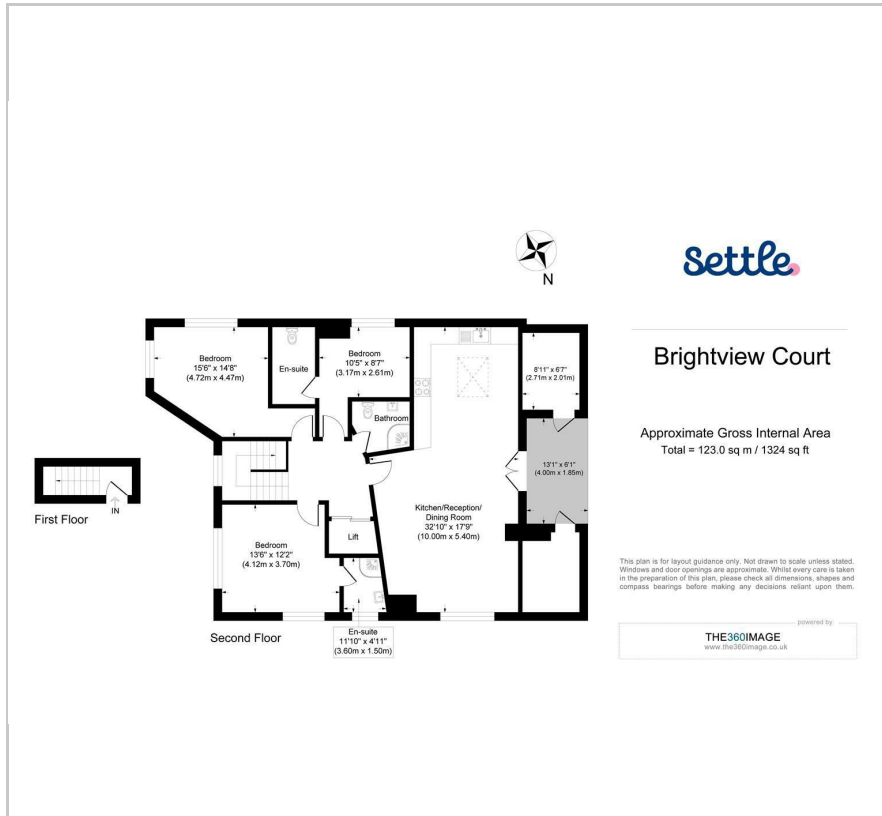

## Area Map

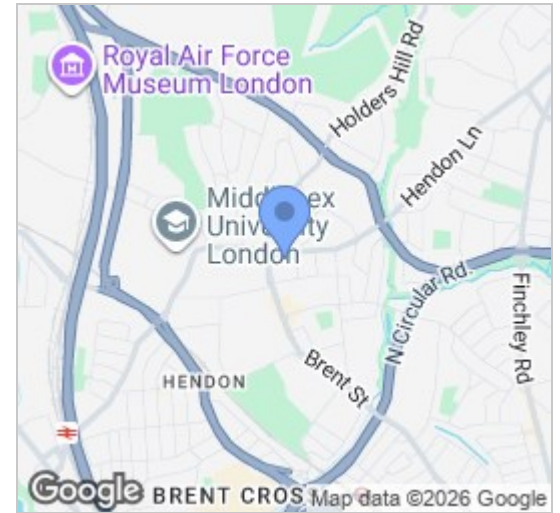

## Energy Efficiency Graph

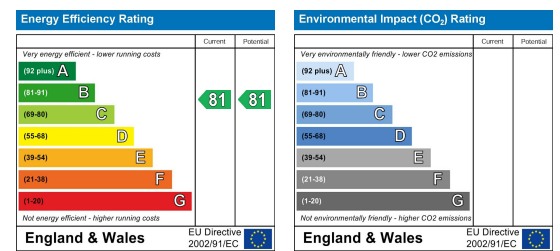

## Viewing

Please contact our Settle Office on 0208 124 2522 if you wish to arrange a viewing appointment for this property or require further information.

- Three Bedroom Flat
- Well Presented
- Spacious Rooms
- Finished/Flexible
- EPC Rating B
- Split Level
- Private Terrace
- Available Early April
- Council Tax Band G
- 1412 Sq Ft - 131.2 Sq M

Immaculate Three-Bedroom Flat with Roof Terrace and Allocated Parking.

Located in a well-presented development, this bright and modern three-bedroom flat offers comfortable living in a convenient setting. The property boasts an open-plan kitchen and living area, ideal for both everyday living and entertaining, with direct access to a private balcony—perfect for enjoying some outdoor space. All bedrooms are well-sized, and the flat has been maintained to a high standard throughout. Additional benefits include allocated and secure parking and secure fob entry with intercom, ample storage and lift access.



These particulars, whilst believed to be accurate are set out as a general outline only for guidance and do not constitute any part of an offer or contract. Intending purchasers should not rely on them as statements of representation of fact, but must satisfy themselves by inspection or otherwise as to their accuracy. No person in this firm's employment has the authority to make or give any representation or warranty in respect of the property.