

for sale

£40,000



Chapel Street Student Accommodation Chapel Street Luton LU1 5DA

This purpose built studio apartment located in Chapel Street, within 0.3 miles of Luton town centre and railway station. The property was constructed in 2013

Chapel Street Student Accommodation Chapel Street Luton LU1 5DA

Studio Flat

Fitted with low level wc. Wash hand basin. Shower cubicle.

Entrance

Outside

Communal Entrance Door

Entrance Hall

Door to front. Radiator.

Open Plan Kitchen / Lounge

Lounge

Double glazed window to rear. Radiator.

Kitchen

Fitted with wall and base units. Stainless steel sink drainer. Work surfaces. Partly tiled. Electric oven and hob. Extractor fan. Space for fridge freezer.

Bathroom







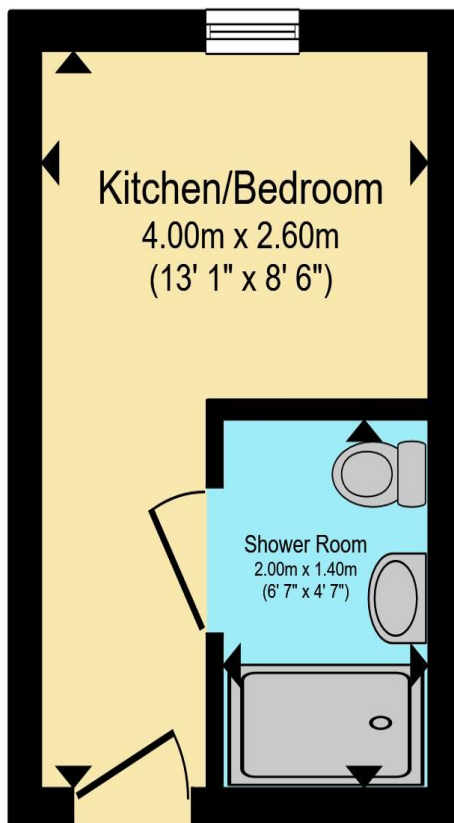

Total floor area 10.4 m² (112 sq.ft.) approx

This floor plan is for illustrative purposes only. It is not drawn to scale. Any measurements, floor areas (including any total floor area), openings and orientation are approximate. No details are guaranteed, they cannot be relied upon for any purpose and they do not form part of any agreement. No liability is taken for any error, omission or misstatement. A party must rely upon its own inspection(s). Powered by www.propertybox.io

Connells

To view this property please contact Connells on

T 01582 450 999
E luton@connells.co.uk

83-83A George Street
 LUTON LU1 2AT

Property Ref: LUT317912 - 0002

Tenure:Leasehold EPC Rating: C

Council Tax Band: A Service Charge: 250.00

Ground Rent: 250.00

view this property online connells.co.uk/Property/LUT317912

This is a Leasehold property with details as follows; Term of Lease 250 years from 01 May 2014. Should you require further information please contact the branch. Please Note additional fees could be incurred for items such as Leasehold packs.

1. MONEY LAUNDERING REGULATIONS Intending purchasers will be asked to produce identification documentation at a later stage and we would ask for your co-operation in order that there will be no delay in agreeing the sale. 2. These particulars do not constitute part or all of an offer or contract. 3. The measurements indicated are supplied for guidance only and as such must be considered incorrect. Potential buyers are advised to recheck measurements before committing to any expense. 4. We have not tested any apparatus, equipment, fixtures, fittings or services and it is in the buyers interest to check the working condition of any appliances.

Connells Residential is registered in England and Wales under company number 1489613, Registered Office is Cumbria House, 16-20 Hockliffe Street, Leighton Buzzard, Bedfordshire, LU7 1GN. VAT Registration Number is 500 2481 05.

see all our properties at www.connells.co.uk | www.rightmove.co.uk | www.zoopla.co.uk