

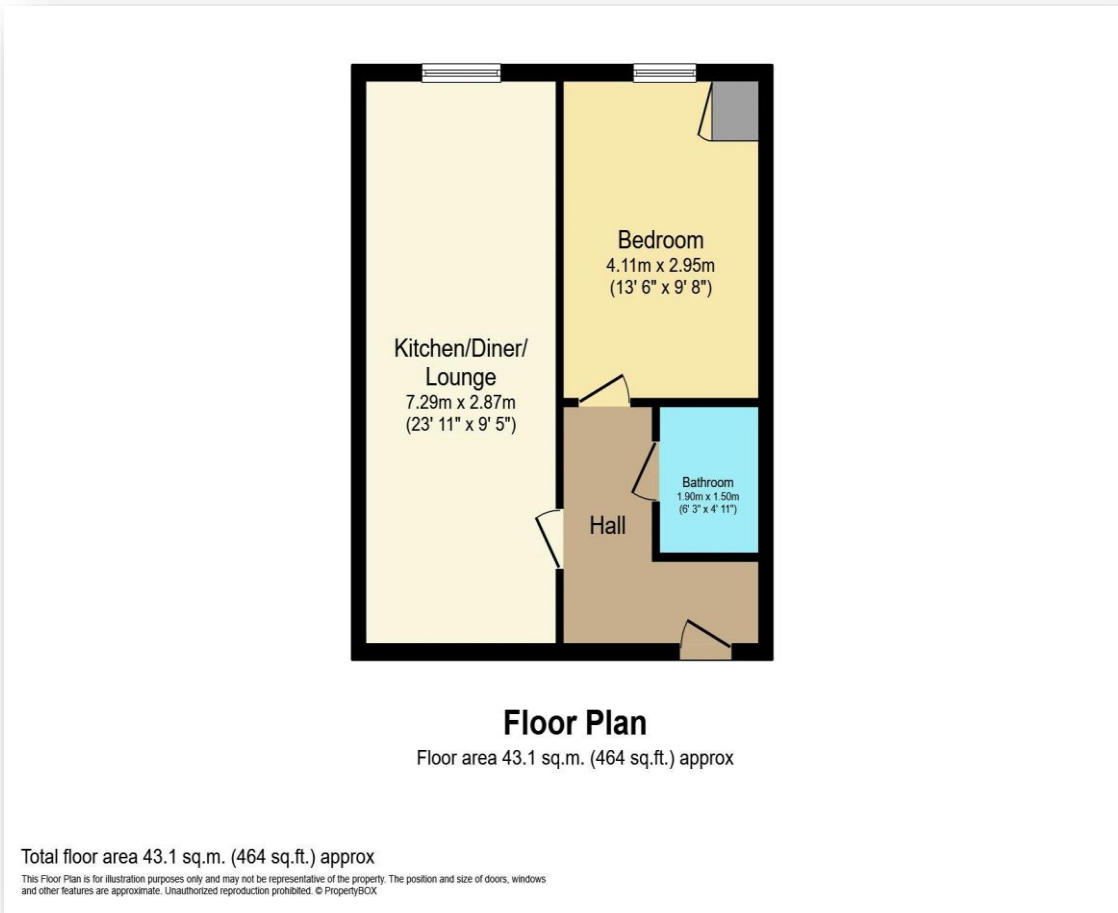

**6 Coleridge Court Royston SG8 5GU**  
**Bedrooms: 1 Bathroom: 1**  
**Monthly Rental Of £875**

- AVAILABLE EARLY JULY
- MODERN HIGH GLOSS KITCHEN
- INTEGRATED APPLIANCES
- SPACIOUS OPEN PLAN LIVING SPACE
- ALLOCATED PARKING SPACE
- EXCELLENT ROAD LINKS
- CLOSE TO AMENITIES
- NO PETS





EPC Rating: B

Tenure: Leasehold

Term Remaining: n/a

## Reserve This Property

A holding fee equivalent to one weeks rent is payable prior to the commencement of the referencing process. This will then be used towards your first months rent once suitable references have been obtained.

Please be advised that this will be retained by ten property agents should you fail the required right to rent checks, change your mind, delay the referencing process in excess of 15 days or you fail referencing due to inaccurate / misleading information being given as part of the application.

A dilapidations deposit equivalent to five weeks rent is payable prior to moving into the property. Should the tenant(s) request an amendment to the existing tenancy, an administration fee of £50 (including VAT) will be payable to the agent. Our Client Money Protection is provided by Propertymark.