



Edenbrook Place, Blindley Heath, Lingfield, RH7 6AT

Guide Price £695,000

🛏️ 4 🚿 3 🚗 2



- Substantial Family Home
- Corner Plot Overlooking 2 Acres Communal Grounds
- 3 Bathrooms
- Landscaped Gardens
- Garden Room Currently Set Up As A Bar
- Gated Development
- 4 Double Bedrooms
- Updated Kitchen
- Garage In Block with Further Off St Parking
- Circa 2100sqft of Living Space



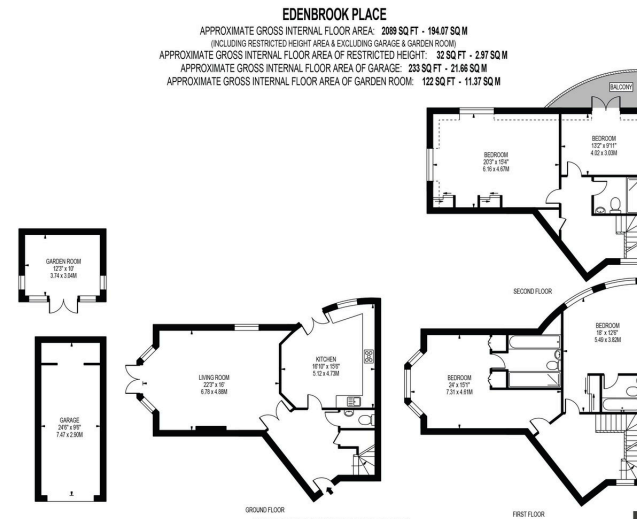

THIS FLOOR PLAN SHOULD BE USED AS A GENERAL OUTLINE FOR GUIDANCE ONLY AND DOES NOT CONSTITUTE IN WHOLE OR IN PART AN OFFER OR CONTRACT. ANY INTENDING PURCHASER OR LESSEE SHOULD SATISFY THEMSELVES BY INSPECTION, SEARCHES, ENQUERIES AND FULL SURVEY AS TO THE CORRECTNESS OF EACH STATEMENT. ANY AREAS, MEASUREMENTS OR DISTANCES QUOTED ARE APPROXIMATE AND SHOULD NOT BE USED TO VALUE A PROPERTY OR BE THE BASIS OF ANY SALE OR LET.



Beautifully updated and stylishly presented, this contemporary four-bedroom townhouse at 12 Edenbrook Place is set within a sought-after gated development, enjoying the finest views over approximately two acres of communal grounds. Enhanced by the current owners with new flooring, an updated kitchen, a landscaped garden, and a converted garden room/bar, the property offers versatile, turnkey living across three spacious floors with the addition of a garage and 2 parking spaces.

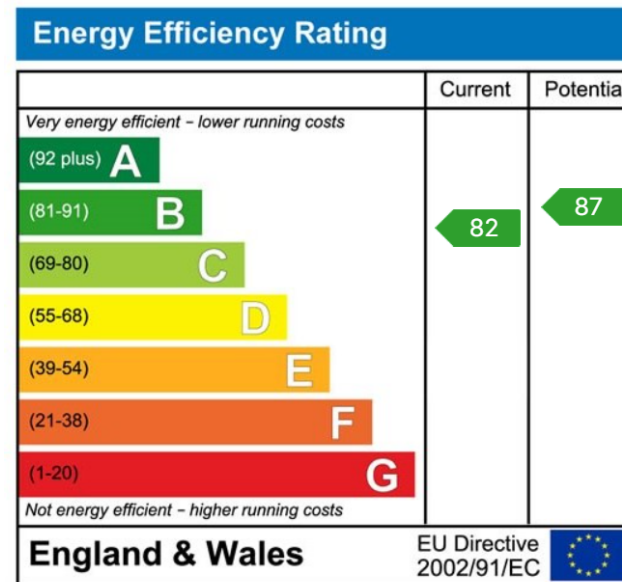

DISCLAIMER. PROPERTY MISDESCRIPTIONS. Whilst every attempt has been made to ensure accuracy of the property details, no responsibility is taken for error, omission or mis-statement. The Agent has not yet tested any apparatus, equipment, fixtures and fittings or services and so cannot verify that they are in working order or fit for the purpose. A buyer is advised to obtain verification from their Solicitor or Surveyor. References to the Tenure of a property are based on information supplied by the Seller. The agent has not had sight of the title documents.

