



Guide Price
£300,000

Freehold

2x  1x  1x 

**Oak Corner, Beare
Green, Dorking, Surrey,
RH5**

OVER 60?

Secure this property
for up to **59% less!**

cubitt & west
Helping you move forwards



Main features

- Sought after village location
- Underfloor heating throughout the ground floor
- Private rear garden with patio and parking
- Countryside walks and cycle trails on your doorstep
- Excellent energy efficiency all year round

Accommodation

GROUND FLOOR

Lounge: 11'0 x 7'0 (3.36m x 2.14m)
 Kitchen/Diner: 17'7 x 11'6 (5.36m x 3.51m)

FIRST FLOOR

Landing
 Bedroom 1: 11'5 max x 8'4 (3.48m x 2.54m)
 Bedroom 2: 8'8 x 6'3 (2.64m x 1.91m)
 Bathroom

OUTSIDE

Rear Garden
 Allocated Parking

Ground Floor

Approx. 26.8 sq. metres (288.2 sq. feet)

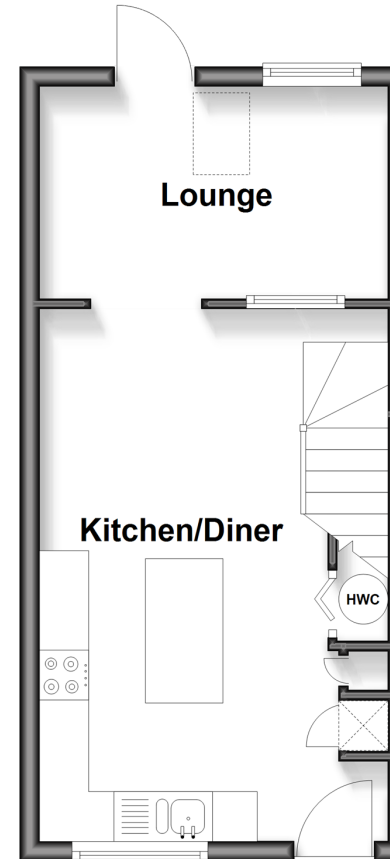

First Floor

Approx. 18.9 sq. metres (203.7 sq. feet)

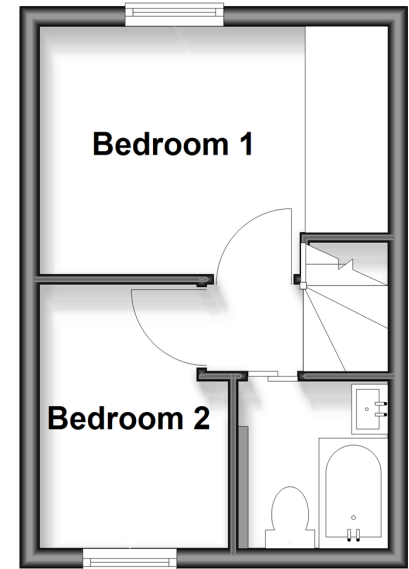

Call Dorking - 01306 883399 ■ cubittandwest.co.uk

- Legal advice should be taken to verify fixtures/fittings, planning, alterations and/or lease details
- Appliances & services are untested, dimensions are approximate and floor plans are not to scale
- Through a Homewise Home For Life Plan people aged 60+ can secure this property for up to 59% less, by purchasing a Lifetime Lease



20511629/20260207/CFE/SB