



28 Hornbeam Road, Bicester, OX26 3XZ

£1,100 PCM - 7th June 2025

- One Bedroom Maisonette
- Kitchen and bathroom fitted late 2024
- Mains electricity and water
- Council Tax Band B
- Available unfurnished with white goods
- Double glazing/Electric Heating fitted late 2024
- Allocated parking
- Good condition throughout
- Small rear garden/Allocated parking
- EPC rating

28 Hornbeam Road, Bicester OX26 3XZ

This one bedroom maisonette is in excellent condition throughout having been renovated late 2024 with new fitted kitchen, bathroom, flooring, heating and new double glazing. Available unfurnished & within easy reach of the rail stations, M40 junction 9 and Oxford. Double bedroom with fitted wardrobes. Living/Dining room through to fully fitted kitchen with electric oven/hob, fridge/freezer and washing machine, Bathroom with shower over. Electric heating. Allocated parking for one car. Enclosed rear garden.



Council Tax Band: B



An unfurnished one bedroom maisonette situated within easy reach of the rail station, M40 and Oxford. Double bedroom with built in wardrobes, Fitted kitchen with cooker, Lounge, Bathroom with shower over. Electric heating. Allocated parking. Rear garden.

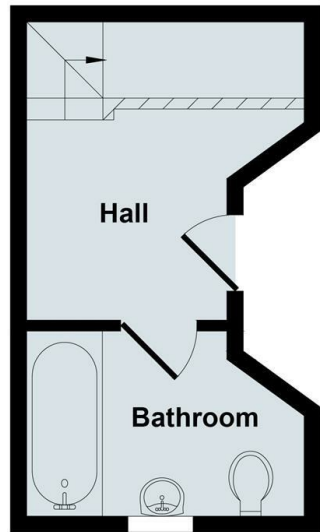

Ground Floor

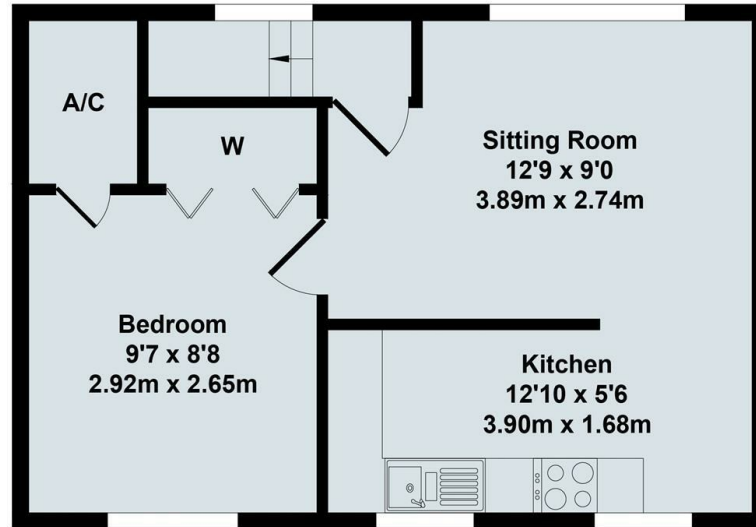

First Floor



Total Approx. Floor Area 432 Sq.Ft. (40.10 Sq.M.)
 All items illustrated on this plan are included in the "Total Approx Floor Area"

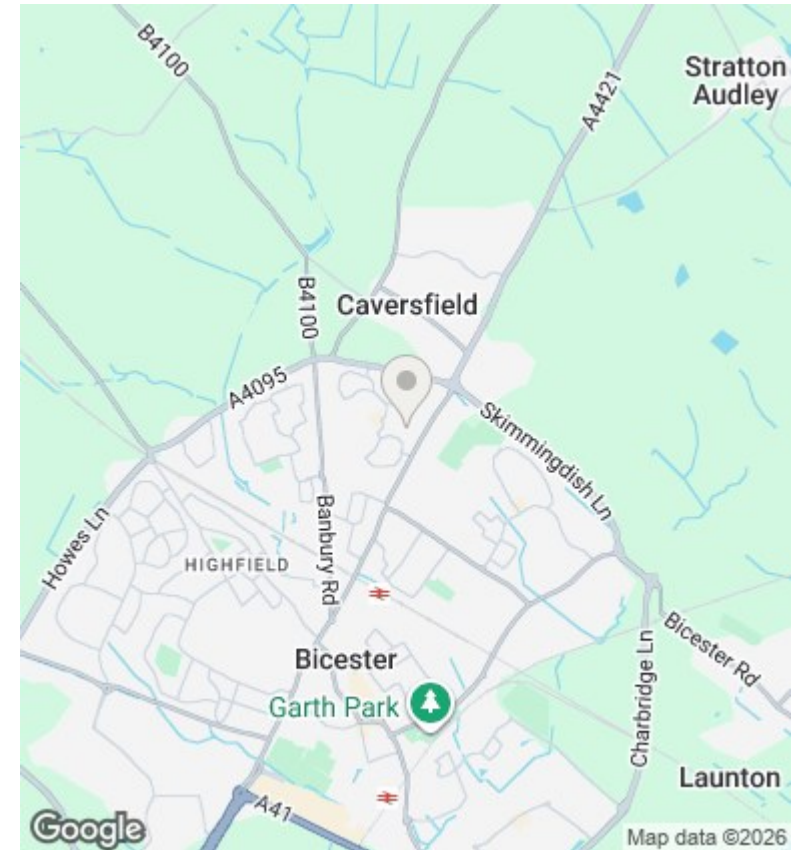

Directions

Viewings

Viewings by arrangement only. Call 01869 226888 to make an appointment.

Council Tax Band

B

Energy Efficiency Rating		
	Current	Potential
<i>Very energy efficient - lower running costs</i>		
(92 plus) A		
(81-91) B		
(69-80) C		72
(55-68) D	63	
(39-54) E		
(21-38) F		
(1-20) G		
<i>Not energy efficient - higher running costs</i>		
England & Wales		EU Directive 2002/91/EC