

Floor 0

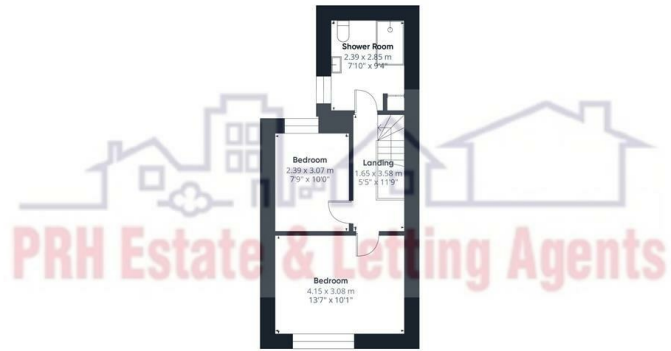

Floor 1

Approximate total area⁽¹⁾
65.9 m²
709 ft²

(1) Excluding balconies and terraces

Calculations reference the RICS IPMS 3C standards. Measurements are approximate and not to scale. This floor plan is intended for illustration only.

GIRAFFE 360



Penzance

Asking Price £275,000



2 Helnoweth Cottages
Penzance
TR18 3BS

Asking Price £275,000

KEY FEATURES

- Terraced Period Property
- Two Bedrooms
- Separate Dining Room
- Available Chain Free
- Front And Rear Gardens
- EPC TBC
- Popular Village Location
- Complete Internal Refurbishment Required

DIRECTIONS

A two bedroom period property situated in the heart of the property village of Gulval. The property now requires complete internal refurbishment and is ready for a new owner to put their stamp on it. Internally the accommodation comprises, living room, separate dining room and kitchen on the ground floor. Whilst on the first floor is a shower room and two bedrooms. Outside there are attractive gardens to the front and rear. The property benefits from partial double glazing and electric heating. Available chain free.

*Freehold
Services, mains water and drainage,
council tax band B*

*Ofcom suggests mobile phone
coverage is good on most networks
and ultrafast broadband is available.
(not connected at present)*

