



Appleby Close, Darlington
Darlington



Offers in Region of £82,500



Appleby Close

Darlington, Darlington

A well-presented second-floor apartment, ideally situated within the highly regarded Eastbourne area of Darlington, conveniently placed within walking distance of the train station, town centre, and a wide range of local amenities.

The property offers spacious and modern accommodation throughout, featuring an open-plan kitchen and living area ideal for both relaxing and entertaining. There are two well-proportioned bedrooms, alongside a contemporary bathroom suite.

Externally, the apartment further benefits from allocated parking, adding to the practicality and convenience of the home.

This attractive apartment would make an ideal purchase for first-time buyers, professionals, or investors seeking a property in a sought-after and well-connected location.

Council Tax band: B

Tenure: Leasehold

- Two Bedroom Upper Floor Flat
- Open Plan Lounge|Diner|Kitchen
- Modern Bathroom
- Close To Local Amenities
- Allocated parking
- Energy Performance Certificate: C



Hallway

Bathroom

Bedroom 1

Bedroom 2

Lounge/Diner

Kitchen





ALLOCATED PARKING

1 Parking Space



Approx. 57.9 sq. metres (623.1 sq. feet)

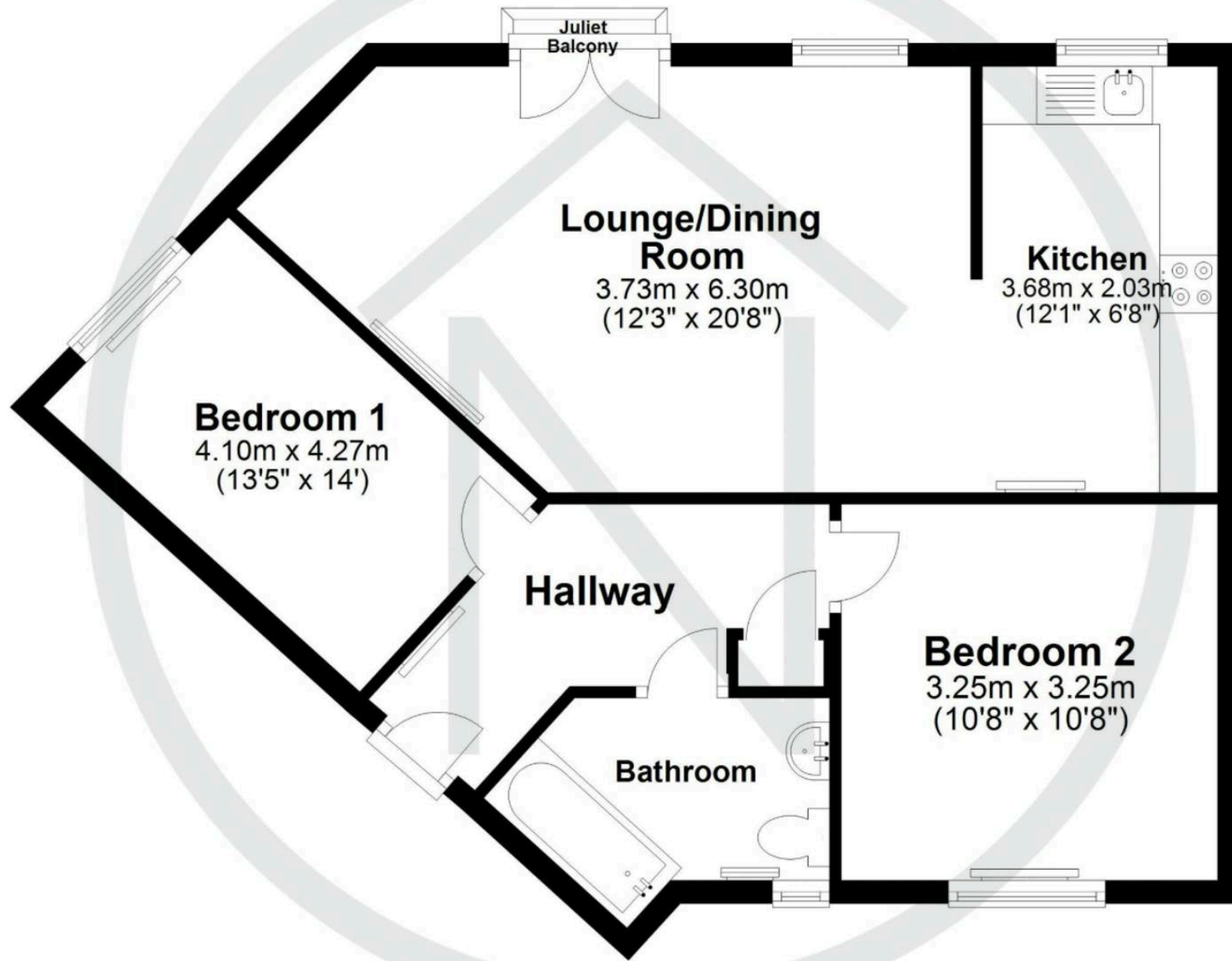

Total area: approx. 57.9 sq. metres (623.1 sq. feet)

floor plan(s) by Northgate© for illustration purpose only.
Plan produced using PlanUp.



Northgate - County Durham

Suite 3, Avenue House, Greenwell Road, Newton Aycliffe - DL5 4DH

01325 728333 • info@northgates.net • www.northgates.co.uk/



These particulars do not constitute, nor constitute part of, an offer or contract. No warranties are provided. Verify details through inspection. Northgate estate agents, nor any person in their employment has any authority to make or give any representation or warranty whatever in the relation to this property. All measurements are approximate.