

SNELLERS

ESTATE AGENTS



Wordsworth Road, TW12

£2,375 PCM

Three bedroom house with large and airy through lounge which leads onto the kitchen with access onto a private garden. Upstairs is a family bathroom, two double bedrooms and a single bedroom. Further benefits include a garage to the rear and ample street parking.

Wordsworth Road is just over a mile from Hampton Village and Hampton Mainline station, moments from Hampton Common and bus routes to Kingston and Heathrow.

- Three Bedrooms
- Newly Refurbished
- Private Garden
- Close to Schools
- Garage
- Ample Parking

SNELLERS

ESTATE AGENTS

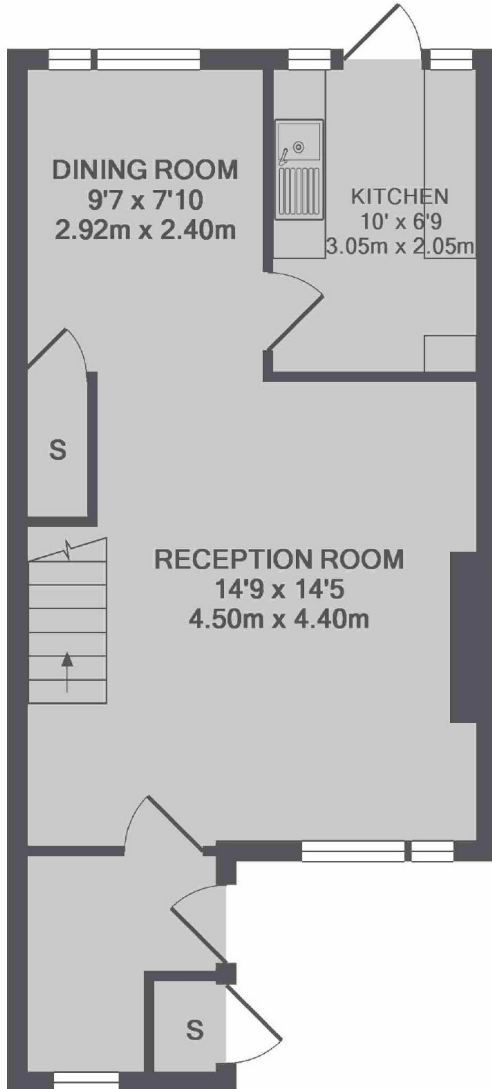

GROUND FLOOR

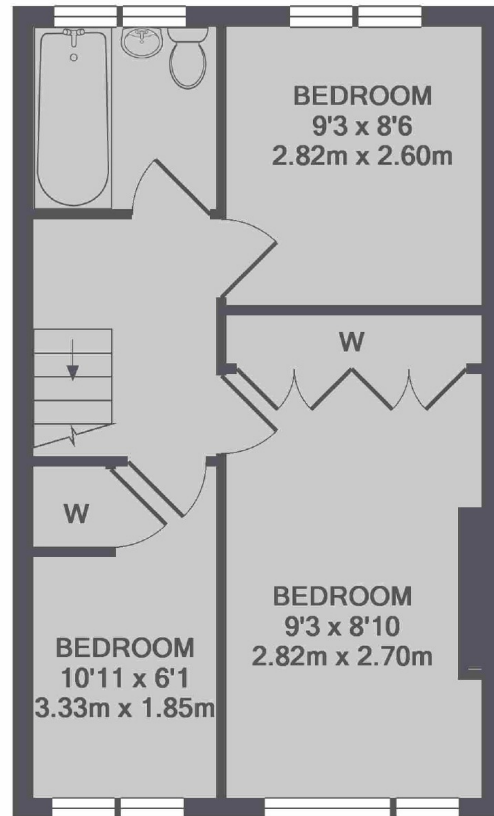

1ST FLOOR

TOTAL APPROX. FLOOR AREA 784 SQ.FT. (72.8 SQ.M.)

Snellers Hampton Hill Lettings
197-201 High Street
Hampton Hill
TW12 1NL
020 8783 3633
hamptonlettings@snellers.co.uk

Energy Rating: C We aim to make our particulars both accurate and reliable. However they are not guaranteed; nor do they form part of an offer or contract. If you require clarification on any points then please contact us, especially if you're traveling some distance to view. Please note that appliances and heating systems have not been tested and therefore no warranties can be given as to their good working order