



**3 Sussex Lodge, Courtlands, Maidenhead SL6 2PS**



**welcome to**

### **3 Sussex Lodge, Courtlands, Maidenhead**

Ideally positioned directly opposite the station, Sussex Lodge is a well-presented two-bedroom first-floor apartment offering convenience, comfort, and excellent connectivity.





## Sussex Lodge, Courtlands, Maidenhead, SL6

Approximate Area = 688 sq ft / 64 sq m

For identification only - Not to scale

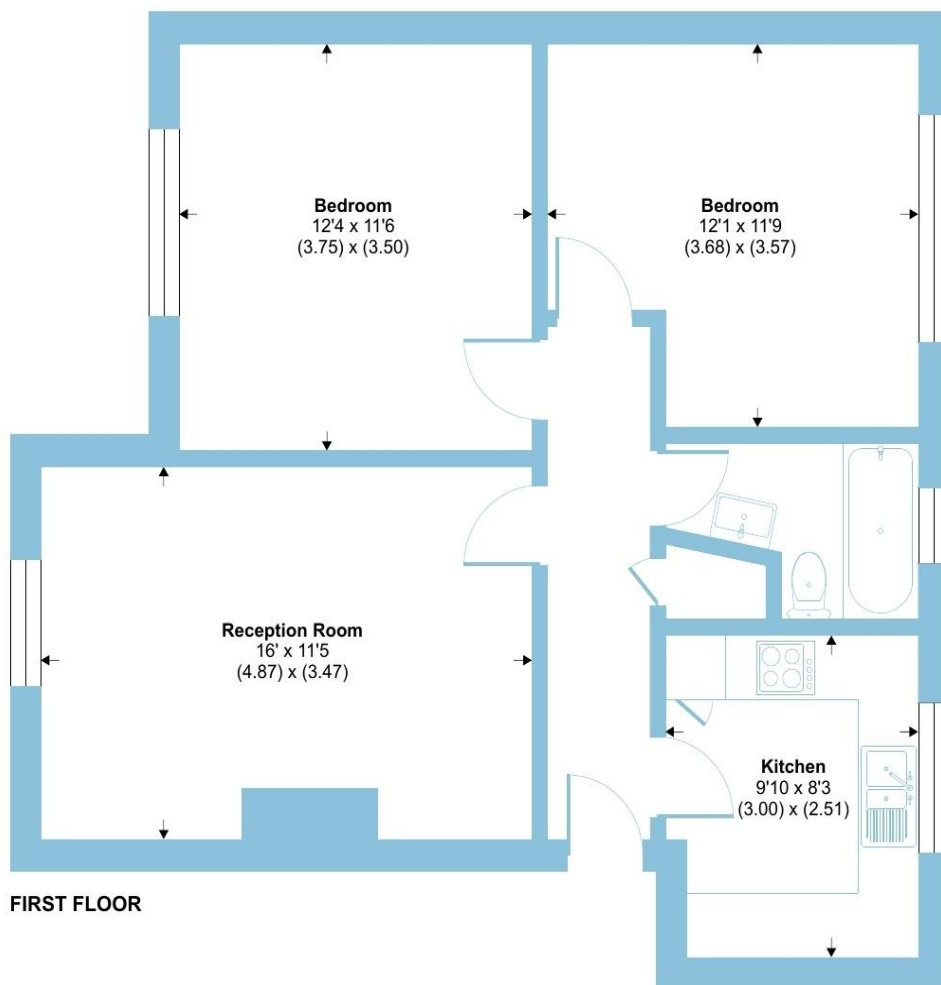

FIRST FLOOR



Floor plan produced in accordance with RICS Property Measurement 2nd Edition, Incorporating International Property Measurement Standards (IPMS2 Residential). © nchecon 2026. Produced for Barnard Marcus. REF: 1410337



The property features a bright and spacious living room, providing an inviting space for both relaxing and entertaining. A well-arranged kitchen offers ample storage and worktop space, making it practical for everyday living. The apartment includes two well-proportioned bedrooms, both benefiting from good natural light and flexible accommodation, suitable for professionals, sharers, or those working from home. A modern bathroom completes the internal layout.

The first-floor position provides a pleasant outlook while maintaining easy access, and the layout is thoughtfully designed to maximise space and functionality throughout.

Sussex Lodge enjoys an exceptional location for commuters, with the station just moments away, offering fast and direct rail services to London and surrounding areas. A wide range of shops, cafés, and amenities are also within easy reach, along with green spaces and riverside walks nearby.

This property represents an excellent opportunity for first-time buyers, downsizers, or investors seeking a well-located apartment with strong rental appeal in a highly convenient setting.

welcome to

## 3 Sussex Lodge, Courtlands

- IDEALLY POSITIONED OPPOSITE THE STATION
- EXCEPTIONAL LOCATION FOR COMMUTERS
- WELL PRESENTED FIRST FLOOR APARTMENT
- TWO WELL-PROPORTIONED BEDROOMS
- WELL-ARRANGED KITCHEN OFFERING AMPLE STORAGE
- MODERN BATHROOM
- BRIGHT & SPACIOUS LIVING ROOM
- IDEAL FOR FIRST TIME BUYERS AND/OR INVESTORS

Tenure: Leasehold EPC Rating: C

Council Tax Band: C Service Charge: 1868.32

Ground Rent: 100.00

This is a Leasehold property with details as follows; Term of Lease 159 years from 24 Jun 2013. Should you require further information please contact the branch. Please Note additional fees could be incurred for items such as Leasehold packs.

# £270,000



Please note the marker reflects the postcode not the actual property

check out more properties at [rogerplatt.co.uk](http://rogerplatt.co.uk)



Property Ref:  
MHD115128 - 0001

1. MONEY LAUNDERING REGULATIONS Intending purchasers will be asked to produce identification documentation at a later stage and we would ask for your co-operation in order that there is no delay in agreeing the sale. 2. These particulars do not constitute part or all of an offer or contract. 3. The measurements indicated are supplied for guidance only and as such must be considered incorrect. Potential buyers are advised to recheck measurements before committing to any expense. 4. We have not tested any apparatus, equipment, fixtures or services and it is in the buyers interest to check the working condition of any appliances. 5. Where an EPC, or a Home Report (Scotland only) is held for this property, it is available for inspection at the branch by appointment. If you require a printed version of a Home Report, you will need to pay a reasonable production charge reflecting printing and other costs. 6. We are not able to offer an opinion either written or verbal on the content of these reports and this must be obtained from your legal representative. 7. Whilst we take care in preparing these reports, a buyer should ensure that his/her legal representative confirms as soon as possible all matters relating to title including the extent and boundaries of the property and other important matters before exchange of contracts.

Roger Platt is a trading name of Sequence (UK) Limited which is registered in England and Wales under company number 4268443, Registered Office is Cumbria House, 16-20 Hockliffe Street, Leighton Buzzard, Bedfordshire, LU7 1GN. VAT Registration Number is 500 2481 05.

  
roger platt



**01628 773333**



[Maidenhead@rogerplatt.co.uk](mailto:Maidenhead@rogerplatt.co.uk)



25-29 Queen Street, MAIDENHEAD, Berkshire,  
SL6 1NB



**[rogerplatt.co.uk](http://rogerplatt.co.uk)**