



Lydford Road, NW2

Leasehold - £475,000

For Sale and offered Chain Free is this well presented two bedroom garden flat offering 613 sq ft of accommodation and converted from this large red brick Edwardian detached house, this is a unique conversion in a great location close to Willesden Green.

The property boasts an open plan kitchen/ reception area with double doors opening out onto a 41ft rear garden, ideal for summer hosting. There are two good sized bedrooms, one of which has built in storage both serviced by a family bathroom.

Lydford Road is conveniently located close to local amenities, cafes, restaurants and the open green spaces of Gladstone Park with a gym and variety of outdoor activities. Lydford Road is also close by to local schools and to excellent transport links including Willesden Green (Mildmay and Lioness zone 2), Brondesbury (Mildmay and Suffragette zone 2) and Kilburn (Jubilee zone 2).

- 2 bedroom chain free garden flat
- Original features
- 41ft garden
- COUNCIL: C

020 8459 1133

enquiries@cameronsstiff.co.uk

cameronsstiff.co.uk







Lydford Road, London, NW2

Approximate Area = 613 sq ft / 57 sq m

For identification only - Not to scale

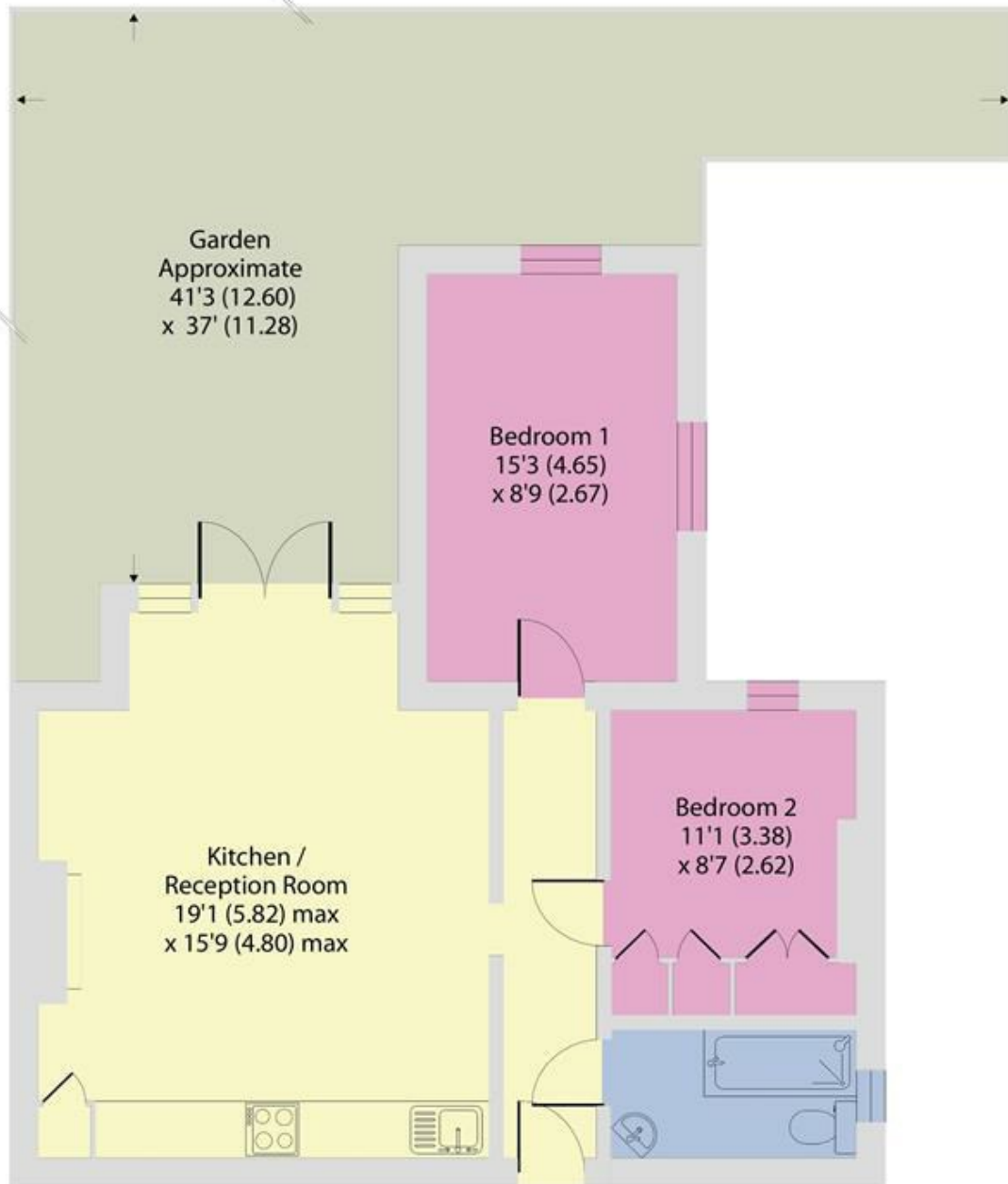

GROUND FLOOR

EPC: D

Ref: 15064095



Floor plan produced in accordance with RICS Property Measurement 2nd Edition, Incorporating International Property Measurement Standards (IPMS2 Residential), © nichecom 2025. Produced for Camerons Stiff & Co. REF: 1320132

