



Hartford Road, Epsom

£329,950



Hartford Road

Epsom

No onward chain. Spacious two-bedroom first-floor maisonette with private garden, garage, double glazing, gas heating, and separate kitchen. Quiet location. Ideal for first-time buyers, downsizers, or investors.

Council Tax band: C

Tenure: Leasehold

EPC Energy Efficiency Rating: C

EPC Environmental Impact Rating: G

- No Onward Chain
- First Floor Maisonette
- Adjacent Garage In Block
- Scope For Modernisation & Personalisation
- Two Generous Bedrooms
- Own Private Enclosed Garden
- Double Glazed
- Gas Radiator Heating
- Shower Room
- Quiet Position



Offered with no onward chain, this well-proportioned two-bedroom first-floor maisonette offers excellent potential to create your own home.

Set in a quiet location, the property benefits from double glazing and gas radiator heating, and features a spacious living room, separate kitchen, two good-sized bedrooms, and a shower room. Further benefits include a private garden and garage in a nearby block. Ideal for first-time buyers, downsizers, or investors. Early viewing is recommended.

Set within a quiet residential part of West Ewell, KT19 9JD is popular for its established surroundings and suburban feel.

The area is well placed for local amenities, schools and everyday transport links, making it ideal for convenient day-to-day living. There is also easy access to the A3, providing straightforward road links into London and beyond.

Top Floor

Approx. 70.2 sq. metres (755.7 sq. feet)

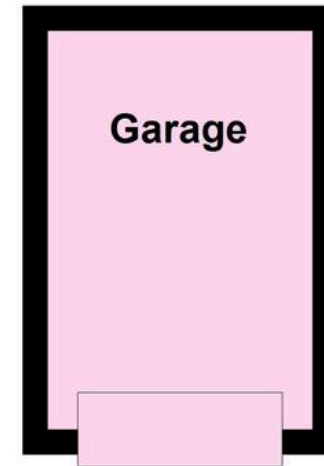
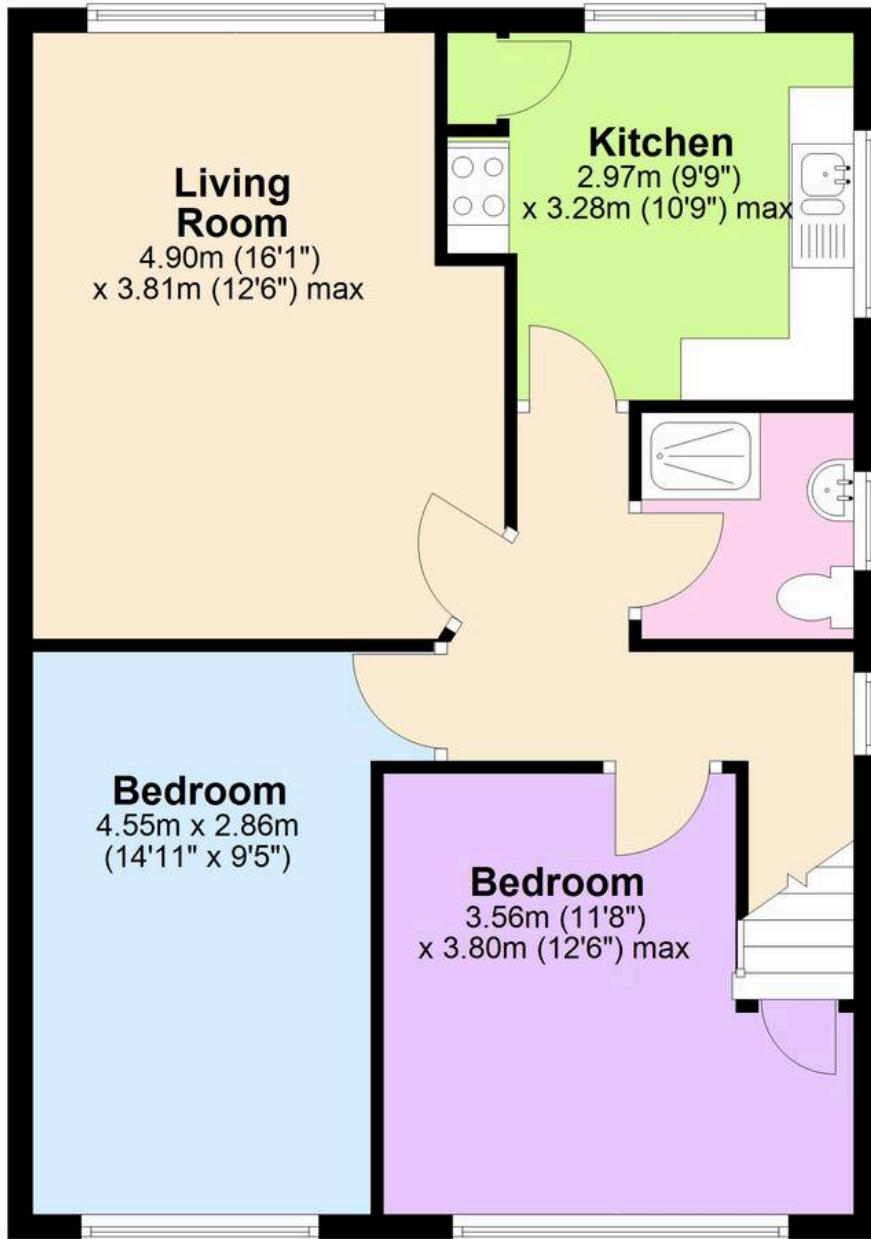

Total area: approx. 70.2 sq. metres (755.7 sq. feet)

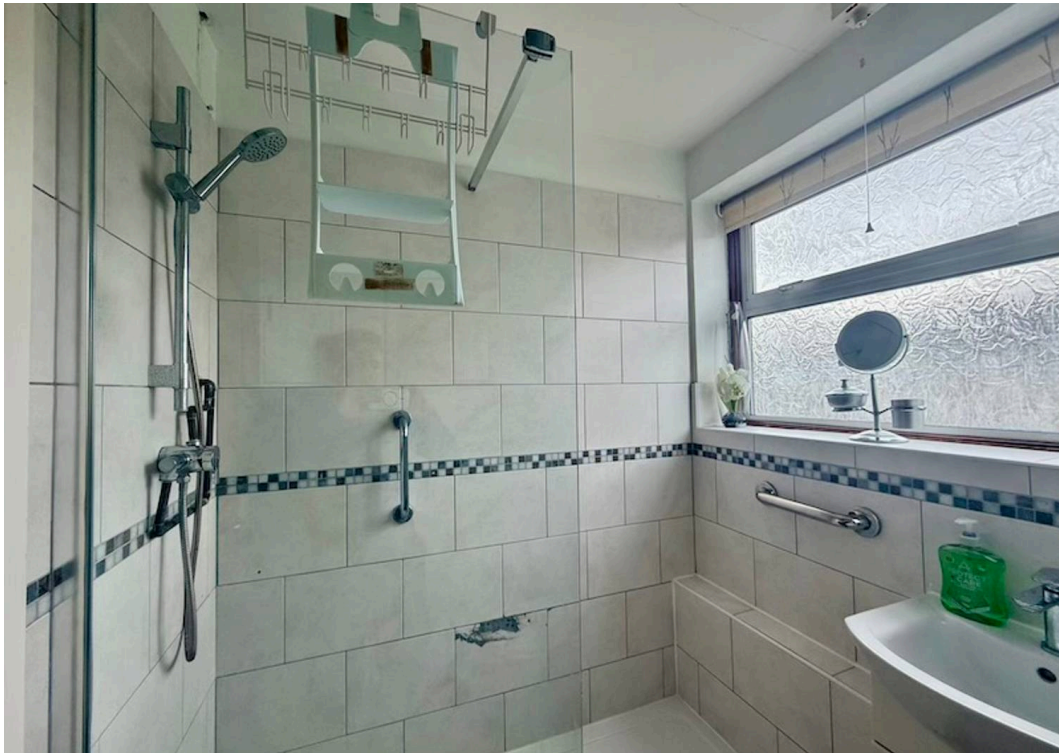



Cairds The Estate Agents

Cairds The Estate Agents, 128-130 High Street - KT19 8BT

01372 743033 • homes@cairds.co.uk • www.cairds.co.uk