



High Dells, Hatfield

£350,000 Freehold

MID TERRACE HOUSE • THREE BEDROOMS • DUAL ASPECT LIVING ROOM • KITCHEN WITH DINING ROOM • MODERN BATHROOM • LARGE REAR GARDEN • CLOSE TO AMENITIES • CHAIN FREE • FREEHOLD • EPC RATING - D

KINGS
SALES LETTINGS MANAGEMENT

**High Dells,
Hatfield, AL10**
Approx. Gross Internal Area *
990 Ft² - 91.97 M²

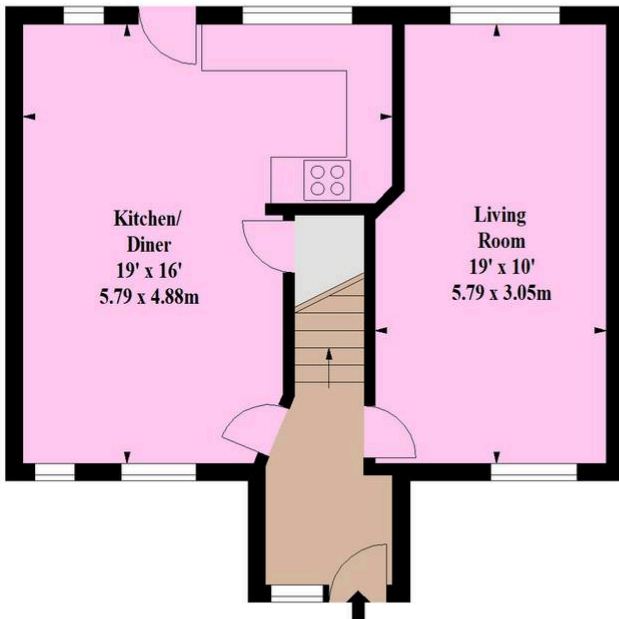

Ground Floor

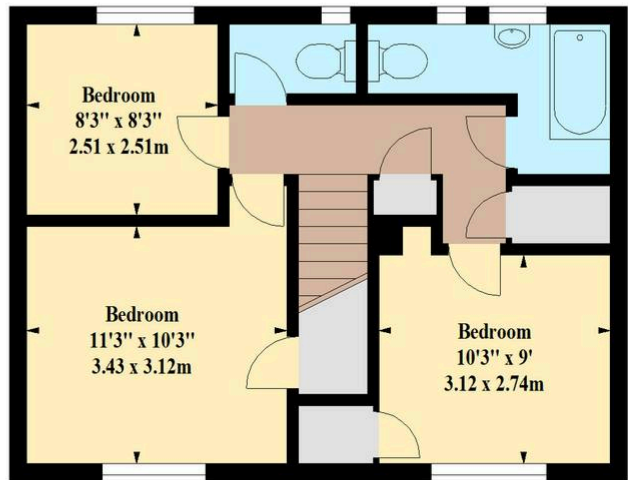

First Floor

Whilst every attempt has been made to ensure the accuracy of the floor plan contained here, measurements of doors, windows, rooms and any other items are approximate and no responsibility is taken for any error, omission or mis-statement. This plan is for illustrative purposes only and should be used as such by any prospective purchaser. The services, systems and appliances shown have not been tested and no guarantee as to their operability or efficiency can be given

