



40 Ganges Road, Milehouse, Plymouth, Devon, PL2 3AZ



# Price £247,500

Lang Town and Country are pleased to offer to the market this 4 bedroom terraced house positioned conveniently in Milehouse, close to Stoke Village and all its amenities, Central Park & Blockhouse Park, Plymouth's Life Centre and the Milehouse Park & Ride.

This well-proportioned home offers a thoughtful layout across three floors, blending practical living space with comfortable accommodation.

On entering the property, you are welcomed into a hallway that leads through to a bright and inviting lounge positioned at the front of the home, featuring a bay window that enhances the sense of space and natural light. To the rear, the dining room provides an ideal setting for both everyday meals and entertaining, with easy access through to the kitchen. The kitchen itself is modern in style and well arranged, offering ample worktop and storage space along with room for a range of white goods, making it both functional and stylish.

The first floor hosts three bedrooms, each offering versatile space suitable for family living, guest accommodation, or home working. A well-appointed bathroom completes this level. Stairs rise to the second floor where a further generously sized bedroom benefits from added privacy with a separate WC, ideal as a principal suite or guest room.

Externally, the property is equally appealing. The frontage is laid with stone chippings, creating a neat and low-maintenance approach.

To the rear, you will find an enclosed garden designed for ease of upkeep, featuring a patio area perfect for outdoor seating and BBQs. There is also the added benefit of off-road parking accessed via a roller door, along with space suitable for a shed, providing useful additional storage.

Overall, this property presents a comfortable and practical home with well-balanced indoor and outdoor spaces, ideal for a range of buyers.

To view this property call Lang Town & Country Estate Agents on **01752 256000**.

[www.langtownandcountry.com](http://www.langtownandcountry.com)





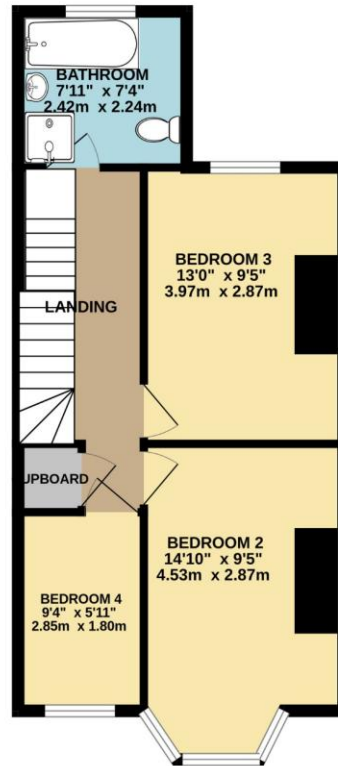
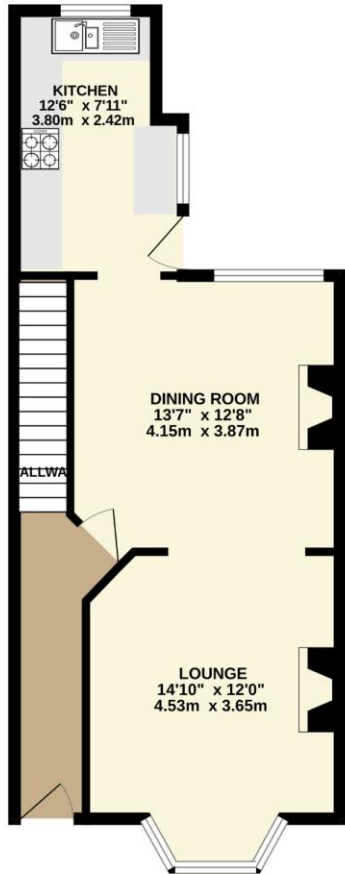

TOTAL FLOOR AREA : 1164 sq.ft. (108.1 sq.m.) approx.

Whilst every attempt has been made to ensure the accuracy of the floorplan contained here, measurements of doors, windows, rooms and any other items are approximate and no responsibility is taken for any error, omission or mis-statement. This plan is for illustrative purposes only and should be used as such by any prospective purchaser. The services, systems and appliances shown have not been tested and no guarantee as to their operability or efficiency can be given.  
Made with Metropix ©2025



Lang Town & Country  
6 Mannamead Road  
Plymouth  
PL4 7AA  
Tel: 01752 256000  
Email: [property@langtownandcountry.com](mailto:property@langtownandcountry.com)  
[www.langtownandcountry.com](http://www.langtownandcountry.com)

Lang Town & Country endeavour to ensure the accuracy of property details produced and displayed, we have not tested any apparatus, equipment, fixtures, fittings or services and so cannot verify that they are connected, in working order or fit for purpose. A buyer must check the availability of any property and make an appointment to view before embarking on any journey to see a property.

