



The Finches, St. Leonards-On-Sea TN38 9LQ

Offers in excess of £220,000



Spacious two bedroom TERRACED HOUSE located in a quiet cul-de-sac with a driveway providing OFF ROAD PARKING. It's located on the Northern outskirts of St. Leonards On Sea within easy reach of local shops, good transport links, the A21 and the historic Town of Battle. The accommodation here is arranged as a BRIGHT LIVING ROOM which spans the rear of the property, measuring 14'5 x 11'9 with access out to the ENCLOSED REAR GARDEN, while the FITTED KITCHEN enjoys a front aspect with ample storage and room for appliances. There are TWO DOUBLE BEDROOMS on the first floor together with a family bathroom where there is a shower over the bath. The rear garden is a particular feature here, it offers a patio space off of the living room making this the perfect spot to DINE AL-FRESCO leading down to an area of lawn and deck. To the front of the property there is a DRIVEWAY providing allocated off road parking for one vehicle. Being sold with NO ONWARD CHAIN this fantastic property would make the PERFECT FIRST TIME HOME or investment.

The Finches

Approximate Gross Internal Floor Area
605 sq. ft / 56.20 sq. m

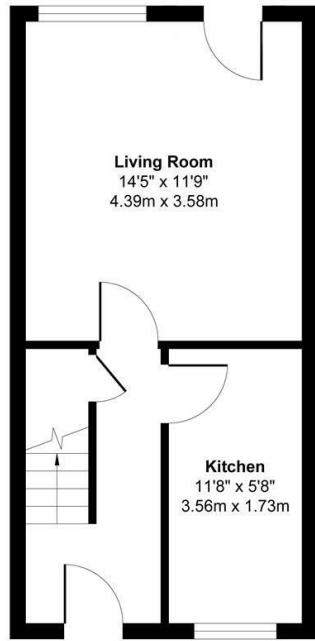

GROUND FLOOR

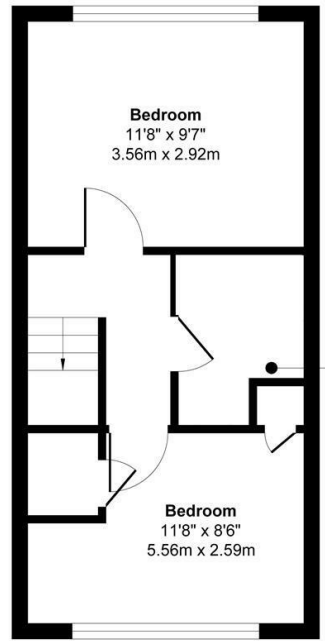

FIRST FLOOR

Bathroom
7'3" x 5'4"
2.21m x 1.63m

