



6 Aysgarth Road, Copthorne, Shrewsbury, Shropshire, SY3 8TW

Monthly Rental Of £1,300

A well-maintained 3-bedroom detached bungalow, located in this popular area of Shrewsbury, within easy access of the town centre. The accommodation includes entrance hall, living room, 2 bedrooms, bathroom, large kitchen/dining room, utility room, 3rd bedroom/snug and en-suite. GCH, DG, large driveway front and rear gardens. **ZJ&B TENANT INFORMATION: (APT) Assured Periodic Tenancies granted subject to contract following satisfactory credit, referencing and right to rent checks. 1 weeks holding fee is applicable to successful applicants. Deposit: 5 weeks' rent and the first month's rent payable in advance. Rent EXCLUDES utilities and council tax. Smoking is prohibited in the Property.**



6 Aysgarth Road, Copthorne, Shrewsbury, Shropshire, SY3 8TW



Council Tax Band C

Monthly Rental Of £1,300 per calendar month

Deposit - £1,500.00
5 weeks rent



This is a copy of the title plan on 27 MAY 2026 at 09:27:48. This copy does not take account of any application made after that time even if still pending in HM Land Registry when this copy was issued.
This copy is not an 'Official Copy' of the title plan. An official copy of the title plan is admissible in evidence in a court to the same extent as the original. A person is entitled to be indemnified by the registrar if he or she suffers loss by reason of a mistake in an official copy, if you want to obtain an official copy, the HM Land Registry web site explains how to do this.
HM Land Registry endeavours to maintain high quality and scale accuracy of title plan images. The quality and accuracy of any print will depend on your printer, your computer and the print settings. This title plan shows the general position, not the exact line, of the boundaries, it may be subject to distortions in scale. Measurements scaled from this plan may not match measurements between the same points on the ground.
This title is dealt with by HM Land Registry, Telford Office.

27060208_08_43 Energy performance certificate (EPC) - Find an energy certificate - GOV.UK

Find an energy certificate (I) English | Cymraeg

Energy performance certificate (EPC)

6, Aysgarth Road SY3 8TW	Energy rating D	Valid until: 10 September 2027
		Certificate number: 8993-7821-5770-3393-4908

Property type: Detached bungalow
Total floor area: 57 square metres

Rules on letting this property

Properties can be let if they have an energy rating from A to E.
You can read [guidance for landlords on the regulations and exemptions](https://www.gov.uk/guidance/energy-performance-certificate-property-minimum-energy-efficiency-standards-guidance) (<https://www.gov.uk/guidance/energy-performance-certificate-property-minimum-energy-efficiency-standards-guidance>).

Energy rating and score

This property's energy rating is D. It has the potential to be C.
[See how to improve this property's energy efficiency.](#)

<https://find-energy-certificate.service.gov.uk/energy-certificate/8993-7821-5770-3393-4908>

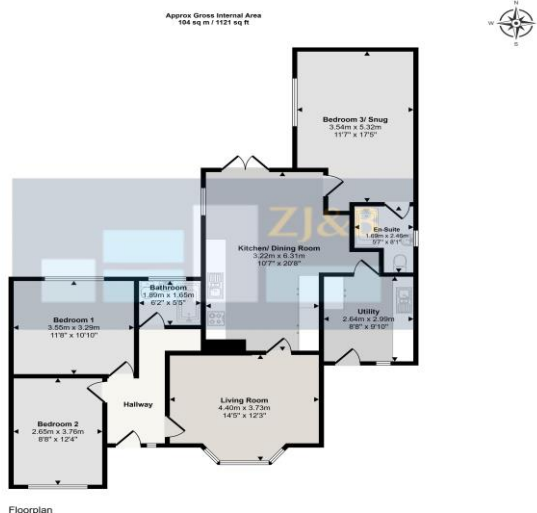

Floor plans for guidance only