



Grosvenor Walk, Hertford SG14 2PQ

Guide price



Taylor Phelps

Estate Agency

Taylor Phelps

Estate Agency

Taylor Phelps are pleased to offer this outstanding, large style two bedroom apartment forming part of this exclusive, recently constructed development in Hertford. This stunning property boasts spacious accommodation throughout featuring a high spec kitchen, extensive lounge / diner and two luxury bathrooms. Externally there is the added benefit of "two car parking" with a carport and an additional, allocated parking space. Hertford itself offers numerous conveniences and amenities, and two train stations serving central London. Available Chain Free



Taylor Phelps  
Estate Agency



Taylor Phelps  
Estate Agency



Taylor Phelps  
Estate Agency



Taylor Phelps  
Estate Agency



Taylor Phelps  
Estate Agency



Taylor Phelps  
Estate Agency



Taylor Phelps  
Estate Agency



Taylor Phelps  
Estate Agency



Taylor Phelps  
Estate Agency

Taylor Phelps  
Estate Agency

Taylor Phelps  
Estate Agency

Taylor Phelps  
Estate Agency



Taylor Phelps  
Estate Agency

# Floor Plan

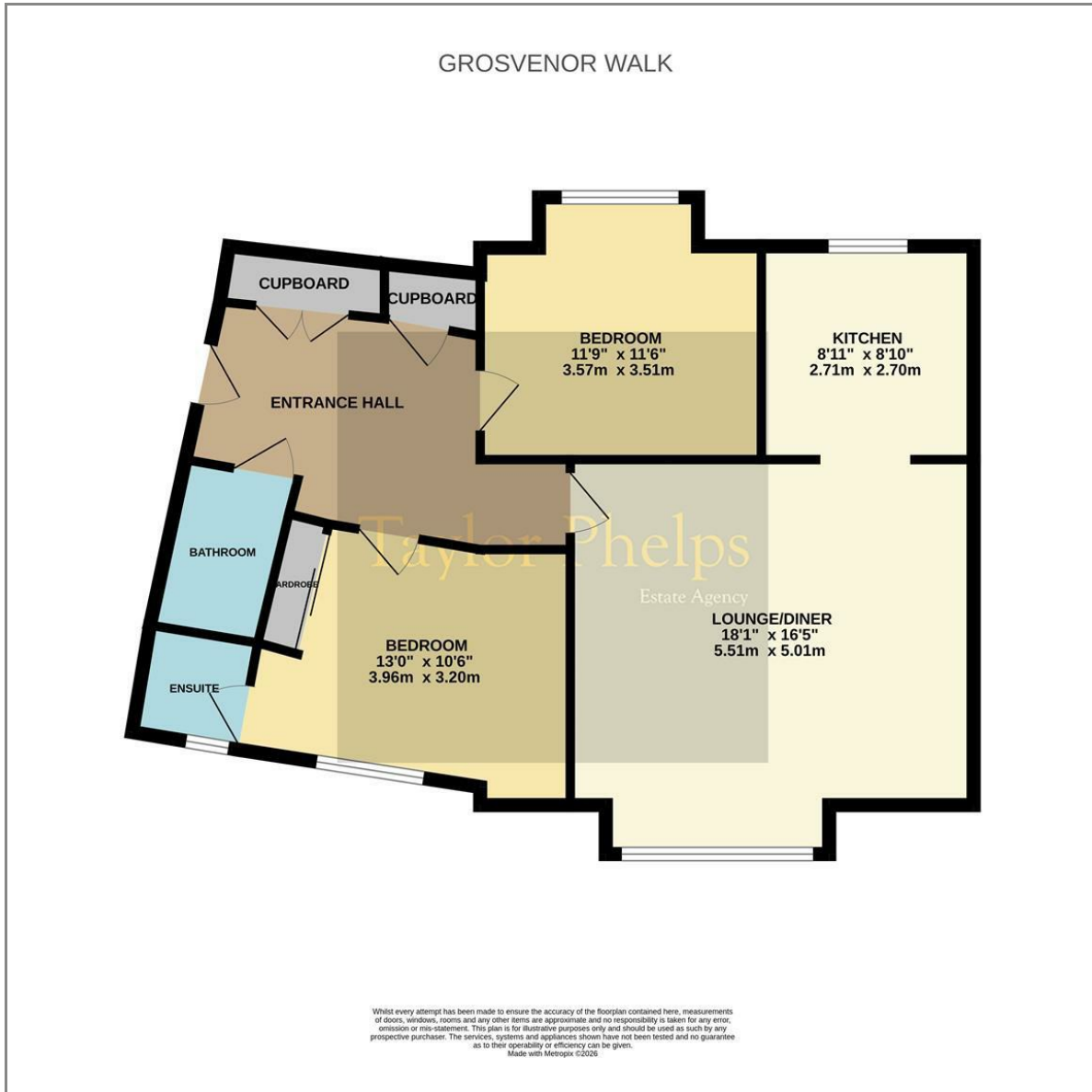

# Area Map

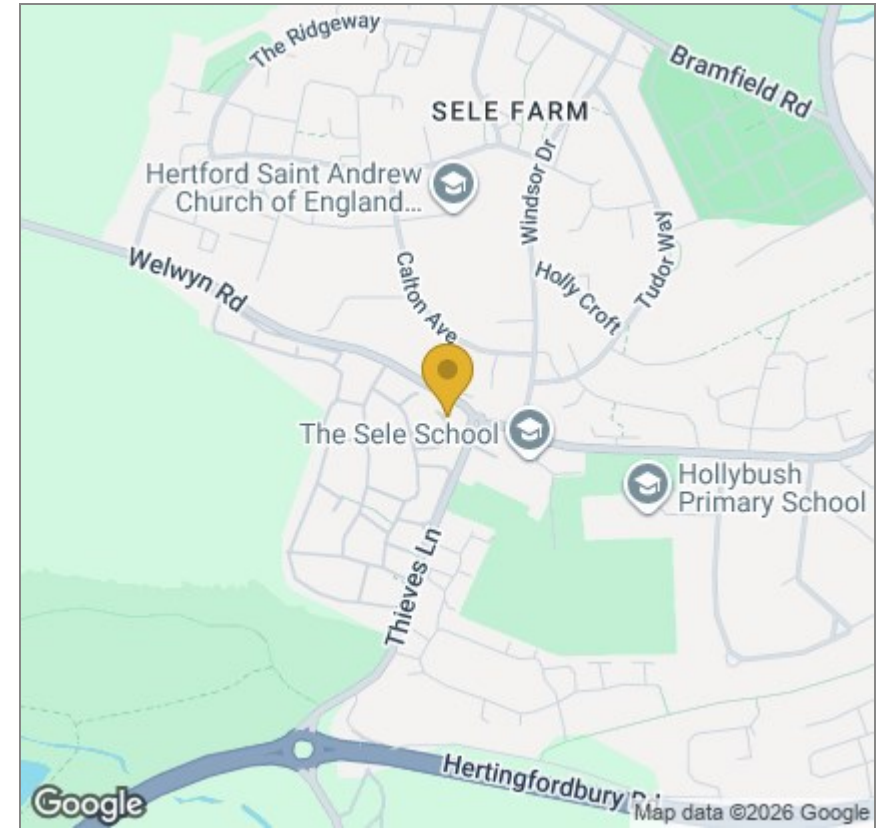

# Energy Efficiency Graph

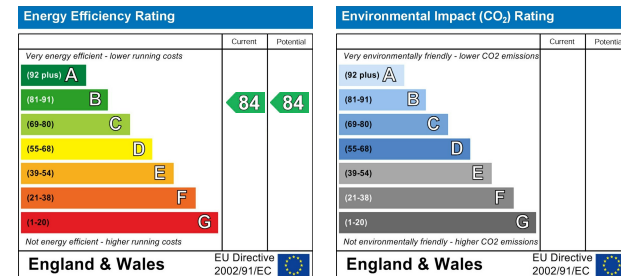

These particulars, whilst believed to be accurate are set out as a general outline only for guidance and do not constitute any part of an offer or contract. Intending purchasers should not rely on them as statements of representation of fact, but must satisfy themselves by inspection or otherwise as to their accuracy. No person in this firm's employment has the authority to make or give any representation or warranty in respect of the property.

01920 459000

hello@taylorphelps.co.uk

5 Frenchs Yard, Amwell End, Ware, Hertfordshire, SG12 9HP

[www.taylorphelps.co.uk](http://www.taylorphelps.co.uk)

