

Coronation Road

SOUTHVILLE

APPROXIMATE FLOOR AREA
116.2 SQM / 1251 SQFT



GROUND FLOOR

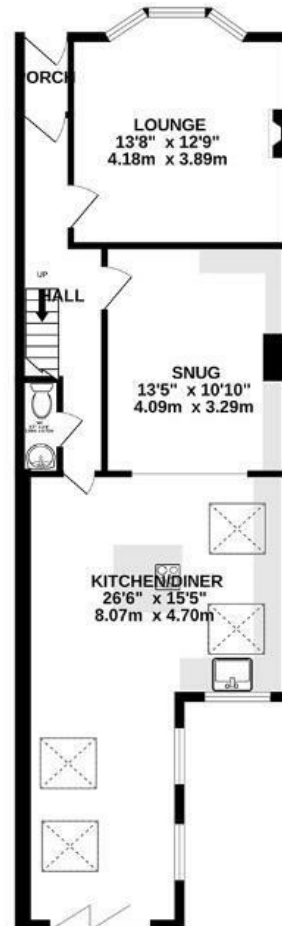

FIRST FLOOR



Boardwalk

Coronation Road

SOUTHVILLE, BRISTOL



£525,000



2 Bedrooms



BS3 1RL



1 Bathrooms

"Cooking in the kitchen with our family sat in the dining area or garden with the bi-folds open is the perfect moment for us. Sitting in the garden in the sun with a glass of wine is also a top highlight - it's remarkably quiet and is a real suntrap."

