



Woburn, W13

£425,000

A first floor, two bedroom, purpose built apartment that has been renovated to a high standard throughout. It features a spacious reception room, a separate modern kitchen, and a balcony. The property benefits from a share of freehold, communal gardens and residence parking. A perfect first time buy.

Located close to Pitshanger and Cleveland Parks with excellent local school, private and state. The award winning Pitshanger Lane high street is a short walk and for the commuter there is easy access to West Ealing and Ealing Broadway Elizabeth line stations.

Features

- Two Bedrooms
- Share of Freehold
- First Floor
- Excellent Condition
- Balcony
- Purpose Built

Woburn, London, W13

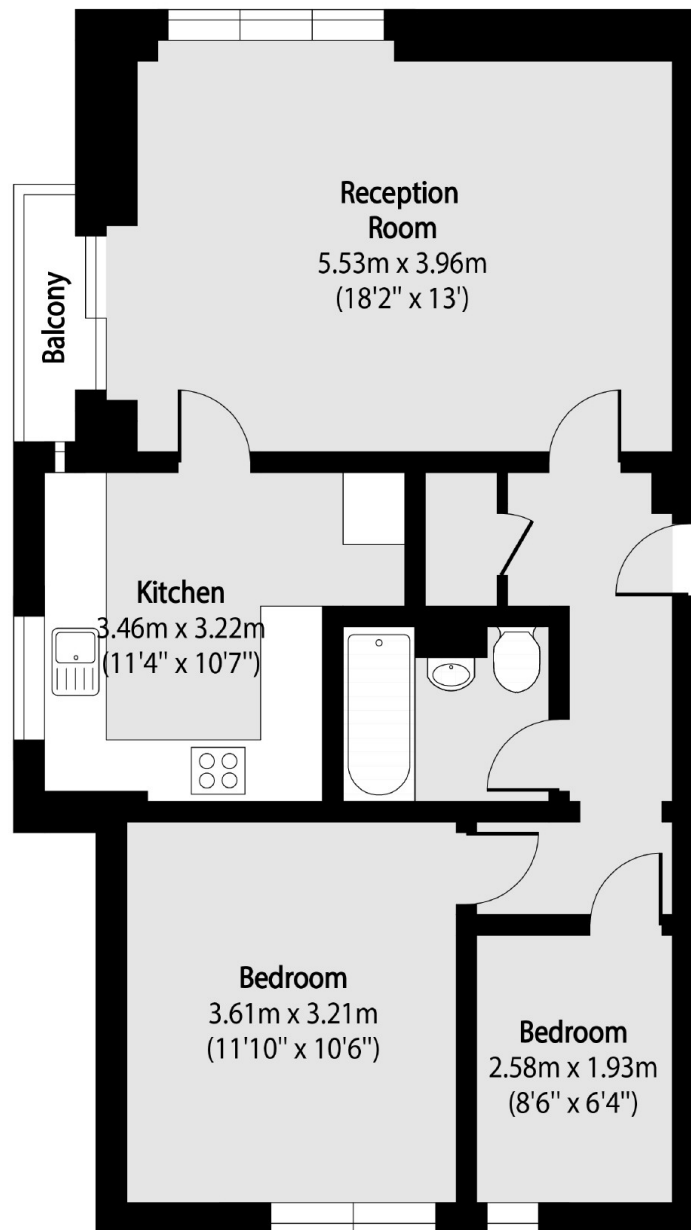

Total area (approx): 62.09 sq m (668 sq. ft)

Balcony total area (approx): 1.20 sq m (13 sq. ft)