

Ferris & Co



Monthly Rental Of £2,500 pcm
Holding deposit equivalent to 1 week's rent on application



17 The Chimes
Maidstone, ME14 4RE

TEL: 01622 737800
Email:
lettings@ferrisandco.net
www.ferrisandco.net

Westwood House
Thurnham Lane
Maidstone, Kent
ME14 4QZ

DESCRIPTION

Stunning town house located in this sought after quiet cul-de-sac, a short distance from Bearsted village green and mainline train station. Featuring open plan living with balcony to rear, four double bedrooms, the Principal having en-suite and walk in dressing room, family bathroom and just finished landscaped low maintenance rear garden with a western aspect. Arranged over 3 floors extending in all to 1420 sq' benefitting from gas central heating, UPVC double glazed windows with fitted French shutter blinds throughout.

The Chimes development is situated within 250 metres of the Village Green with it's selection of shops providing for everyday needs together with the mainline railway station connected to London on the Victoria Line. There is a library and a selection of pubs and restaurants around the village and it is also conveniently located for Bearsted Golf Club. The M20/A20/M25/M26 and M2 are all close by and offer direct vehicular access to London and the Channel Ports.

ON THE GROUND FLOOR

ENTRANCE HALL

Composite entrance door with glazed panels. 1/2 panelled walls. Continuous wood laminate flooring. Under stairs storage cupboard with water cylinder. Pillared radiator. Recessed downlighters. Stairs to first floor. Door to:

INNER HALLWAY

Half height panelled walls. Recessed downlighters. UPVC double glazed door to garden.

PRINCIPAL BEDROOM 12' 5" x 10' 3" (3.78m x 3.12m)

Window to rear with western aspect overlooking the garden. Panelled walls. Pillared radiator. Recessed downlighters. Door to:

WALK IN WARDROBE/DRESSING ROOM 10' 8" x 9' 8" (3.25m x 2.94m)

Extensively fitted with wardrobes and shoe shelving incorporating dressing table and chest of drawers. LED feature lighting with motion sensor. Recessed downlighters and wood laminate flooring.

EN-SUITE SHOWER ROOM 10' 1" x 3' 7" (3.07m x 1.09m)

Recently fitted contemporary luxury suite with matt black furniture, walk in shower with plate glass screen, rainforest shower head and additional hand shower. Recessed display niche. Marble effect fully tiled walls. Countertop wash hand basin with wall mounted mixer tap and storage drawers under. Wall mounted ROCA low level W.C with concealed cistern and display shelf above. Matt black heated towel rail. Recessed downlighters. Matching tiled floor. Extractor fan.

ON THE FIRST FLOOR

LANDING

White timber balustrade. Stairs to second floor. Window to front. Pillared radiator. Recessed downlighters.

LOUNGE/DINER 24' 0" x 12' 0" (7.31m x 3.65m)

Double aspect windows to front and side. Recessed downlighter. Two radiators. Carpet. UPVC double casement doors leading to:

BALCONY

Italian porcelain tiled with plate glass balustrade giving an un interrupted view over the garden. Awning providing shade in the summer evenings. outside wall mounted heater. LED floor lighting.

KITCHEN 9' 2" x 6' 10" (2.79m x 2.08m)

Fitted kitchen with a range of high and low level units with granite working surfaces and unstands. Inset stainless steel

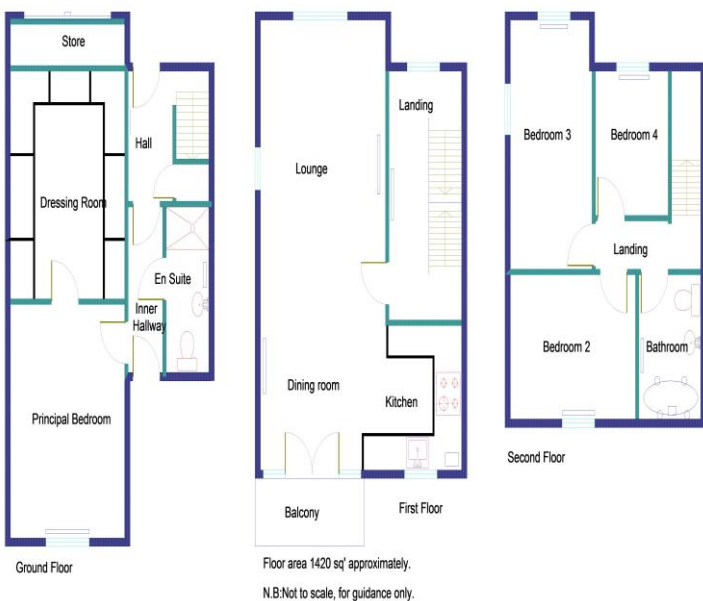

DIRECTIONS

From our Bearsted Office turn right into Ware Street, taking the fourth turning on the left into Bell Lane. The Chimes will be found directly in front of you.

Energy Rating

Most energy efficient - lower running costs

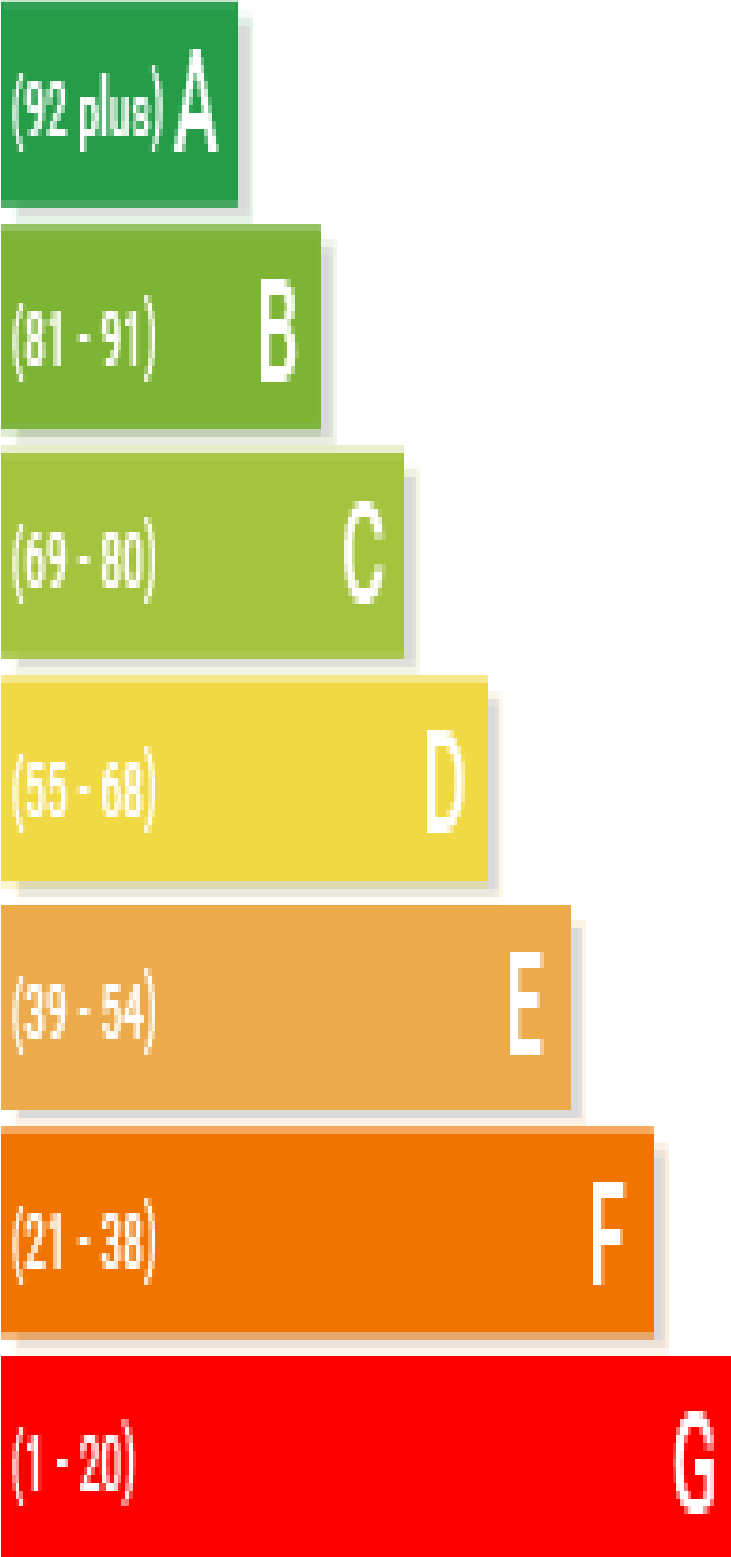

Not energy efficient - higher running costs

CURRENT

POTENTIAL

