



18 Grasmere Road

Kennington, TN24 9BE

Price £315,000

A spacious semi detached house in the popular Kennington area, offered for sale with no onward chain.

The property comprises a sitting room, kitchen, reception room/bedroom, wet room and three first floor bedrooms.

The rear garden is notably generous whilst the property also offers gas central heating, double glazing, driveway and garage.

- EXTENDED SEMI DETACHED HOUSE
- THREE BEDROOMS
- TWO RECEPTION ROOMS
- GENEROUS REAR GARDEN
- GARAGE & DRIVEWAY
- MODERNISATION REQUIRED
- GAS CENTRAL HEATING
- NO ONWARD CHAIN

Viewing

Please contact our Ashford Office on 01233 646411 if you wish to arrange a viewing appointment for this property or require further information.



Floor Plan

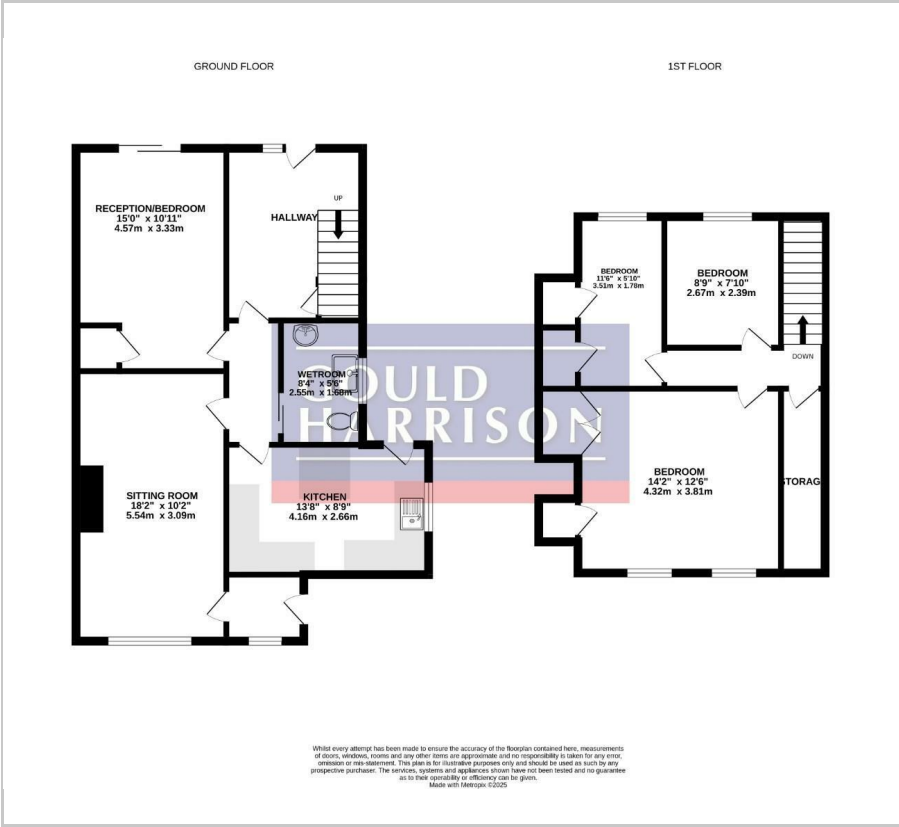

Area Map



Energy Efficiency Graph

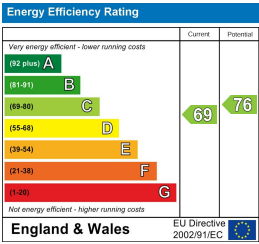

These particulars, whilst believed to be accurate are set out as a general outline only for guidance and do not constitute any part of an offer or contract. Intending purchasers should not rely on them as statements of representation of fact, but must satisfy themselves by inspection or otherwise as to their accuracy. No person in this firms employment has the authority to make or give any representation or warranty in respect of the property.