



RUSSEN & TURNER
www.russenandturner.co.uk

Telford Close, King's Lynn
King's Lynn

Offers Over
£90,000

Bedrooms: 1 | **Bathrooms:** 1 | **Receptions:** 1

Getting onto the property ladder doesn't have to mean compromising. Sometimes, the right home comes along that simply makes sense.

Positioned conveniently close to the Queen Elizabeth Hospital and within easy reach of local amenities, this well-presented ground floor apartment offers an ideal blend of practicality, comfort and affordability. Whether you're buying your first home, looking for a low-maintenance lifestyle, or searching for a smart investment opportunity, this is a property that deserves a closer look.

One of the first things you'll notice is how easy life feels here. Offered to the market with no onward chain, a long lease of approximately 993 years remaining, and ready to move straight into, this is a home designed to remove the usual stresses and complications often associated with moving.

Accessed via a secure intercom entry system, the apartment immediately feels welcoming. Natural light fills the main living space, creating a bright and comfortable room that's easy to picture yourself enjoying. Whether it's a quiet evening on the sofa, catching up with friends over coffee, or simply relaxing after work, the lounge and dining area offers plenty of flexibility without feeling oversized or difficult to maintain.

The kitchen sits neatly alongside, providing generous storage and space for appliances, making it a practical and functional part of everyday life. It's a room that works exactly as it should, allowing you to settle in from day one.

The double bedroom continues the theme of comfortable proportions, offering a peaceful retreat at the end of the day with plenty of room to create a space that feels entirely your own. Completing the accommodation is the modern bathroom, fitted with a contemporary three-piece suite and finished with clean, timeless styling.

Outside, allocated parking provides valuable convenience, while nearby green spaces and play areas offer somewhere to stretch your legs, enjoy some fresh air or simply escape the pace of the day for a while.

Location is often the deciding factor when choosing a home, and this one performs exceptionally well. The Queen Elizabeth Hospital is just moments away, making it particularly appealing for healthcare professionals, while local shops, amenities and transport links are all within easy reach.

Simple, well presented and ready to enjoy, this is the kind of property that offers a straightforward route into homeownership or a hassle-free addition to an investment portfolio.

Move straight in, unpack, and start enjoying your new home from day one.

Tenure: Leasehold

Property Type: Flat

- Ground Floor Flat
- One Bedroom
- No Onward Chain
- Allocated Off-road Parking Space
- Lease Hold - Long Lease Over 900 Years
- Modern Bathroom
- Close to the Queen Elizabeth Hospital
- Ideal First Home
- Open Plan Living Room and Kitchen
- Potential Investment Opportunity

Disclaimer

1. To meet money-laundering regulations, all buyers will need to complete an ID check. We'll ask you to provide the necessary documents, and there's a small fee of £24.50 per client for this service.
2. We do our best to make sure our property details are fair, accurate, and up to date, but they're meant as a general guide only. If there's anything particularly important to you, please get in touch, we'll be happy to look into it further.
3. All measurements are provided as a guide and may not be exact.
4. We haven't tested any of the property's services, equipment, or appliances. We recommend that buyers arrange their own survey or service checks before making a final offer.
5. These details are provided in good faith, but they don't form part of any offer or contract. Buyers should verify any points that are important to them before proceeding.



RUSSEN & TURNER
www.russenandturner.co.uk



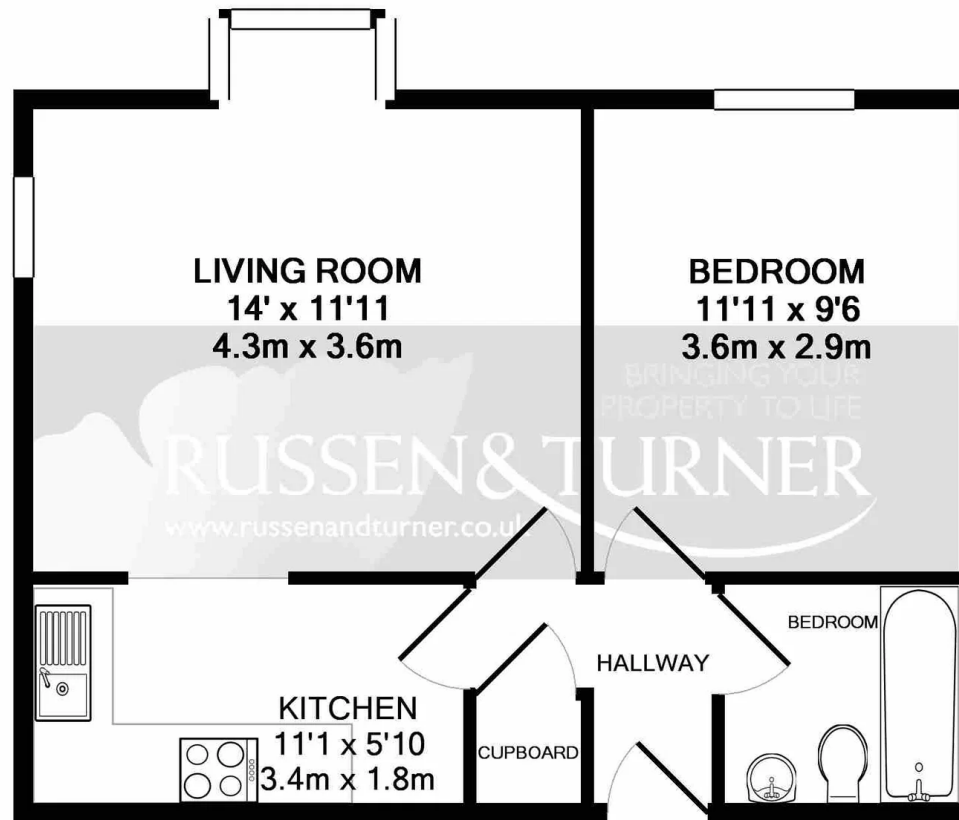

TOTAL APPROX. FLOOR AREA 425 SQ.FT. (39.5 SQ.M.)

Whilst every attempt has been made to ensure the accuracy of the floor plan contained here, measurements of doors, windows, rooms and any other items are approximate and no responsibility is taken for any error, omission, or mis-statement. This plan is for illustrative purposes only and should be used as such by any prospective purchaser. The services, systems and appliances shown have not been tested and no guarantee as to their operability or efficiency can be given

Made with Metropix ©2018