



2
Bedrooms

1
Bathroom



****AVAILABLE NOW**** Welcome to Roman House! The property comprises two good-sized bedrooms, a bright and spacious living area, a fitted kitchen, and a showerroom. The accommodation is presented in excellent order throughout and is available to move into with minimum fuss.

Welcome to Roman House! A well-presented two bedroom apartment situated in Roman House, offering comfortable and convenient living in a popular SO18 location.

The property comprises two good-sized bedrooms, a bright and spacious living area, a fitted kitchen, and a showerroom. The accommodation is presented in excellent order throughout and is available to move into with minimum fuss.

Bitterne Road West places you perfectly for everything Southampton has to offer – Bitterne Village with its array of shops, cafés, and everyday amenities is right on your doorstep, while Southampton City Centre is just a short drive or bus ride away. The area benefits from regular bus services providing easy access across the city, and the M27 is within easy reach for commuters.

An ideal choice for professionals or a couple looking for quality rental accommodation in a well-connected Southampton location.

Approx Gross Internal Area
51 sq m / 553 sq ft

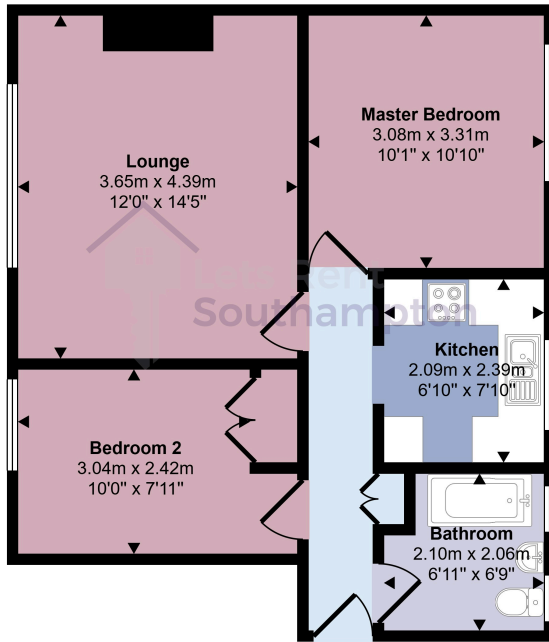

Floorplan

This floorplan is only for illustrative purposes and is not to scale. Measurements of rooms, doors, windows, and any items are approximate and no responsibility is taken for any error, omission or mis-statement. Icons of items such as bathroom suites are representations only and may not look like the real items. Made with Made Snappy 360.

Energy Efficiency Rating		Current	Potential
Very energy efficient - lower running costs			
(92+)	A		
(81-91)	B		
(69-80)	C	75	76
(55-68)	D		
(39-54)	E		
(21-38)	F		
(1-20)	G		
Not energy efficient - higher running costs			
England, Scotland & Wales		EU Directive 2002/91/EC	

Address: Roman House, Bitterne

