



# ASPIRE

— TO MOVE —



## Cleveland Place East, Bath, BA1

Video viewing and physical viewing available on request. A very well presented, basement level, two bedroom fully furnished apartment, available 10th July.

Cleveland Place East is located to east side of Bath city centre and provides excellent access to local amenities. There are several local shops located on Cleveland Place East & West. There is a bus stop at the top of Walcot Street which is 0.2 miles away and Hedgemoor Park is 0.1 miles away.

**£1,750 PCM**

# Cleveland Place East, Bath, BA1

- Two double bedrooms
- Tastefully furnished
- Available July 2026
- Video viewing available
- Close to local amenities
- Council tax band B
- Water bill included in rent
- Holding deposit: 1 weeks worth of rent - £403

Video viewing and physical viewing available on request. A very well presented, basement level, two bedroom fully furnished apartment, available 10th July.

Cleveland Place East is located to east side of Bath city centre and provides excellent access to local amenities. There are several local shops located on Cleveland Place East & West. There is a bus stop at the top of Walcot Street which is 0.2 miles away and Hedgemoor Park is 0.1 miles away.

The property is located on the basement level. The accommodation comprises of a living room with sofa, chair, light, TV stand and TV. There are two double bedrooms, both with double beds, bedside tables, hanging space, desk and chair. The landlord can also provide linen if required. The kitchen has base and wall units, cooker, hob, microwave, kettle and toaster. A fridge freezer is located in the hallway. The bathroom has a shower over bath, WC and sink, the washing machine is also located in the bathroom.

The property is offered fully furnished, however the landlord does have some flexibility to remove some items. Students considered. Available 10th July. Please note the water bill is included in the rent.

Council tax band B: £1808.54

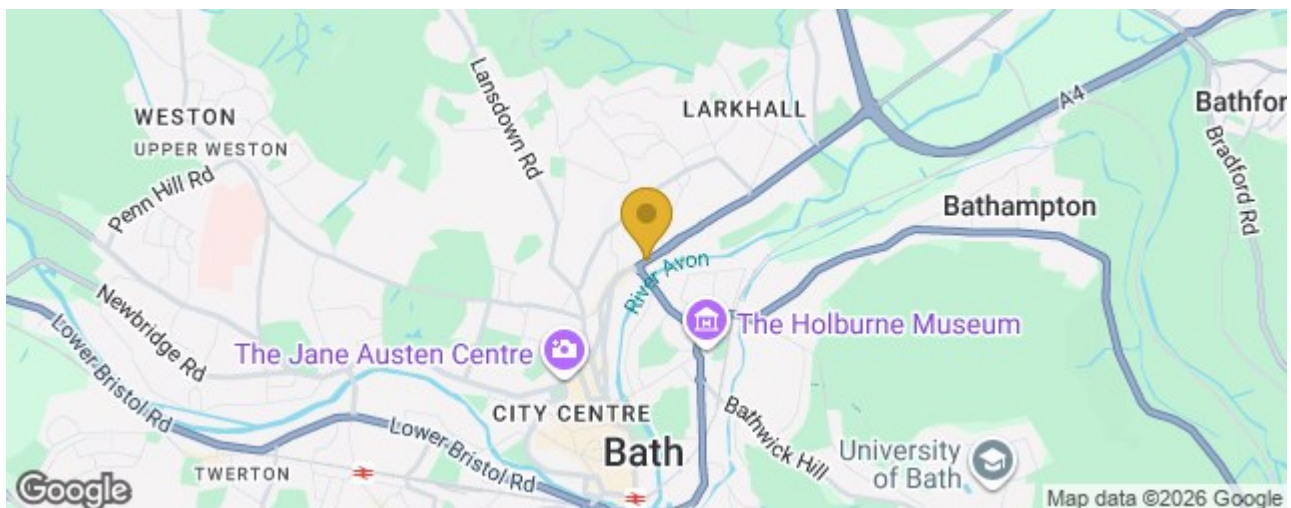



**BASEMENT**  
742 sq.ft. (68.9 sq.m.) approx.

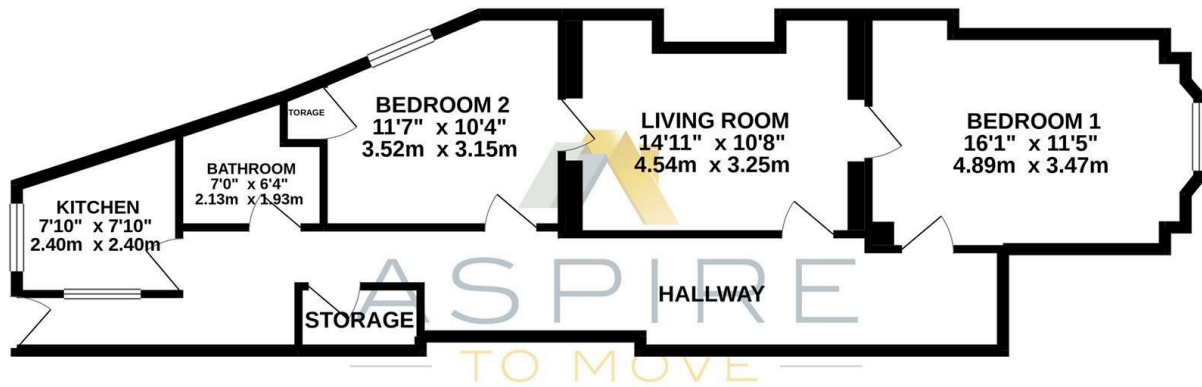

CLEVELAND PLACE EAST, BATH

TOTAL FLOOR AREA : 742 sq.ft. (68.9 sq.m.) approx.

Whilst every attempt has been made to ensure the accuracy of the floorplan contained here, measurements of doors, windows, rooms and any other items are approximate and no responsibility is taken for any error, omission or mis-statement. This plan is for illustrative purposes only and should be used as such by any prospective purchaser. The services, systems and appliances shown have not been tested and no guarantee as to their operability or efficiency can be given.  
Made with Metropix ©2020

These particulars, whilst believed to be accurate are set out as a general outline only for guidance and do not constitute any part of an offer or contract. Intending purchasers should not rely on them as statements of representation of fact, but must satisfy themselves by inspection or otherwise as to their accuracy. No person in this firms employment has the authority to make or give any representation or warranty in respect of the property.

