



# Eyre Court

3-21 Finchley Road, NW8

£2,250 per month  
(£519.23 per week)

A spacious one bedroom apartment set within a sought after portered mansion block, moments from St Johns Wood Underground Station and High Street.



# Eyre Court

3-21 Finchley Road, NW8

- Ground Floor Flat
- 1 Bedroom, 1 Bathroom
- Porter, Close to St John's Wood Station
- Water Rates Included



A spacious one bedroom apartment set within a sought after portered mansion block, moments from St Johns Wood Underground Station and High Street.

The property comprises one double bedroom, large reception room, fitted kitchen and bathroom.

Additional benefits include communal garden and water rates being included in the rent.

**Minimum Term:** 12 months  
**Deposit Required:** £2,596.15  
**Local Authority:** City Of Westminster  
**Council Tax Band:**  
**EPC Rating:** D  
**Furnished**

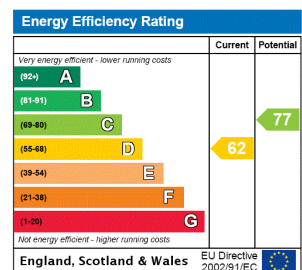

### Chestertons St John's Wood Lettings

105 St. John's Wood Terrace  
 London  
 NW8 6PL  
 stjohslettingsusers@chestertons.co.uk  
 02030408622  
 chestertons.co.uk

Additional tenant charges apply (fees apply to non-AST tenancies only)  
 Tenancy Agreement Fee: £300  
 References per Tenant/Guarantor: £60  
 Inventory check (approx. £100 – £250 inc. VAT)  
 chestertons.co.uk/property-to-rent/applicable-fees

# Finchley Road, NW8 9TT

Approx Gross Internal Area = 61.35 sq m / 660 sq ft

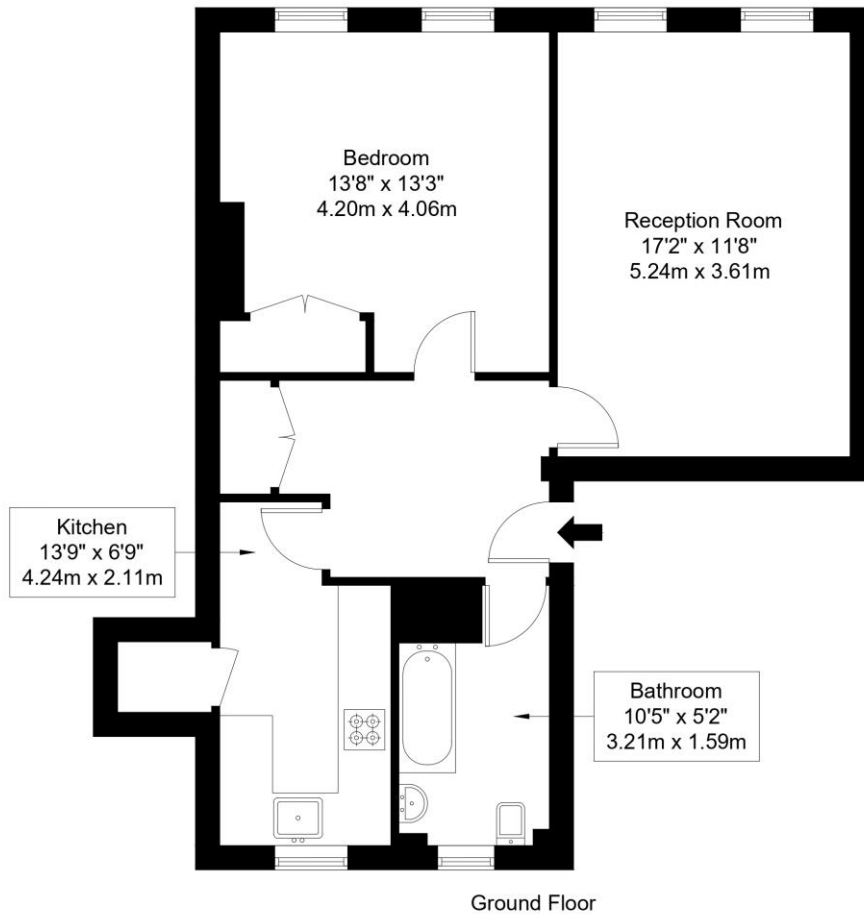
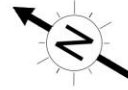

Ref :

Copyright **BLEU  
PLAN**

The Floor plan is not to scale and measurements and areas shown are approximate and therefore should be used for illustrative purposes only. The plan has been prepared in accordance with the RICS code of Measuring Practice and whilst we have confidence in the information produced it must not be relied on. Maximum lengths and widths are represented on the floor plan. If there is any aspect of particular importance, you should carry out or commission your own inspection of the property.

Copyright @ BLEUPLAN

