

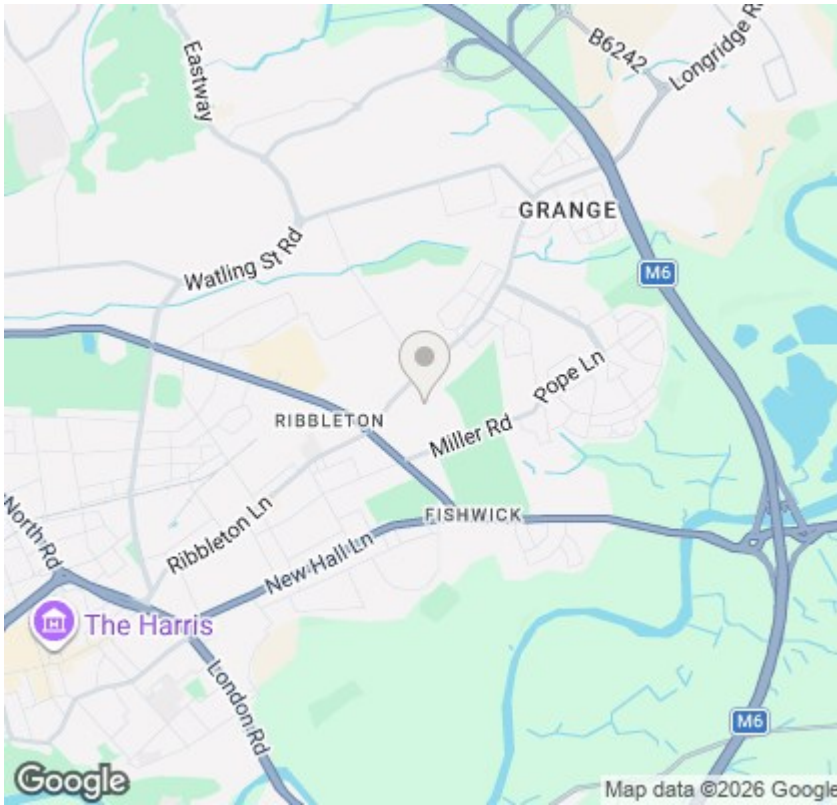

18 The Mall, Ribbleton, Preston, PR2 6DU

Asking Price £205,000

- Driveway/Garage
- Large Garden Space
- Double Glazed/Gas Central Heating
- Ideal For First-Time Buyers
- Open Planned Kitchen/Dining Space
- Outdoor Shed Space
- 1 Mile From Local Retail Park
- Cul-De-Sac



## Viewings

Viewings by arrangement only.  
Call 01772 888887 to make an appointment.

Council Tax Band:

B

Approx Gross Internal Area  
72 sq m / 777 sq ft

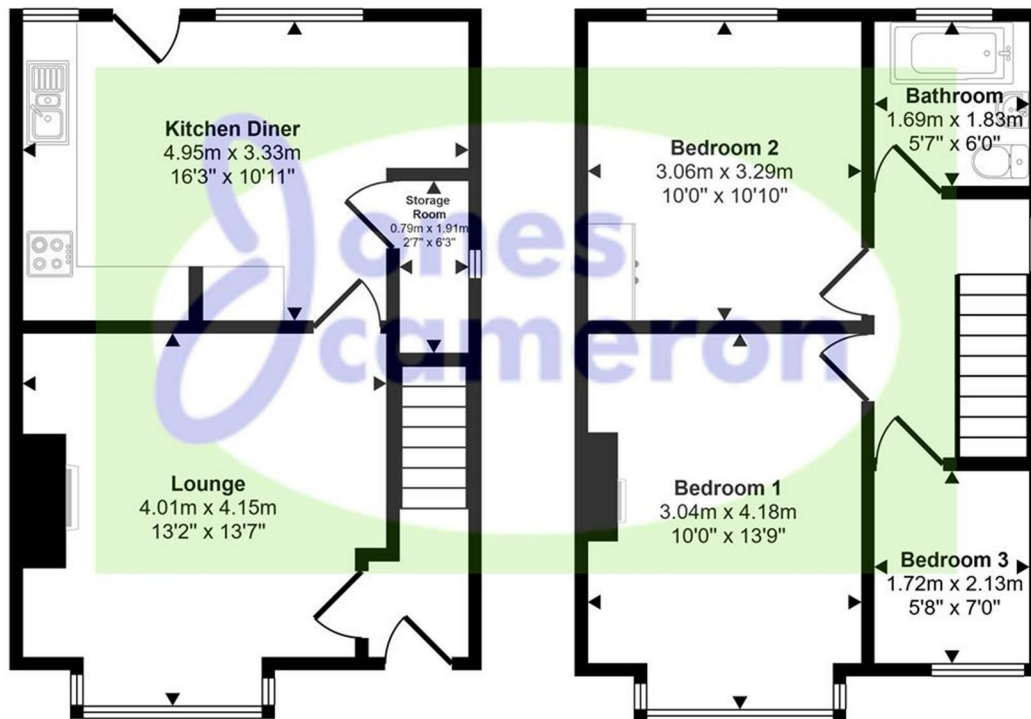

Ground Floor  
Approx 36 sq m / 390 sq ft

First Floor  
Approx 36 sq m / 388 sq ft

This floorplan is only for illustrative purposes and is not to scale. Measurements of rooms, doors, windows, and any items are approximate and no responsibility is taken for any error, omission or mis-statement. Icons of items such as bathroom suites are representations only and may not look like the real items. Made with Made Snappy 360.