

# 1 Yew Tree Close - £1,300 PCM

Mildenhall Bury St. Edmunds IP28 7SJ

shires

Estate & Letting Agents



*"Consistently providing outstanding service to our clients"*

# £1,300 PCM

## The Property

Modern three bedroom semi detached home, walking distance to schools and town centre. The property offers a living room, separate dining room, main bedroom with en-suite, two further bedrooms, garden and garage with off road parking.

## Features

- SEMI DETACHED HOUSE
- CLOSE TO RAF BASES
- 3 BEDROOMS
- GAS HEATING & ENERGY RATING - C
- MODERN KITCHEN
- APPROXIMATE SIZE - 861 SQFT
- BATHROOM, EN SUITE & DOWNSTAIRS WC
- PETS CONSIDERED / COUNCIL TAX - C
- GARAGE, PARKING & ENCLOSED REAR GARDEN
- AVAILABLE EARLY MARCH





These sales particulars have been produced as a general guide only and we would draw to your attention that we have not carried out a detailed Survey of the property nor have we tested services, appliances or specific fittings. Whilst measurements and statements given within the details are provided in good faith, their accuracy should not be relied upon. If there are any points about which you may be uncertain or would like further clarification, we would suggest that you telephone this office and speak to our staff who will endeavour to assist you.

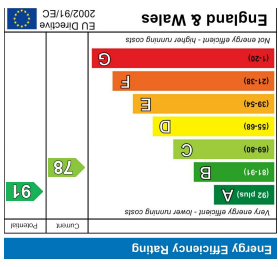

This floorplan is only for illustrative purposes and is not to scale. Measurements of rooms, doors, windows, and any items are approximate and no responsibility is taken for any error, omission or mis-statement. Icons of items such as bathroom suites are representations only and may not look like the real items. Made with Made Snappy 360.

Ground Floor  
Approx 40 sq m / 433 sq ft

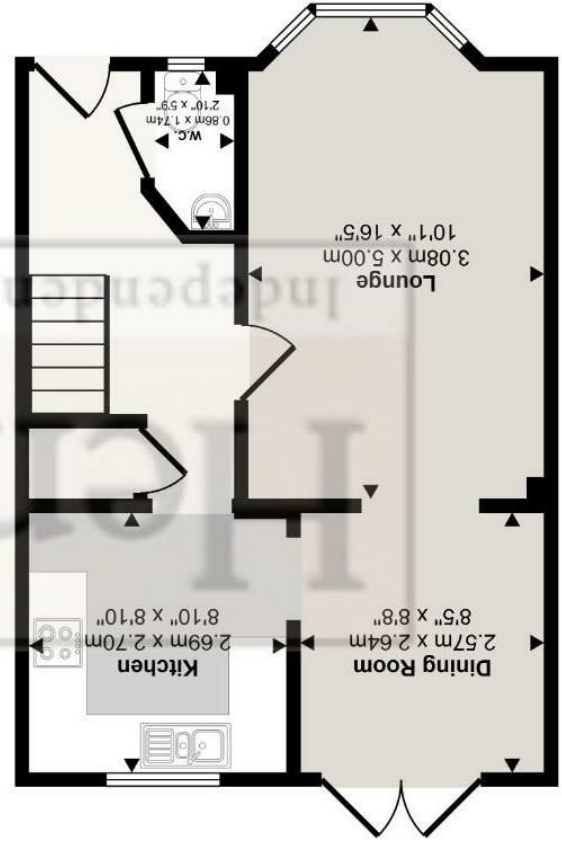

Approx Gross Internal Area  
80 sq m / 864 sq ft

First Floor  
Approx 40 sq m / 431 sq ft

