



Chestnut Crescent, March
£230,000 Freehold

**Sharman
Quinney**

Key Features



- No Onward Chain
- Fantastic Family Home
- Garage and Off-Road Parking
- Walking Distance to Local Amenities
- Private Rear Garden

Ground Floor

Entrance Hall -

Tiled flooring, stairs to first floor. Access into downstairs WC, Lounge/Diner and Kitchen.

Downstairs WC -

Window to side. Tiled flooring. Low rise toilet and wall mounted hand wash basin with tiled splashback.

Lounge/Diner -

Large windows to front and rear. Fitted carpet. Serving hatch into kitchen from dining area.

Kitchen -

Window and door to rear garden. Tiled flooring from hallway continued. A range of base and wall



units in a country shaker style with tiled splashbacks. Stainless steel sink, single oven with electric hob included. Space for washing machine, tumble dryer and fridge/freezer.

First Floor

Bedroom One -
Window to rear. Fitted carpet. Built in cupboard.

Bedroom Two -
Window to front. Fitted carpet. Built in cupboard.

Bedroom Three -
Window to front. Fitted carpet. Built in cupboard.

Bathroom -
Window to rear. Tiled flooring and partly tiled walls. A white three piece suite comprising of panelled bath with overhead shower, pedestal sink with tiled splashback and low rise toilet. Airing cupboard.

Outside -
The front of the property offers ample off-road parking via the paved driveway in front of the single garage. There is also a large gravel area with various shrubs, but if more parking is needed this space could be easily altered. The rear garden is fully enclosed and is half laid to lawn whilst the other half is gravel. There are various trees and shrubs and a patio area perfect for entertaining.



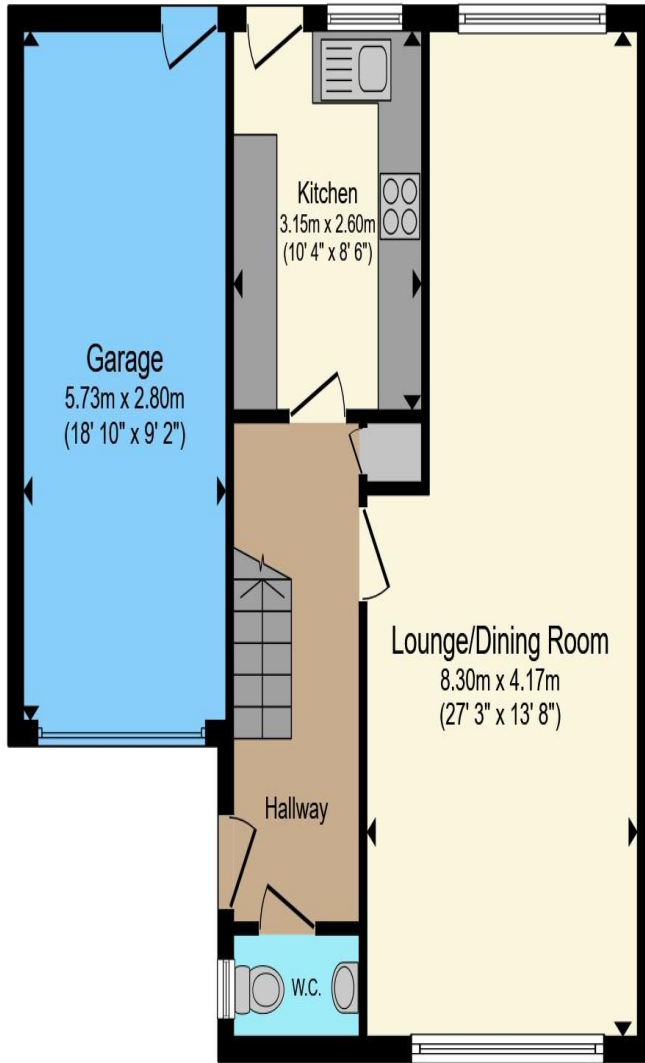

Ground Floor

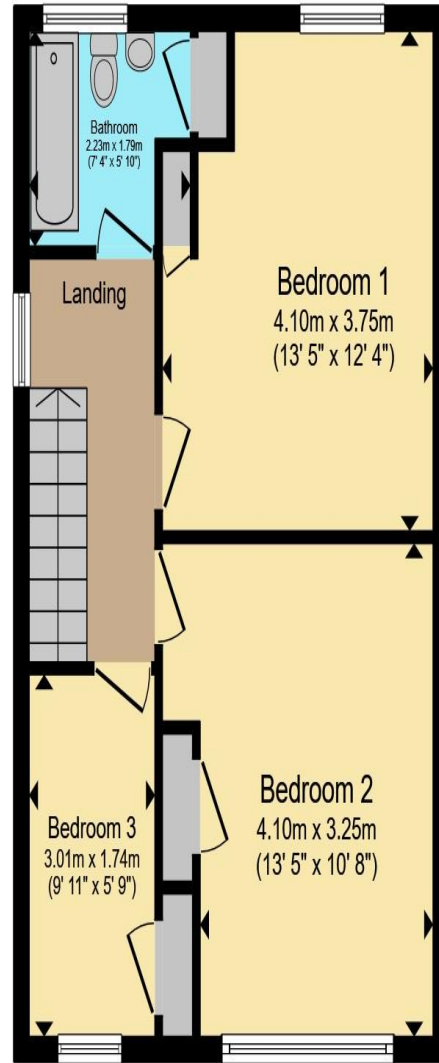

First Floor

Total floor area 109.8 m² (1,182 sq.ft.) approx

This floor plan is for illustrative purposes only. It is not drawn to scale. Any measurements, floor areas (including any total floor area), openings and orientation are approximate. No details are guaranteed, they cannot be relied upon for any purpose and they do not form part of any agreement. No liability is taken for any error, omission or misstatement. A party must rely upon its own inspection(s). Powered by www.propertybox.io

**Sharman
Quinney**

To view this property call Sharman Quinney on:
01354 661166

Selling your property?

Contact us to arrange a **FREE** home valuation.

 01354 661166

 8 Broad Street, MARCH, Cambridgeshire, PE15 8TG

 march@sharmanquinney.co.uk

 www.sharmanquinney.co.uk



 SCAN ME



Sharman Quinney Holdings Limited is registered in England and Wales under company number 4174227, Registered Office is Cumbria House, 16-20 Hockliffe Street, Leighton Buzzard, Bedfordshire, LU7 1GN. VAT Registration Number is 500 2481 05.

1: These particulars do not constitute part or all of an offer or contract. 2: The measurements indicated are supplied for guidance only and as such must be considered incorrect. 3: Potential buyers are advised to recheck the measurements before committing to any expense. 4: Sharman Quinney has not tested any apparatus, equipment, fixtures, fittings or services and it is the buyers interests to check the working condition of any appliances. 5: Sharman Quinney has not sought to verify the legal title of the property and buyers must obtain verification from their legal representative. 6: Intending purchasers will be asked to produce identification documentation at a later stage and we would ask your co-operation in order that there will be no delay in agreeing the sale. Ref: MRC206467 - 0002

