



Fergus Street, Greenwich, London, SE10 0XQ



Fergus Street, Greenwich SE10

Freehold

A stylish modern house in historic Greenwich, featuring private garden and first-floor balcony. Perfect blend of modern living with allocated parking in this UNESCO World Heritage location, moments from Royal Greenwich Park and excellent transport connections.

Key Features

- 3 Bedrooms, 2 Bathrooms
 - Detached
 - Private garden and balcony
 - Council Tax: **E**
 - Allocated parking
 - Fantastic transport links
 - No onward chain
 - EPC: **B**
-

Nestled in the heart of historic Greenwich, this delightful three-bedroom house on Fergus Street offers an exceptional opportunity to own a piece of London's maritime heritage. The property seamlessly combines contemporary living, creating a welcoming family home in one of London's most prestigious and culturally rich neighbourhoods.

The thoughtfully arranged accommodation spans three bedrooms and two bathrooms across well-proportioned floors, with the master bedroom benefiting from its own private first-floor decked balcony - a perfect retreat for morning coffee or evening relaxation. The private enclosed garden at ground level, mainly laid to paving, provides a low-maintenance outdoor sanctuary ideal for entertaining or quiet contemplation.

This freehold property represents a rare opportunity to secure a distinctive family home in one of London's most celebrated riverside communities, where history, culture, and modern connectivity converge to create an exceptional lifestyle proposition.









Fergus Street

Approximate Gross Internal Area = 110.15 sq m / 1185.64 sq ft



 = Reduced headroom below 1.5m / 5'0

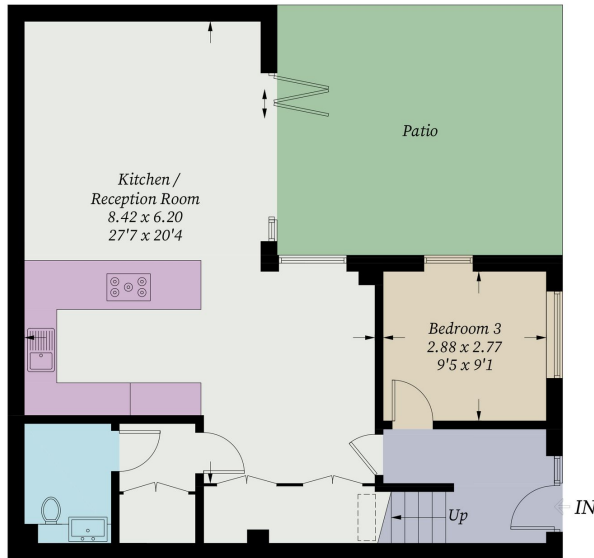

Ground Floor



First Floor

Illustration for identification purposes only, measurements are approximate, not to scale. Fourlabs.co © (ID1249433)

22 College Approach, Greenwich,
London, SE10 9HY
Tel: 020 7399 5595

Sales, Lettings & Property Management

residential.jll.co.uk

